

Saucer

CEC Version

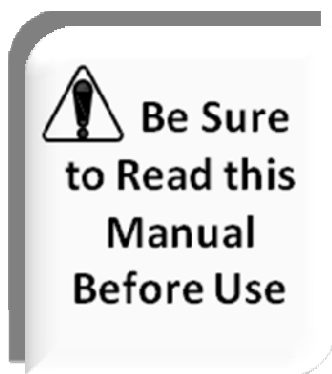

Operation Manual

Distributed by: Amusements Worldwide

www.amusementsworldwide.com

Tel: 214-750-9202

SERIAL NUMBER:

DATE OF INSTALLATION:

CONTENT

Important Safety Instructions 2

1. SPECIFICATIONS 4

2. PACKAGE CONTENTS 5

3. PART NAMES 6

4. SET UP & INSTALLATION 7

5. HOW TO PLAY 10

6. GAME OPTION 10

7. MAINTENANCE, INSPECTION..... 13

8. OVERALL CONSTRUCTION 18



WARNING

Non-technical personnel who do not have technical knowledge and Expertise should refrain from performing such work that this manual require or perform tasks which are not explained in this manual. Failing to comply can cause severe accidents such as electric shock or other serious injuries. All repairs must be performed to original manufacturer specifications.

WARNING: To reduce the risk of fire, electric shock or personal injury, unplug or disconnect the machine from the power supply before servicing.

Thank you for purchasing **SAUCER**. We hope you enjoy the product.

This manual contains valuable information about how to operate and maintain your game machine properly and safely. It is intended for the owner and/or personnel in charge of product operation. Carefully read and understand the instructions.

If you need any help during installation and setup please utilize this manual and troubleshooting guide. If the product fails to function properly, *non-technical personnel should under no circumstance attempt to service the machine*. Contact your distributor or manufacturer for help.

Before use, please read **IMPORTANT SAFETY INSTRUCTIONS**.

IMPORTANT SAFETY INSTRUCTIONS

To ensure the safe usage of this product, carefully read and understand these instructions before operating your game. Save these instructions for future reference.

Use this product only as described in this manual. Other uses not recommended may cause fire, electric shock or personal injury. Unplug the game from the outlet when not in use, when moving from one location to another, and before cleaning/servicing.

Explanations which require special attention are indicated by signs of warning. Depending on the potential hazardous degree, the terms: **NOTE**, **NOTICE**, and **WARNING** are used.

NOTE: A NOTE indicates useful hints or information about product usage.

NOTICE: A NOTICE indicates potential damage to product and how to avoid the problem.

WARNING: A WARNING indicates a potential for product damage or serious personal injury.

It is important to understand the meaning of the following HAZARD SIGNS before continuing:

High Voltage and Shock Hazard:

High voltage can cause electric shock.
Turn off/unplug power before servicing.



High Temperature Hazard:

This part may cause scalding.
Do not touch. Surface may be hot.



No Touching Hazard:

This part may be hot or can cause electric shock.
Do not touch.



Use the following safety guidelines to help ensure your own personal safety and to help protect your equipment and surrounding environment from potential damage.

 **This product is an indoor game machine. Do not install outdoors.**

Avoid installing in the following places to prevent fire, electric shock, injury and/or machine malfunctioning:

- Places subject to rain/moisture, or places subject to high humidity.
- Places subject to direct sunlight, or places subject to extremely hot or cold temperatures to ensure that it is used within the specified operating range.
- Places where inflammable gas may be present or in the vicinity of highly inflammable/volatile chemicals or items that can easily catch fire
- On unstable or sloped surfaces. The machine may topple or cause unforeseen accidents.
- Vicinity of fire exits, fire extinguishers etc that may block/prevent safety measures

IMPORTANT NOTE:

All repairs must be done to original manufacturer specifications. Failure to do so will void all warranties and operator assumes all risks.

Note: The contents of this manual may be updated without notice

1. SPECIFICATIONS

Rated power supply: 110V, 50/60Hz

Min. Power consumption: 50W

Max. Power consumption: 230W

Dimensions: D38.58×W38.58×H48.11 (inches)

Weight: About 275.58 (lbs)

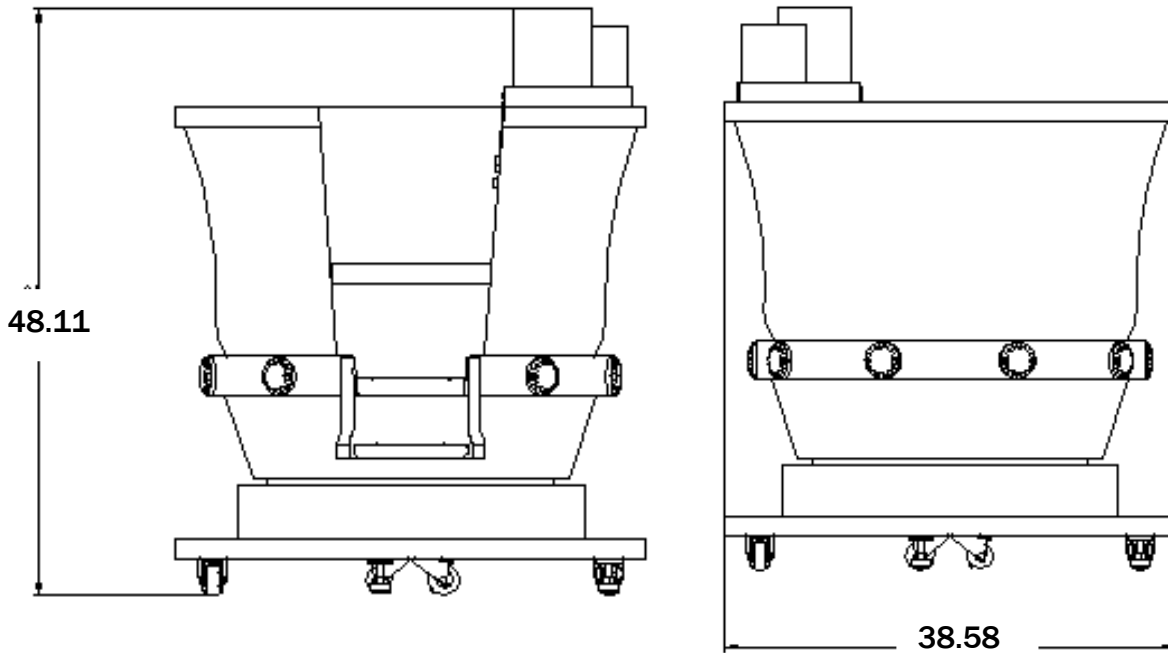

⚠ NOTICE: After turning off the game, please wait at least 1 minute before restarting again.

Note: Game parameters are subject to change without notice.

2. PACKAGE CONTENTS

Open the package and make sure all the items are included:

- 1 x Body Assembly
- Following accessories

No.	Part No.	Name	Spec.	Qty.	Illustration	Note
1	S110-422-000	Fuse	T6A/250VAC Φ6-30mm	1		
2	S110-713-000	Manual	English	1		
3	S110-407-000	LED	E10-DC12V-W-XM-6 white	2		
4	S110-408-000	Key	C582	1		
Total				5		

If any items are found to be missing, please contact your sales representative for help immediately.

Warranty: Universal Space provides 90 days warranty for all electrical and mechanical components, when used under normal operating conditions. Any modification or abuse of these items immediately voids the warranty. Graphic and consumable items are exempt from any warranty.

NOTE: Part models are subject to change without notice.

3. PART NAMES

FRONT VIEW



SIDE VIEW



4. SET UP & INSTALLATION

! This product is an indoor game machine. Do not install outdoors.

- Refer to IMPORTANT SAFETY INSTRUCTIONS (Pg. 3) for places to avoid
- Place the unit on a dry level surface
- Ventilation openings in the back of the unit must not be obstructed by objects or by wall.

4.1 Play Zone

This machine requires space for playing and for maintenance as shown below.

Leave space around the game upon installation:

Service area: 20 inches

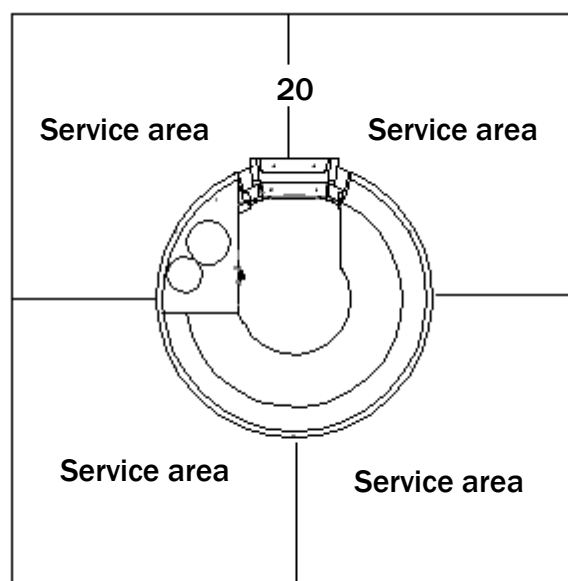

4.2 Level Adjustment

Install this machine on a flat surface. Adjust levers to lift casters off the ground to level the game. If the game is installed on an unsuitable floor, it could cause a malfunction.

To fix the game, adjust the Leveler down until it touches the floor, lifting the casters off the ground by 5mm. Repeat the same for all levelers.

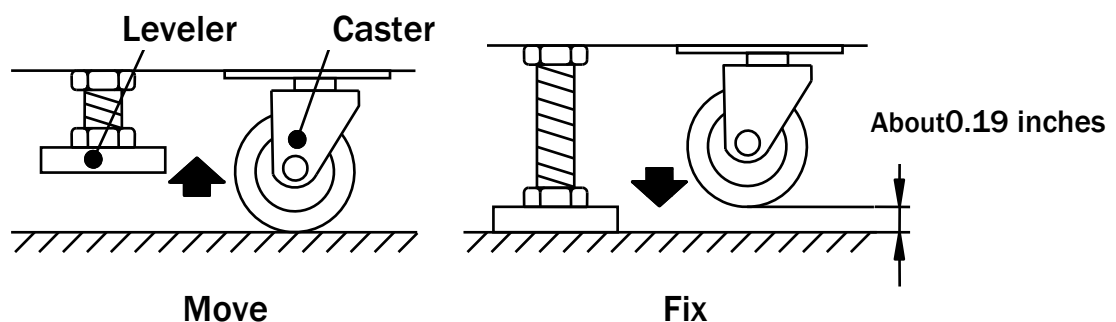

NOTICE

Make sure the machine is level with the ground and all the adjustable legs should stick to the floor closely.

4.3 Transporting the Game

If you need to move the game, adjust the levelers back to an “up” position so the casters touch the ground.

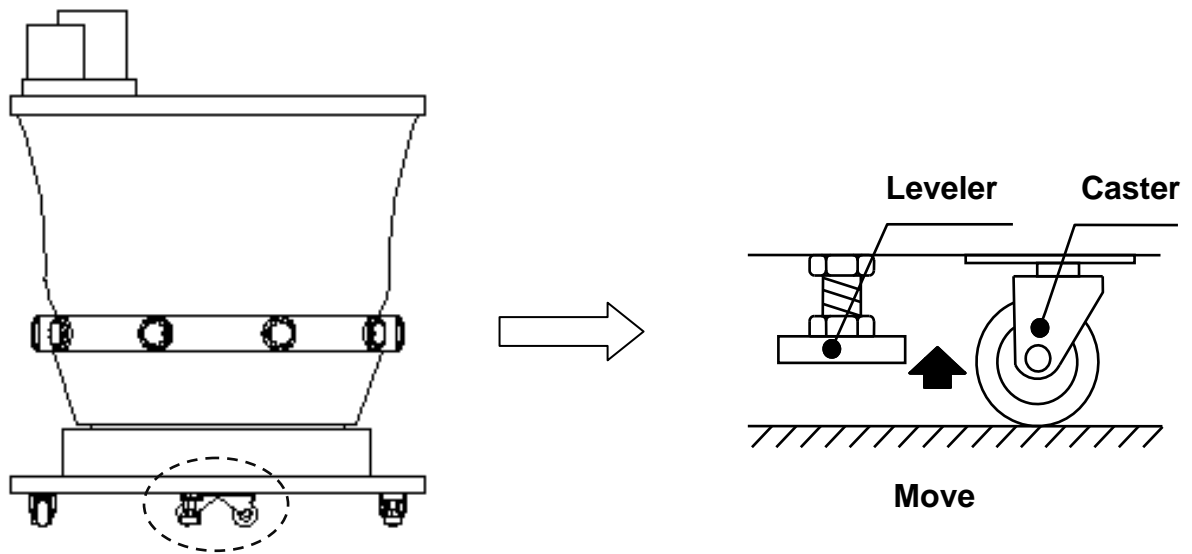

⚠ NOTICE

- Be careful not to damage the machine during transport.
- Do NOT lift the game up by pulling on the cup body. You must lift the **base together with the body.**
- The machine should be handled with care when bringing it down from a higher level.
- Always unplug the game before moving.
- Keep the machine in upright position during transport.
- For longer distance transport, package the game properly to prevent damages.



(NG)

4.4 Connecting Power

! WARNING: Check the voltage rating before you connect the equipment to an electrical outlet to ensure that the required voltage and frequency match the available power source. Please refer the label of the machine.

- Do not plug the equipment power cables into an electrical outlet if the power cable is damaged.
- Avoid putting many loads on one electrical outlet as it could generate heat and fire resulting from overload.
- Connect the grounding conductor to the earth terminal (GND):

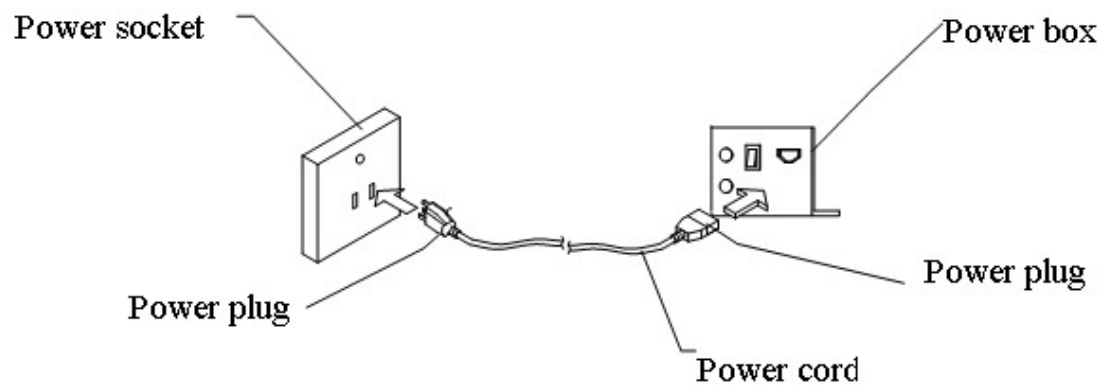

! WARNING

Ensure no heavy objects rest on the power cord. Check to make sure the game cabinet does not sit on the power cord as this could damage the cord and become hazardous.

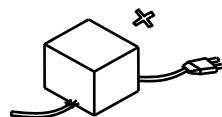

To disconnect the game, grip the plug and pull it from the wall outlet. Never pull by the cord.

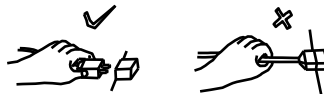

To prevent electric shock, do not touch the power plug when hand is wet.



Ensure that nothing rests on the power cord and that it is not located where it can be stepped on or tripped over.



5. HOW TO PLAY

- Fasten the seat belt. Insert coin(s).
- The ride will start automatically.
- The cup will spin at a moderate speed while music plays.
- It will stop once the game time is up.

6. GAME OPTIONS

6.1 Switches control signal

Refer the attached I/O chart and the schematic.

To adjust DIP, please refer the I/O chart. The initial setting is in CAPITAL LETTERS.

Main board :

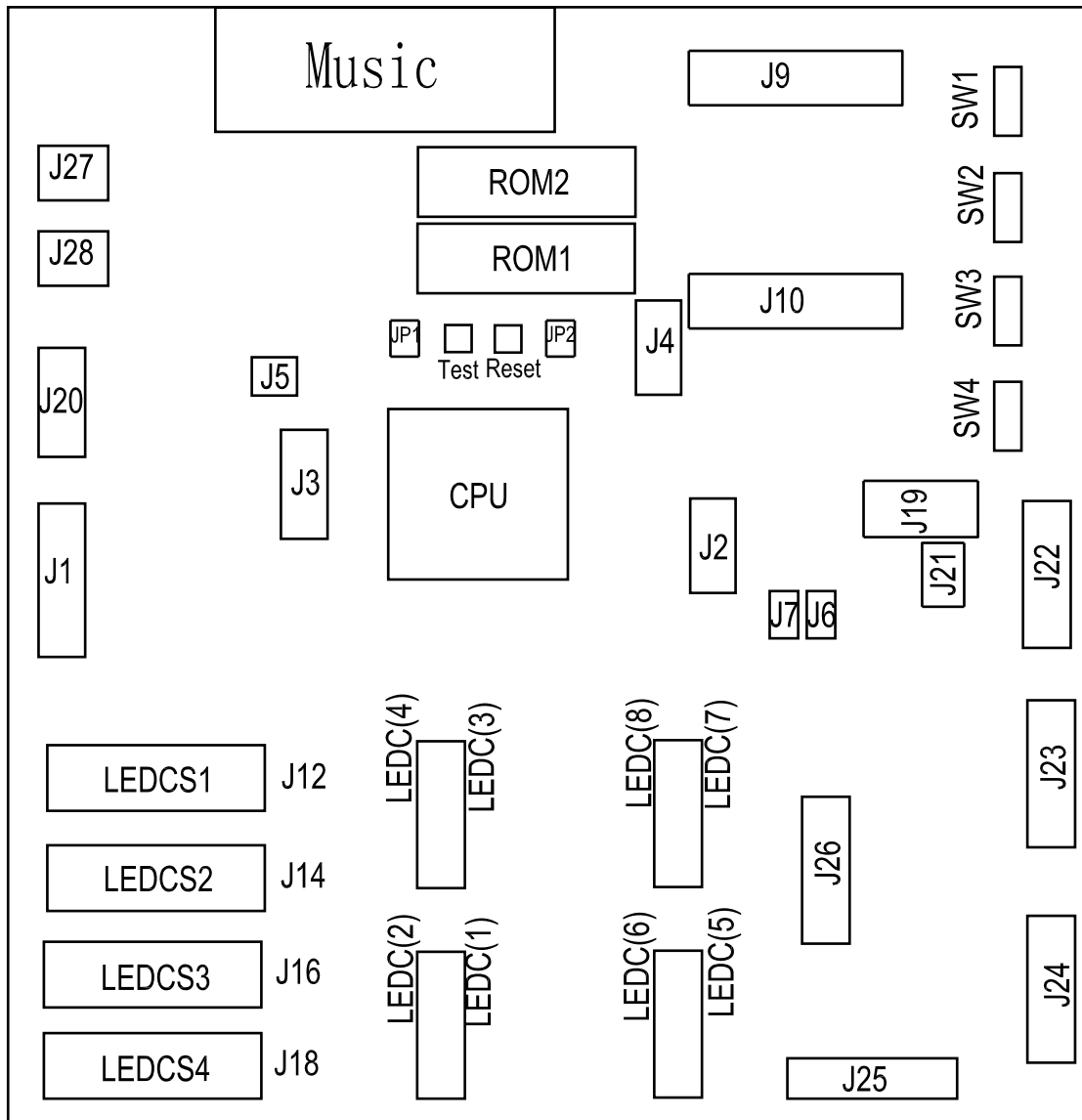

6.2 DIP adjust (Default Setting)

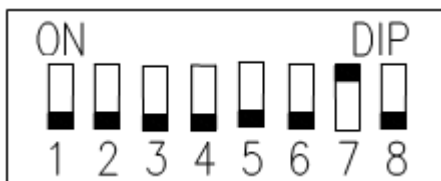

Notice

The above are subject to change without notice.

6.3 Parameter setting:

Default settings are in capital letters

DIP Adjust 1 (SW1)

(1) Credit

Item	Content	DIP Adjust (SW1)		Note
		1	2	
Credit (Coin/round)	4	on	on	
	3	off	on	
	2	on	off	
	1	OFF	OFF	

(2) Play time (SW1)

Item	Content	DIP Adjust (SW1)			Note
		3	4	5	
Play time (s)	200	on	on	on	
	189	off	on	on	
	169	on	off	on	
	120	off	off	on	
	100	on	on	off	
	80	off	on	off	
	60	on	off	off	
	45	OFF	OFF	OFF	

(3) Demo music (SW1)

Item	Content	DIP Adjust (SW1)	Note
		6	
Demo music	YES	on	
	NO	OFF	

(4) Rotation direction (SW1)

Item	Content	DIP Adjust (SW1)	Note
		7	
Rotation Direction	REV	ON	Rotate in counterclockwise way.
	REV & FWD alternate	off	Rotate in counterclockwise and clockwise way alternately

(5) Game mode (SW1)

Item	Content	DIP Adjust (SW1)	Note
		8	
Game Mode	Test	on	game is in the test mode when power is up
	Operation	OFF	

7. MAINTENANCE, INSPECTION

7.1 Safety Check

Check the points listed before operating the machine. These checks are necessary for safe machine operation:

1. Try to run the game before operation each day.
2. Conduct monthly routine checks of game components ensure good working condition
3. Check the machine regularly for dust and clean when necessary.

Note: Parts and components require preventative maintenance to be kept running smoothly

7.2 Handling Precautions

When installing or inspecting the machine, be very careful of the following points and pay attention to ensure that the player can enjoy the game safely.

Non-compliance with the following points or inappropriate handling running counter to the cautionary matters herein stated can cause personal injury or damage to the machine



WARNING

- Before servicing the machine, be sure to turn power off. Servicing without turning the power off can cause electric shock or short circuit.
- To avoid electric shock or short circuit, do not plug then unplug the power quickly
- Do not expose power cords and earth wires, these are susceptible to damage.
- Damaged cords and wires can cause electric shock or short circuit and should be replaced immediately.
- When or after installing the product, avoid pulling the power cord to prevent unnecessary wear and tear. Use the power button to disconnect power.
- In case the power cord is damaged, ask for replacement through where the product was purchased from or replace locally. Continued usage of damaged cord can cause fire, electric shock or leakage.
- Perform grounding appropriately. Inappropriate grounding can cause electric shock.
- Use fuses that meet specified rating. Fuses exceeding can cause an electric shock.
- Should a problem occur, turn off the power immediately and stop operating the machine. Unplug the power cord of the service outlet. Operating the machine without correcting the problem may cause a fire or injuries.
- Insert the power plug securely into the outlet. Poor contact may cause overheating, resulting in fire or burns.
- To ensure the warning labels attached on the machine are visible and legible, install the machine in a well-lit location, and keep the labels clean at all times. Make sure the labels are not hidden behind other game machines.

7.3 Access to the Base

Step 1 Remove the panel under the coin box. Unplug the connector inside.

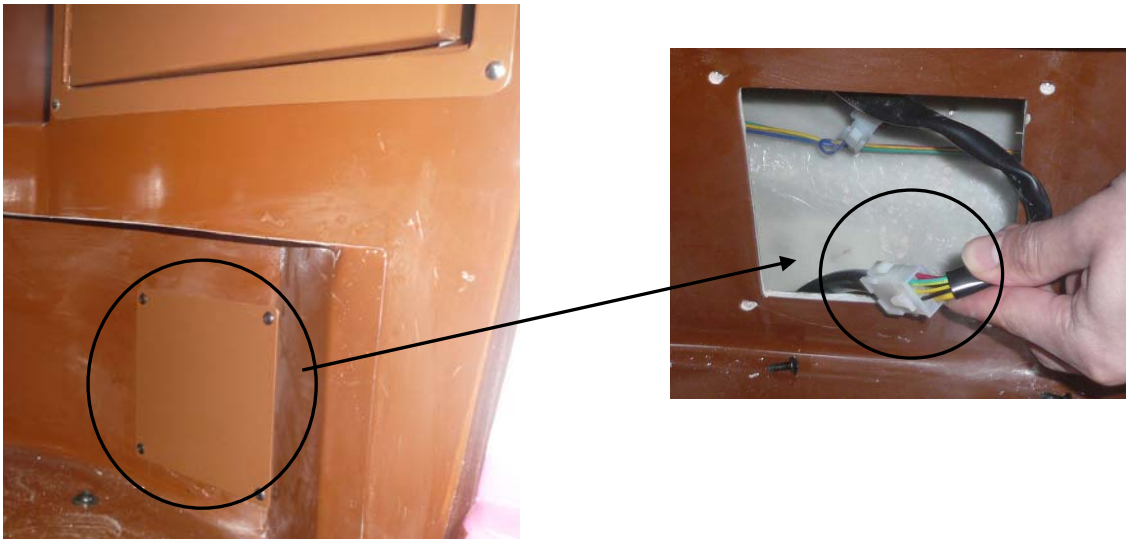

Step 2 Remove the 4 screws on the rubber pad as indicated in the picture below:



Step 3 Carefully lift the cup body up and out of the base.



Step 4 Remove the 6 screws in the center of the black plate as shown:



Step 5 Unplug the connector and release the tie underneath the black plate.

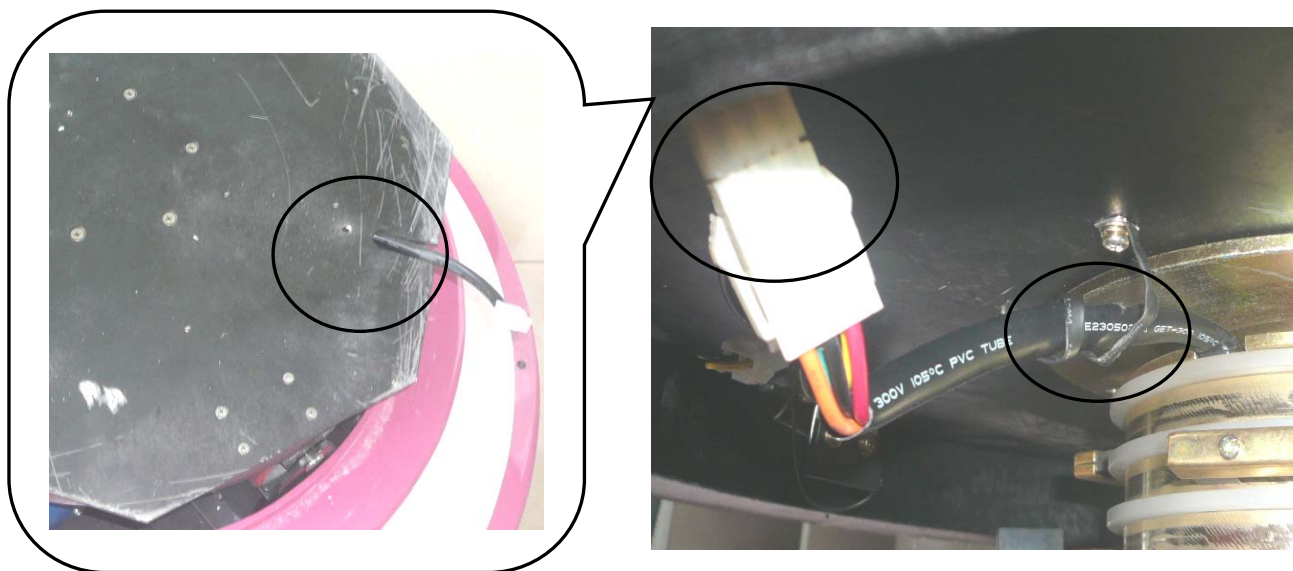

Step 6 Remove the black plate and see the parts inside the base.



7.4 Transducer Setting

7.4.1 Panel Description

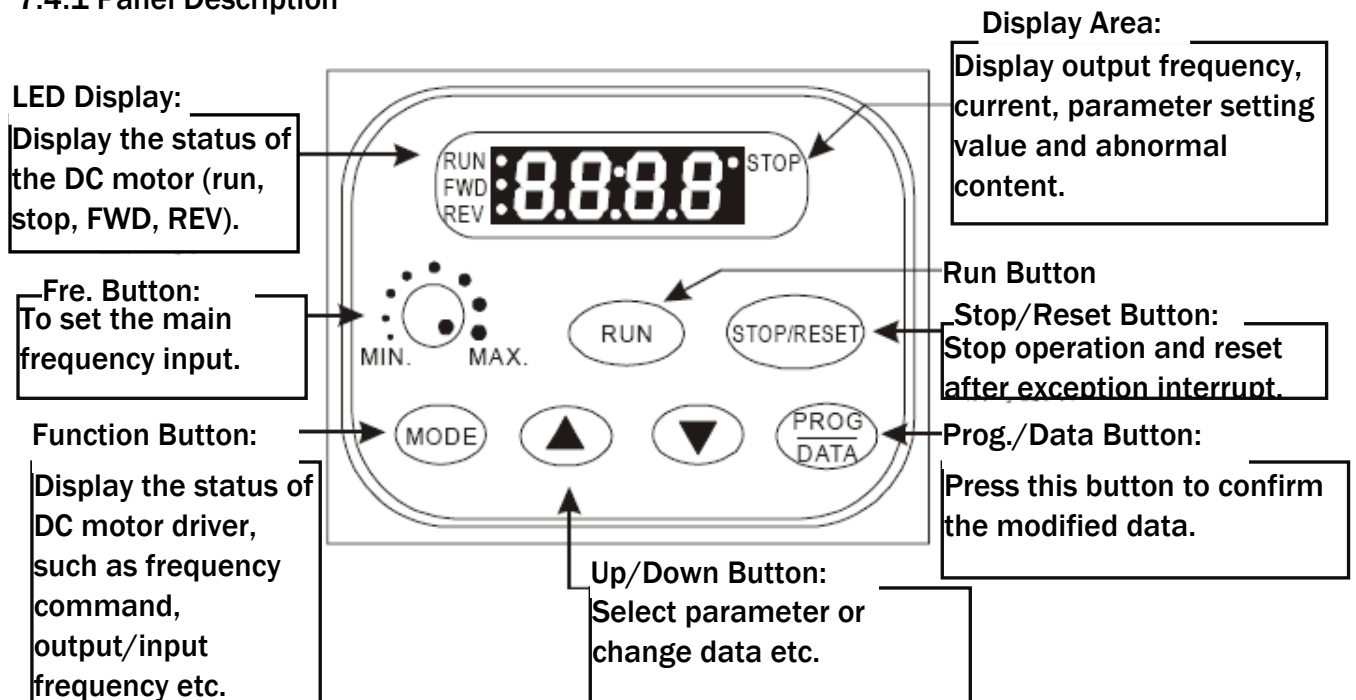

7.4.2 Function Description

Item	Description	Item	Description
Frd	Rotation direction of the DC motor driver is forward.	Err	Value not accepted or value out of range.
rEu	Rotation direction of the DC motor driver is reversed.	F60.0	Display the current setting frequency.
C999	Display count	H60.0	Display the actual output frequency to the motor.
0-	Display option group name	u600.	Display the physical value customer defined.(U=Fx00-05).
0-00	Display the sub item of option group.	A 5.0	Display transducer output side U, V and W current
d 0	Display parameter value.	1=5.0	Display transducer to auto execute program currently.
End	Display about 1s means data has been accepted and saved.	U310	Display DC-BUS voltage.
E220	Display output voltage.		

7.4.2 Operation Steps

Item selection



Note: In this mode, press to enter the parameter setting.

Parameter Setting

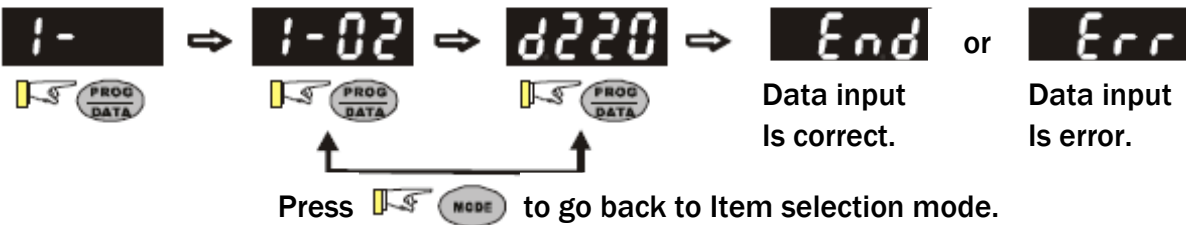

Data modification



Direction Setting



8. OVERALL CONSTRUCTION

8.1 Main Assembly

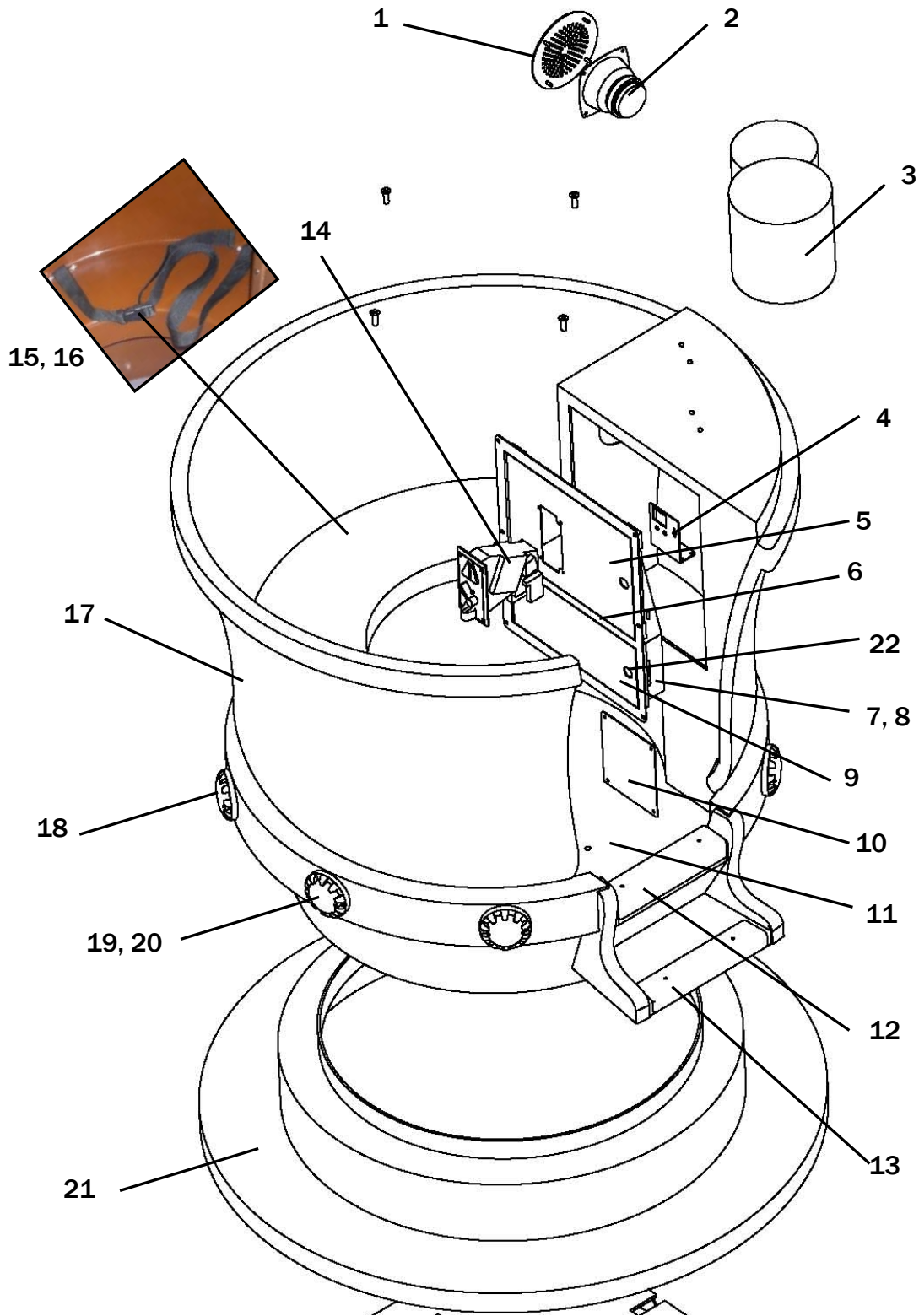

No.	Part No.	Name	Qty.
1	S110-101-000	Speaker grill	1
2	S110-401-000	Speaker	1
3	S110-601-000	Marsh mellow	1
4	S110-102-000	Counter panel	1
5	S110-103-000	Coin door	1
6	S110-104-000	Coin door frame	1
7	S110-105-000	Coin box - outer	1
8	S110-106-000	Coin box	1
9	S110-107-000	Coin box door	1
10	S110-108-000	Connector panel	1
11	S110-402-000	Grey rubber pad	1
12	S110-109-000	Skid-proof plate2	1
13	S110-110-000	Skid-proof plate1	1
14	S110-403-000	CEC Coin mech.	1
15	S110-111-000	Seat belt buckle	4
16	S110-404-000	Seat belt	2
17	S110-602-000	Cup	1
18	S110-405-000	65 lamp	4
19	S110-406-000	65 lamp	4
20	S110-407-000	LED	8
21	S110-603-000	Base	1
22	S110-408-000	CEC lock	2

8.2 Internal Assembly

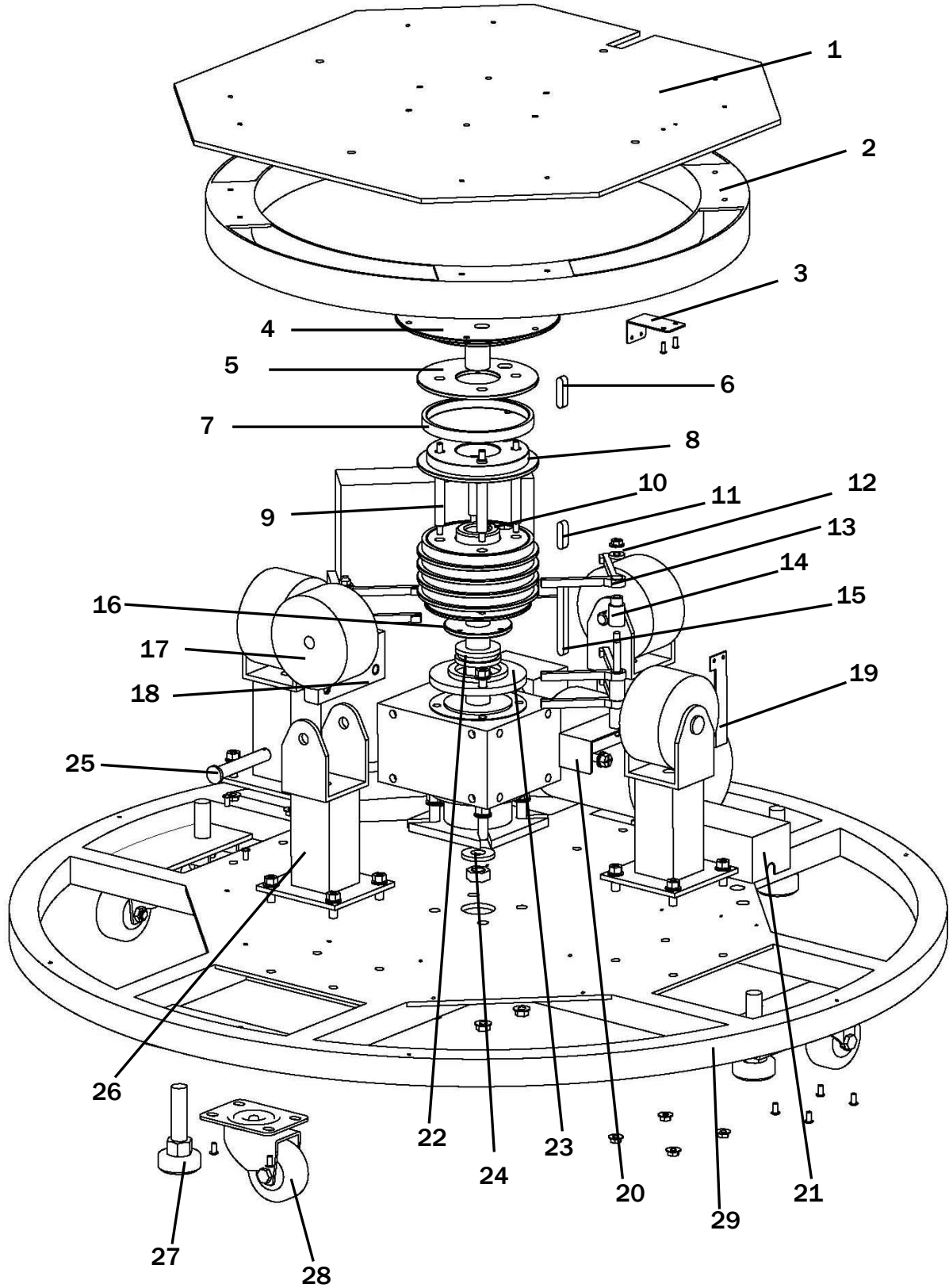

No.	Part No.	Name	Qty.
1	S110-112-000	Support plate	1
2	S110-113-000	Support guide rail	1
3	S110-114-000	Reset piece	1
4	S110-115-000	Connected plate	1
5	S110-604-000	Stopper	1
6	S110-116-000	A type flat key	1
7	S110-117-000	Conducting ring	5
8	S110-605-000	Conducting ring seat	5
9	S110-118-000	Limited bar	4
10	S110-119-000	Driving sleeve	1
11	S110-120-000	A type flat key	1
12	S110-606-000	Insulation spacer	2
13	S110-121-000	V carbon brush holder	5
14	S110-122-000	Carbon brush holder sleeve	5
15	S110-123-000	A type flat key	1
16	S110-124-000	Shaft	1
17	S110-409-000	Wheel	4
18	S110-125-000	Carbon brush holder seat 2	1
19	S110-126-000	Reset piece 1	1
20	S110-127-000	Carbon brush holder seat 1	1
21	S110-607-000	Cover	1
22	S110-410-000	Thrust ball bearing	1
23	S110-128-000	Bearing seat	1
24	S110-129-000	Lock washer	1
25	S110-130-000	Wheel shaft	4
26	S110-131-000	Wheel bracket	4
27	S110-132-000	Leveler	4
28	S110-411-000	2.5" caster	4

8.3 Counter & Electrical Parts

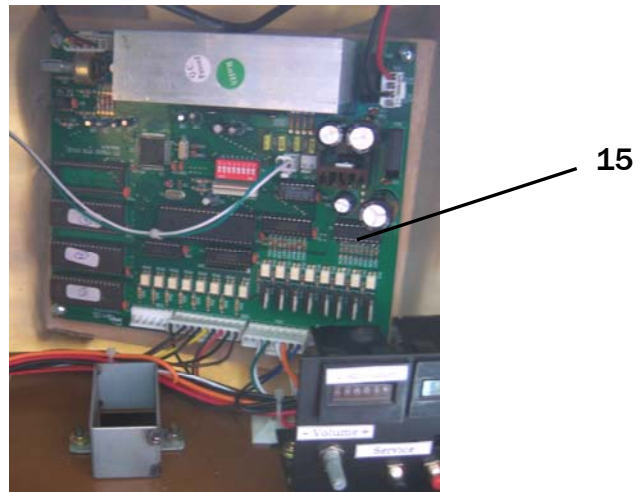
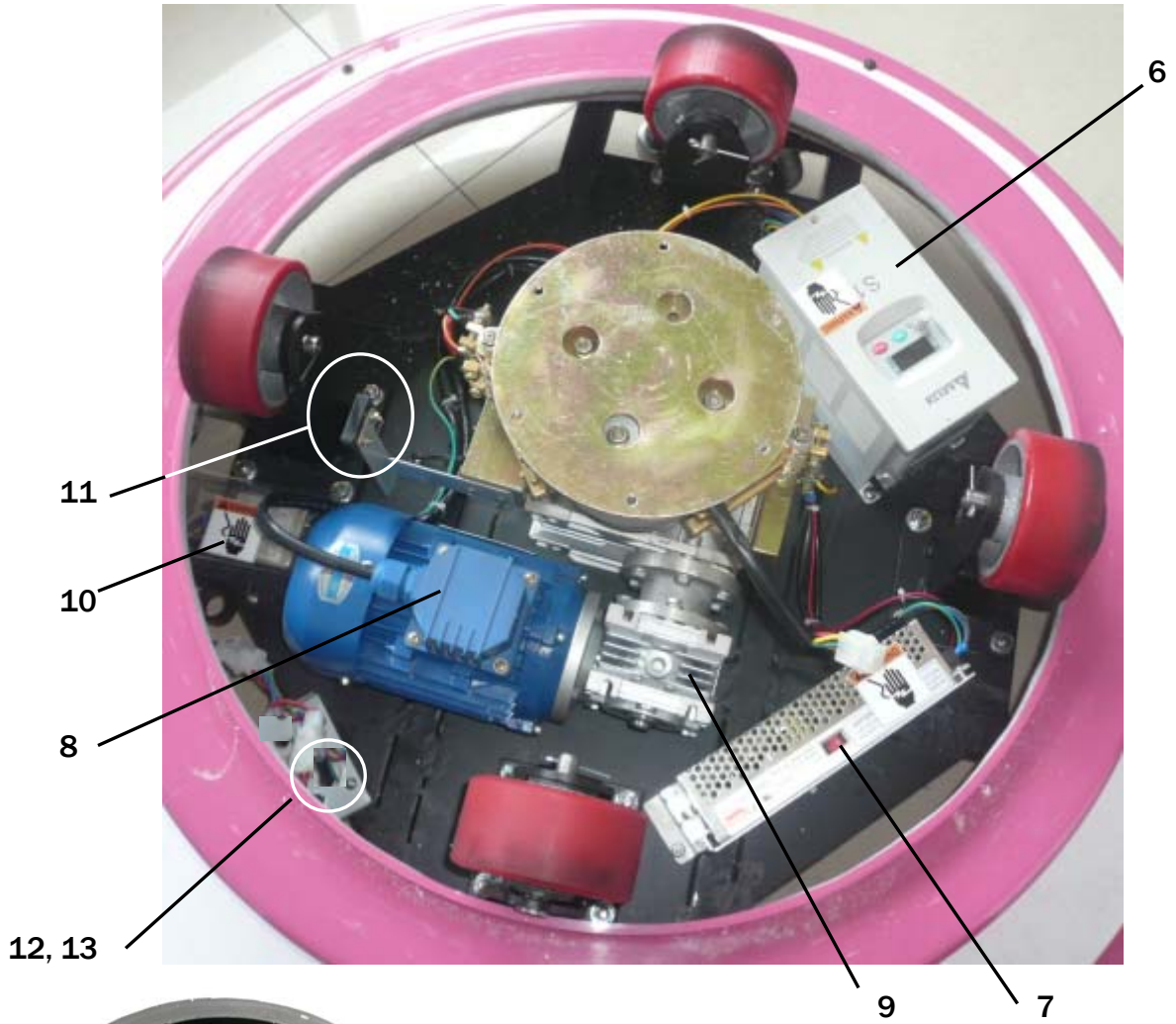

No.	Part No.	Name	Qty.
1	S110-412-000	Counter	1
2	S110-413-000	Button (green)	1
3	S110-414-000	Knob	1
4	S110-415-000	POT	1
5	S110-801-000	POT board	1
6	S110-416-000	Transducer	1
7	S110-417-000	Power supper	1
8	S110-418-000	AC motor	1
9	S110-419-000	Reducer	1
10	S110-420-000	Filter	1
11	S110-421-000	Magnet control switch	1
12	S110-422-000	Fuse	1
13	S110-423-000	Fuse socket	1
14	S110-424-000	Magnet control switch	1
15	S110-802-000	Main board	1

8.4 Game Decals

S110-714-000

13

S110-709-000

9

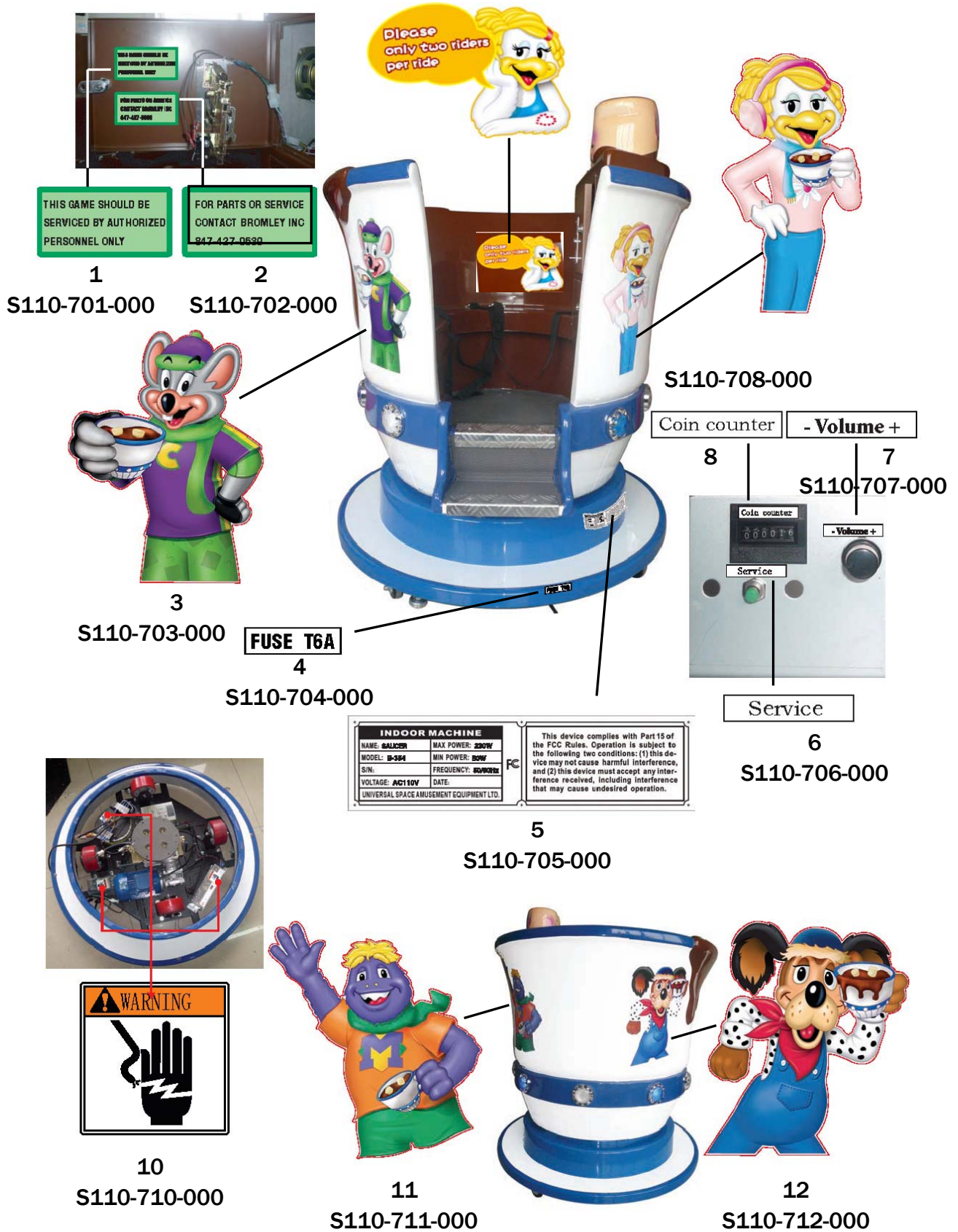

No.	Part No.	Name	Qty.
1	S110-701-000	Service label 1	1

2	S110-702-000	Service label 2	1
3	S110-703-000	Character decal 1	1
4	S110-704-000	Fuse T6A label	1
5	S110-705-000	FCC certified nameplate	1
6	S110-706-000	Service button label	1
7	S110-707-000	Volume label	1
8	S110-708-000	Coin counter label	1
9	S110-709-000	Character decal 4	1
10	S110-710-000	Warning label - s	1
11	S110-711-000	Character decal 3	1
12	S110-712-000	Character decal 2	1
13	S110-714-000	Character decal - inside	1