

BUNNY POND



Be Sure
to Read this
Manual
Before Use



Operation Manual

UNIS[®]
UNIVERSAL SPACE

www.universal-space.com

CONTENT

IMPORTANT SAFETY INSTRUCTIONS	2
1. SPECIFICATIONS.....	4
2. PACKAGE CONTENTS	5
3. PART NAME	6
4. SET UP & INSTALLATION	7
5. HOW TO PLAY	10
6. PARAMETER SETTINGS	11
7. MAINTENANCE & INSPECTION	14
8. OVERALL CONSTRUCTION.....	17
9. DECAL	29

Non-technical personnel who do not have technical knowledge and Expertise should refrain from performing such work that this manual require or perform tasks which are not explained in this manual. Failing to comply can cause severe accidents such as electric shock or other serious injuries. All repairs must be performed to original manufacturer specifications.

WARNING: To reduce the risk of fire, electric shock or personal injury, unplug or disconnect the machine from the power supply before servicing.

Thank you for purchasing **Bonny Pond**. We hope you enjoy the product.

This manual contains valuable information about how to operate and maintain your game machine properly and safely. It is intended for the owner and/or personnel in charge of product operation. Carefully read and understand the instructions.

If you need any help during installation and setup please utilize this manual and troubleshooting guide. If the product fails to function properly, *non-technical personnel should under no circumstance attempt to service the machine*. Contact your distributor or manufacturer for help.

Before use, please read **IMPORTANT SAFETY INSTRUCTIONS**.

IMPORTANT SAFETY INSTRUCTIONS

To ensure the safe usage of this product, carefully read and understand these instructions before operating your game.

Save these instructions for future reference.

Use this product only as described in this manual. Other uses not recommended may cause fire, electric shock or personal injury. Unplug the game from the outlet when not in use, when moving from one location to another, and before cleaning/servicing.

Explanations which require special attention are indicated by signs of warning. Depending on the potential hazardous degree, the terms: **NOTE**, **NOTICE**, and **WARNING** are used.

NOTE: A NOTE indicates useful hints or information about product usage.

NOTICE: A NOTICE indicates potential damage to product and how to avoid the problem.

WARNING: A WARNING indicates a potential for product damage or serious personal injury.

It is important to understand the meaning of the following HAZARD SIGNS before continuing:

High Voltage and Shock Hazard:

High voltage can cause electric shock.
Turn off/unplug power before servicing.



High Temperature Hazard:

This part may cause scalding.
Do not touch. Surface may be hot.



No Touching Hazard:

This part may be hot or can cause electric shock.
Do not touch.



Use the following safety guidelines to help ensure your own personal safety and to help protect your equipment and surrounding environment from potential damage.



This product is an indoor game machine. Do not install outdoors.

Avoid installing in the following places to prevent fire, electric shock, injury and/or machine malfunctioning:

- Places subject to rain/moisture, or places subject to high humidity.
- Places subject to direct sunlight, or places subject to extremely hot or cold temperatures to ensure that it is used within the specified operating range.
- Places where inflammable gas may be present or in the vicinity of highly inflammable/volatile chemicals or items that can easily catch fire
- On unstable or sloped surfaces. The machine may topple or cause unforeseen accidents.
- Vicinity of fire exits, fire extinguishers etc that may block/prevent safety measures

IMPORTANT NOTE:

**ALL REPAIRS MUST BE DONE TO ORIGINAL MANUFACTURER SPECIFICATIONS.
FAILURE TO DO SO VOID ALL WARRANTIES AND OPERATOR ASSUMES ALL
RISKS.**

Note: The contents of this manual may be updated without notice.

1. SPECIFICATIONS

Rated power supply: AC110V 50/60Hz

Min. Power consumption: 45W

Max. Power consumption: 460W

Dimensions: W650×D1100×H1451 (mm)

Weight: Approximately 150kg

! **NOTICE:** After turning off the game, please wait at least 1 minute before restarting again.

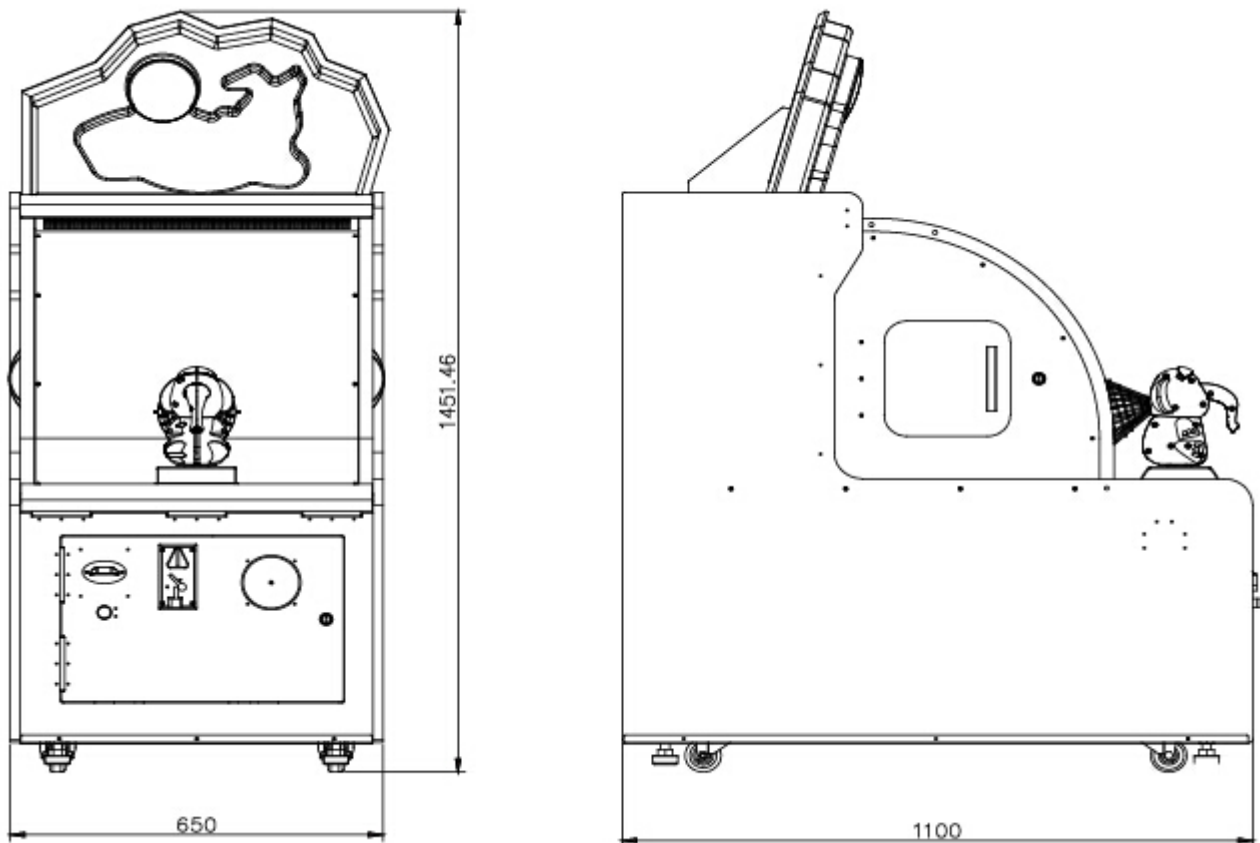





Note: Game parameters are subject to change without notice.

! **NOTICE:** After turning off the game, please wait at least 1 minute before restarting again.

2. PACKAGE CONTENTS

Open the package and make sure all the items are included:

1. 1 x Body Assembly
2. Following accessories

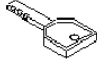
No.	Part No.	Code	Name	Spec.	Qty	Picture
1	B119-471-000	23301018008	Power cord	13*18AWG 1.8M	1	
1	B119-470-000	21901000010	Fuse	Φ5×30mm T3A 250VAC	1	
3	B119-472-000	41440000027	Manual	ENGLISH	1	
4	B119-473-000	25300171002	Key	171	2	
5	B119-474-000	25300172001		171B	2	
6	B119-474-000	20104020026	Cross recessed hexagon bolt	M8×25	4	
7	B119-475-000	20104020014	Cross recessed hexagon bolts with indentation	M8×40	4	
8	B119-476-000	20101180101	Hexagon head seal kit screws	M10×8.5	1	

NOTE: Part models are subject to change without notice.

3. PART NAME

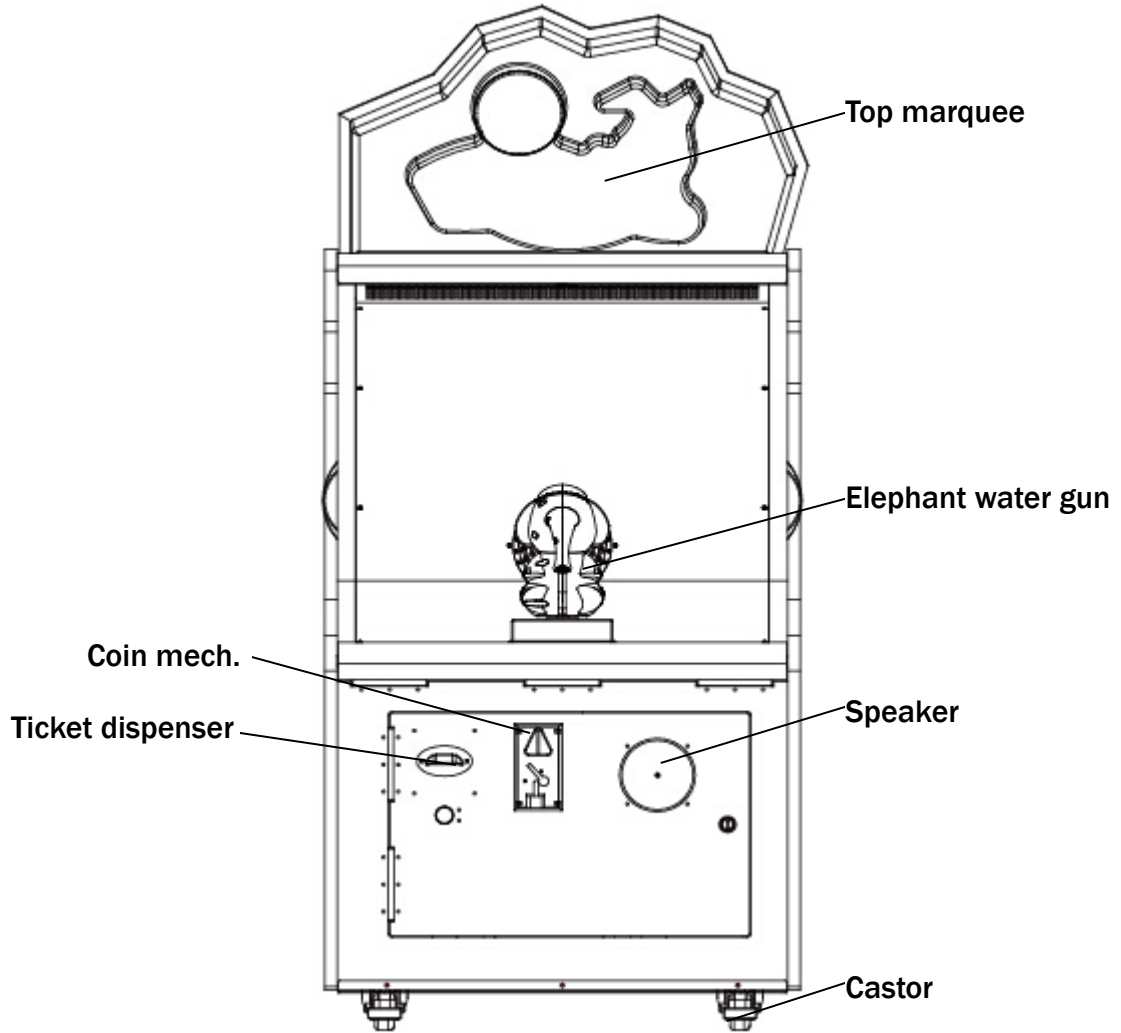

4. SET UP & INSTALLATION

! This product is an indoor game machine. Do not install outdoors.

- Refer to IMPORTANT SAFETY INSTRUCTIONS (Pg. 2) for places to avoid
- Place the unit on a dry level surface
- Ventilation openings in the back of the unit must not be obstructed by objects or by wall.

4.1 Play Zone

This machine requires space for playing and for maintenance as shown below.

Leave space around the game upon installation:

Service area: 500mm

Play area: 500mm

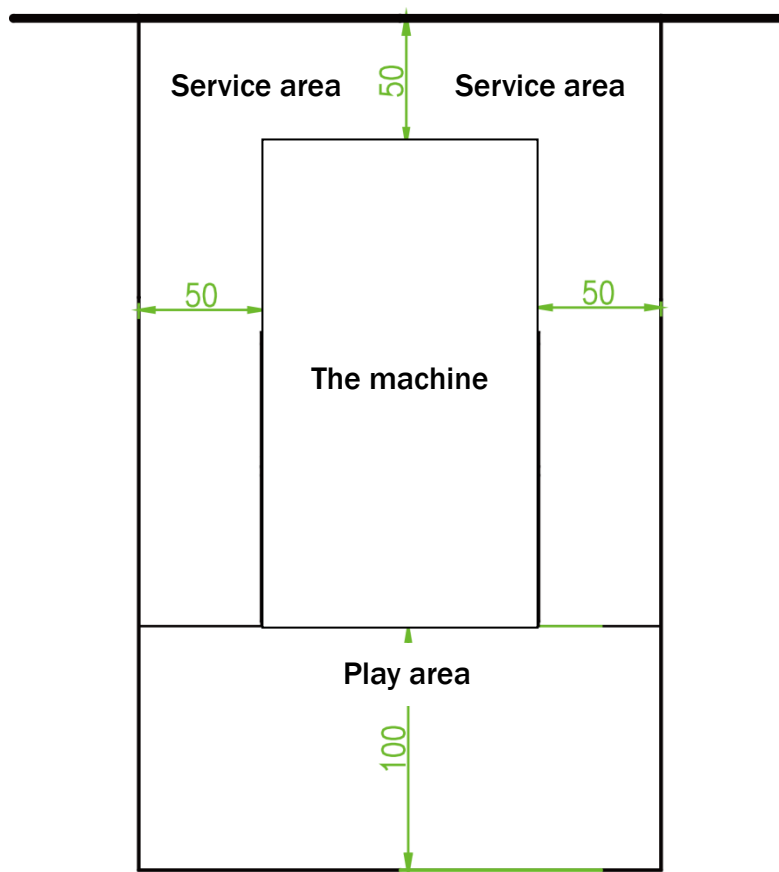

4.2 Level Adjustment

Install this machine on a flat surface. Adjust levers to lift casters off the ground to level the game. If the game is installed on an unsuitable floor, it could cause game malfunction.

To secure the game, adjust the Leveler down until it touches the floor, lifting the casters off the ground by 5mm. Repeat the same for all levelers.

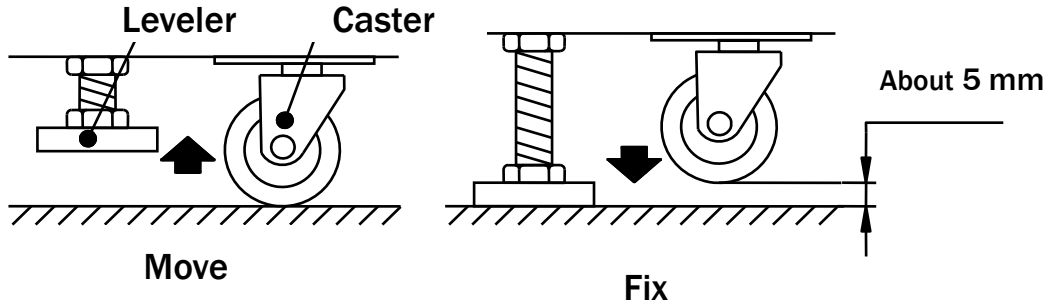

NOTICE

Make sure the machine is level with the ground and all the adjustable legs should stick to the floor closely.

4.3 Transporting the Game

If you need to move the game, adjust the levelers back to an “up” position so the casters touch the ground.

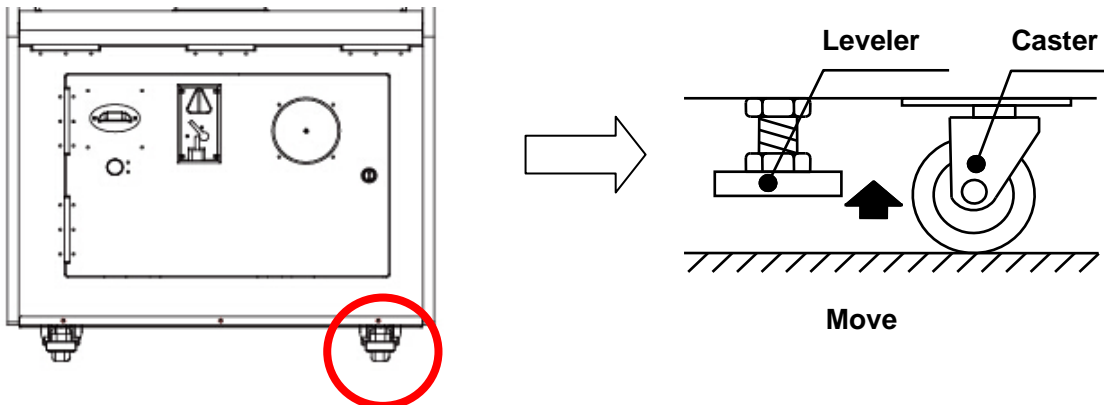

NOTICE

- Be careful not to damage the machine during transport.
- The machine should be handled with care when bringing it down from a higher level.
- Always unplug the game before moving.
- Keep the machine in upright position during transport.
- For longer distance transport, package the game properly to prevent damages.

4.4 Connecting Power

! WARNING: Check the voltage rating before you connect the equipment to an electrical outlet to ensure that the required voltage and frequency match the available power source. Please refer the label of the machine.

- Do not plug the equipment power cables into an electrical outlet if the power cable is damaged.
- Avoid putting many loads on one electrical outlet as it could generate heat and fire resulting from overload.
- Connect the grounding conductor to the earth terminal (GND):

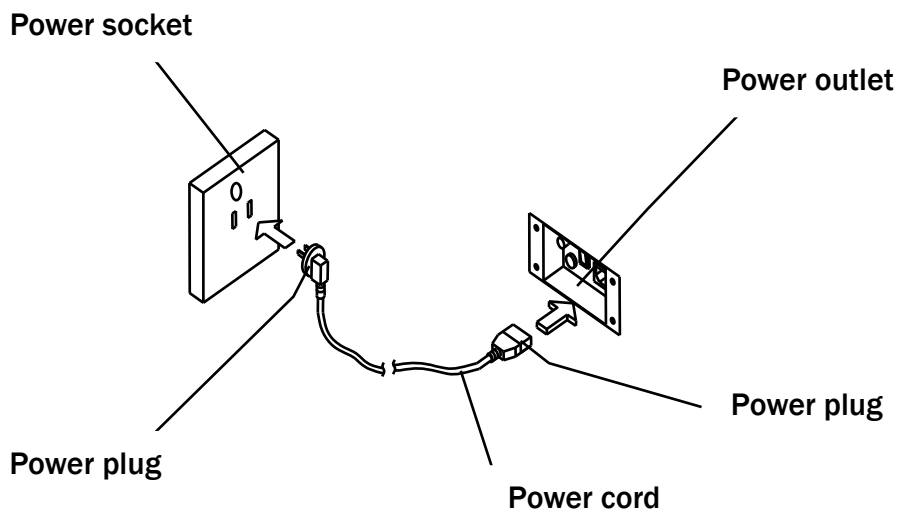

! WARNING

Ensure no heavy objects rest on the power cord. Check to make sure the game cabinet does not sit on the power cord as this could damage the cord and become hazardous.

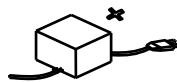

To disconnect the game, grip the plug and pull it from the wall outlet. Never pull by the cord.

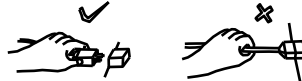

To prevent electric shock, do not touch the power plug when hand is wet.



Ensure that nothing rests on the power cord and that it is not located where it can be stepped on or tripped over.



4.5 FIRST TIME SET-UP

Step 1:

After properly setting up the machine on a flat surface, slowly add water into the playfield directly until the water reaches the indicated waterline (See section [7.5 “Adding and Draining Water”](#))

Step 2:

Take out 4 rubber rabbits from the package included and place 4 rabbits on the playfield.

Step 3:

Switch on the game and test run both sides to make sure everything works perfectly.



Notice

Always take out the rubber ducks prior to servicing/maintaining the playfield in order to facilitate service work and to prevent unnecessary damages to the ducks.

5. HOW TO PLAY

1. Squirt at the Bunnies to blast them into the caves to win lots of tickets before your time finishes.
2. Shoot water and hit the elephant in the center and see it squirt back at you.

6. PARAMETER SETTINGS

6.1 Please refer to the I/O chart and schematics included with the game.

6.2 To adjust DIP settings, please refer to the *I/O chart*. The initial settings are in CAPITAL LETTERS.

6.3 Main Board

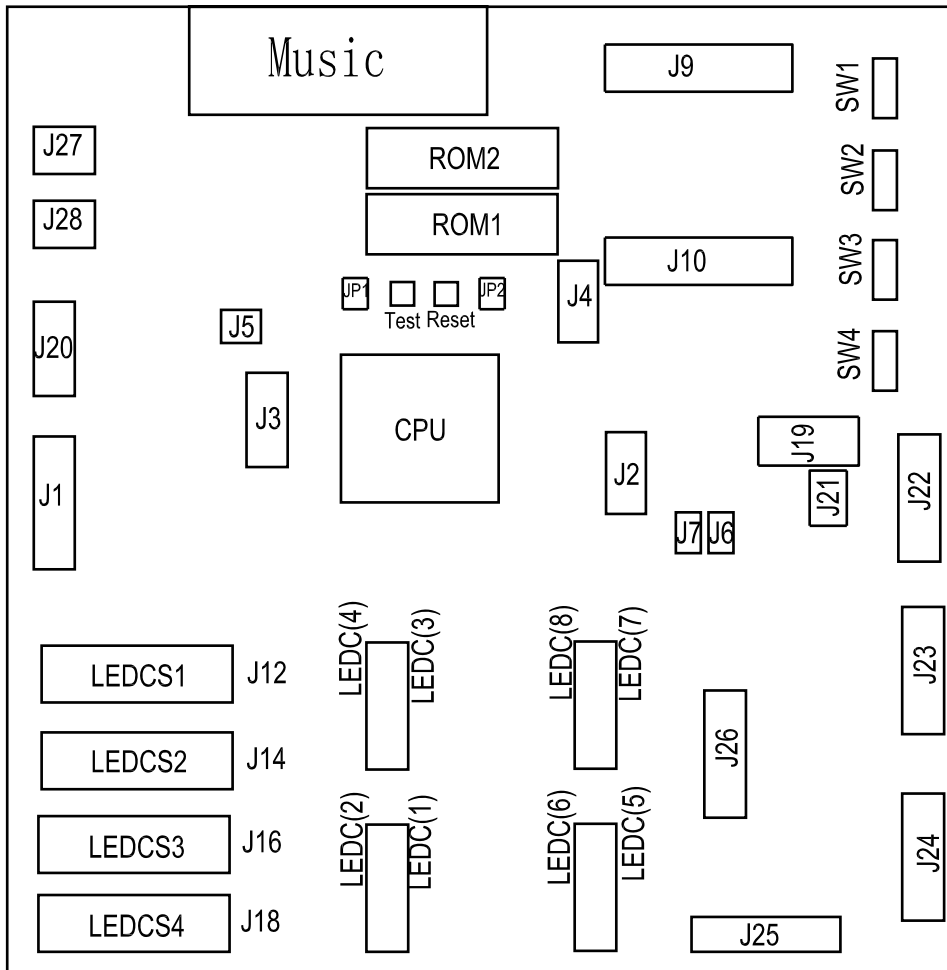

6.4 Test Display

Score LED<1>3-1 Ticket LED<1>6-5 Time LED<1>3-1

6.5 Enter the Test Mode

Press and hold TEST button in the mainboard.

6.6 Test Mode

Press TEST button once, it displays segment 8.7.6.5.4.3.2.1.

Press TEST button once again, display LED<1>1-2, LED shows DIP status.

Press TEST button again, display 2, shows switch shut off no.

Press TEST button again, display 3, Hold and press IN1-40, output feedback from OUT1-40

6.7 Error Code

E01 left Test button error E05 score sensor error E83 coin signal error
 E03 Ticket reset button error E06 water sensor error E84 coin signal error
 E04 elephant water outlet sw error

6.8 Parameter Setting

SW1_DIP

ITEM	CNT	1	2	3	4	5	6	7	8
Coin per game	1	ON	ON						
	2	off	on						
	3	on	off						
	4	off	off						
Game time (s)	30			on	on	on			
	35			off	on	on			
	40			on	off	on			
	45			OFF	OFF	ON			
	50			on	on	off			
	60			off	on	off			
	75			on	off	off			
90			off	off	off				
Points to pass the hole	1						on	on	on
	2						off	on	on
	5						on	off	on
	10						OFF	OFF	ON
	15						on	on	off
	20						off	on	off
	25						on	off	off
	30						off	off	off

SW2_DIP

ITEM	CNT	1	2	3	4	5	6	7	8
Score board	A	on	on	on	on				
	B	off	on	on	on				
	C	on	off	on	on				
	D	OFF	OFF	ON	ON				
	E	on	on	off	on				
	F	off	on	off	on				
	G	on	off	off	on				
	H	off	off	off	on				
	I	on	on	on	off				
	J	off	on	on	off				
	K	on	off	on	off				
	L	off	off	on	off				
Demo music	ON								ON
	OFF								off
						OFF	OFF	OFF	

SW3_DIP

ITEM	CNT	1	2	3	4	5	6	7	8
Ticket mode	Store Tickets in							ON	
	Call Attendant							off	
Score memory	YES								ON
	NO								off
		OFF	OFF	OFF	OFF	OFF	OFF		

SW4_DIP

ITEM	CNT	1	2	3	4	5	6	7	8
		OFF	OFF	OFF	OFF	OFF	OFF	OFF	OFF

Score board

	0-150	151-300	301-999
A	1 ticket	2 tickets	3 tickets
B	2 tickets	3 tickets	4 tickets
C	2 tickets	4 tickets	6 tickets
D	5 tickets	8 tickets	12 tickets
E	8 tickets	12 tickets	15 tickets
F	12 tickets	15 tickets	20 tickets
G	15 tickets	18 tickets	25 tickets
H	18 tickets	25 tickets	30 tickets
I	25 tickets	40 tickets	60 tickets
J	10 tickets	10 tickets	10 tickets
K	15 tickets	15 tickets	15 tickets
L	20 tickets	20 tickets	20 tickets

TICKET MECH PORT		SPEAKER PORT	
J21-1	Ticket dirve	J27-1	L speaker +
J21-2	Ticket signal	J27-2	L speaker -
J21-3	12V	J28-1	R speaker +
J21-4	GND	J28-2	R speaker -
J21-5		Counter	
J21-6		J8-1	+12V
J21-7		J8-2	+12V
J21-8		J8-3	Coin counter
		J8-4	Ticket counter

OUTPUT

OUTPUT	CONTENT	OUTPU	CONTENT
J22-1	Water outlet	J4-1	Main
J22-2	Elephant water outlet water bump	J4-2	Main decaDI
J22-3	Backwater	J4-3	Main
J22-4	Ticket light	J4-4	Main
J22-5	Hole light red	J4-5	Marquee SI
J22-6	Hole light	J4-6	Marquee DI
J22-7	Hole light blue	J4-7	Marquee CI
		J4-8	Marquee LI

INPUT

INPUT	CONTENT
J9-1	Test
J9-3	Ticket reset
J9-4	elephant water SW
J9-5	Score sensor
J9-6	Water sensor

VOL POT PORT		COIN MECH PORT	
J20-1	L POT ①	J19-1	
J20-2	L POT ②	J19-2	Coin signal
J20-3	R POT ①	J19-3	GND
J20-4	R POT ②	J19-4	
J20-5	L POT ③	J19-5	
J20-6	R POT ③	J19-6	12V

7. MAINTENANCE & INSPECTION

7.1 Safety Check

Check the points listed before operating the machine. These checks are necessary for safe machine operation:

1. Try to run the game before operation each day.
2. Conduct monthly routine checks of game components ensure good working condition
3. Check the machine regularly for dust and clean when necessary.

Note: Parts and components require preventative maintenance to be kept running smoothly.

★ Installation and Test

- Firstly check the assembling instructions and assemble the game.
- Secondly, adjust the leveler of the game on even ground.
- After installation, plug in. check the game operation. If there is a problem, stop the game and please check the trouble shooting section of this manual.

★ Game maintenance

- Try to run the game before operation each day.
- Use soft cotton to clean the machine when it accumulated dust.
- Conduct monthly routine checks of game components ensure good working condition
- Check the machine regularly for dust and clean when necessary.◦

★ Clean up

➤ Cabinet

use soft brush clean up the dust on the surface, and use a soft cloth wipe it off.

➤ Cooling fans and air-vents

Cooling fan is influence in machine operation, because the clean environment and smooth air circulation is very important. Please ensure that enough thermal dissipation space for cooling fan, clean and replace fans regularly.

7.2 Regular Cleaning:

It is recommended that the water filter be cleaned once a month and changed every 6 months. If the game is placed in an area exposed to high level of dust, increase cleaning frequency.

7.3 Pump Assembly Setting:

- Pressure valve should be kept in a half open state. Adjusts the gun pressure.
- Pressure meter default setting is 0.1.
- Drain Valve should be closed during normal times and only opened for draining or to change water.
- Drainage button

7.4 Handling Precautions

When installing or inspecting the machine, be very careful of the following points and pay attention to ensure that the player can enjoy the game safely.

Non-compliance with the following points or inappropriate handling running counter to the cautionary matters herein stated can cause personal injury or damage to the machine



WARNING

- Before servicing the machine, be sure to turn power off. Servicing without turning the power off can cause electric shock or short circuit.
- To avoid electric shock or short circuit, do not plug then unplug the power quickly
- Do not expose power cords and earth wires, these are susceptible to damage.
- Damaged cords and wires can cause electric shock or short circuit and should be replaced immediately.
- When or after installing the product, avoid pulling the power cord to prevent unnecessary wear and tear. Use the power button to disconnect power.
- In case the power cord is damaged, ask for replacement through where the product was purchased from or replace locally. Continued usage of damaged cord can cause fire, electric shock or leakage.
- Perform grounding appropriately. Inappropriate grounding can cause electric shock.
- Use fuses that meet specified rating. Fuses exceeding can cause an electric shock.
- Should a problem occur, turn off the power immediately and stop operating the machine. Unplug the power cord of the service outlet. Operating the machine without correcting the problem may cause a fire or injuries.
- Insert the power plug securely into the outlet. Poor contact may cause overheating, resulting in fire or burns.
- To ensure the warning labels attached on the machine are visible and legible, install the machine in a well-lit location, and keep the labels clean at all times. Make sure the labels are not hidden behind other game machines.

7.5 How to Add Water

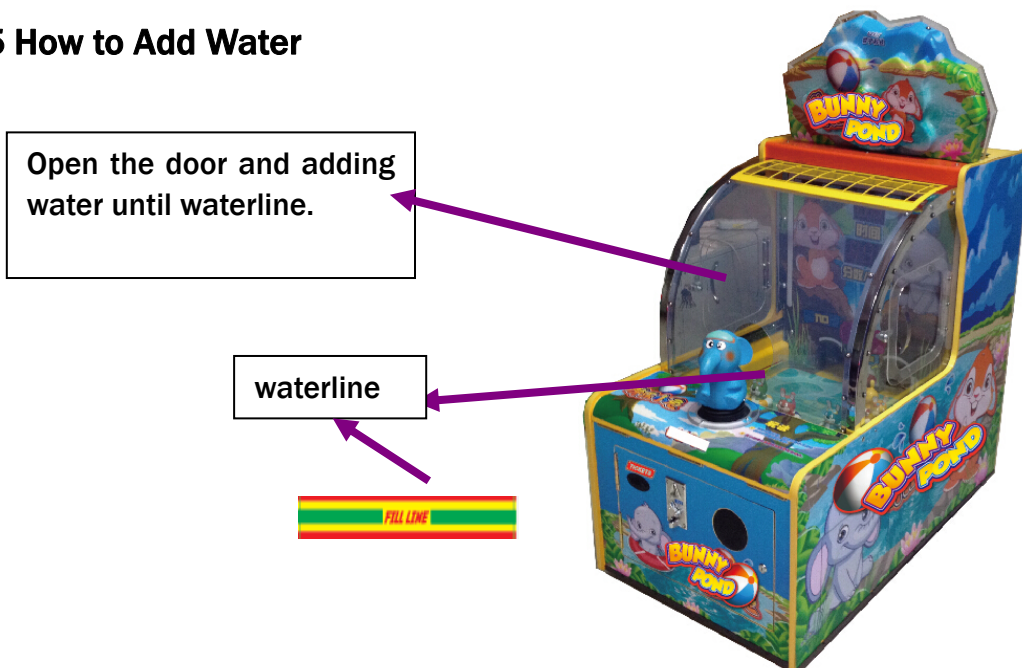

- 1 When adding water, please turn off the drain valve and lock tightly water pump drain screw, Release drain button.
- 2 Make sure no crack on water tank and no loose on water pipe connectors. Keep the water tank in the correct position. The waterproof cloth should in the funnel.
- 3 When first time to fill water into the water tank. This is the max capacity for the water tank.

Notice:

1. Clean the water tank every month.
2. Clean the foam every month; change the foam every 3 months.
3. Change distilled water every month. Please refer to 8.6

7.5 Elephant Water Pressure Adjustment

Adjust the water pressure by adjusting the valve:

1. Elephant water pressure will be higher when the valve is closed. Elephant water pressure will be lower when the valve is open.
2. Open drain valve to drain. After draining the water close drain valve.

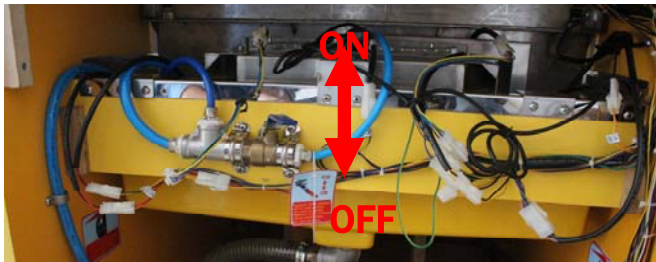

7.6 Change the water

- (1) Place drain hose into a bucket.



- (2) Counterclockwise spin drain SW to drain water.

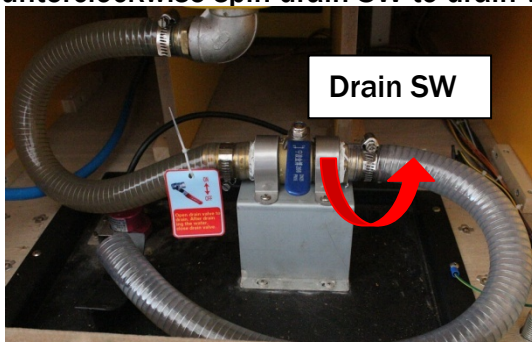

After draining the water, close drain SW, replace hose and assure no leaks.

8. OVERALL CONSTRUCTION

8.1 Mechanism Part1:

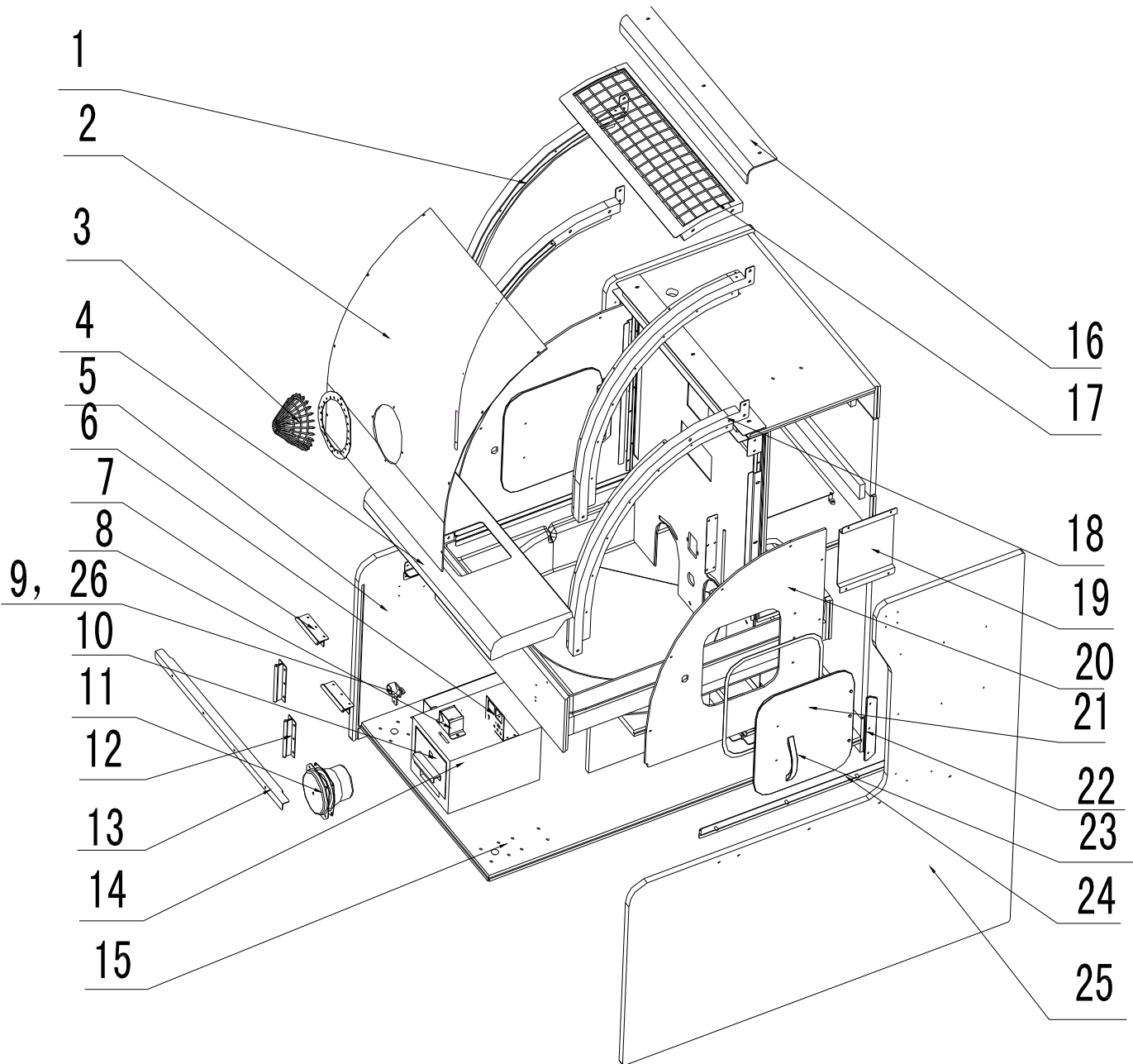

No.	Code No.	Part No.	Name	Spec.	Qty
1	B119-105-000	20211303005	L bend	Stainless steel 304	1
2	B119-605-000	20611303005	Water plate	Plexi. PC	1
3	B119-613-000	20611303013	Webs	Plexi. PVC	1
4	B119-108-000	20211303008	Control panel	Metal	1
5	B119-502-000	20311303002	L side board	Plywood	1
6	B119-175-000	26000044000	New meter bracket	Metal	1
7	B119-421-000	26300000011	Hinge 1	4 inch	3
8	B119-117-000	20211303017	Coin funnel	Q235	1
9	B119-101-000	20211303001	Ticket out fixed bracket	Zinc	1
10	B119-434-000	25300172001	Lock	171B	1
11	B119-170-000	26000027000	4" speaker net	$\delta=0.5\text{mm}$	1
12	B119-412-000	26300000001	Hinge 2	4 inch	4
13	B119-128-000	20211303028	Water tank front edge	Stainless steel 304	1
14	B119-116-000	20211303016	Coin box	Q235	1
15	B119-501-000	20311303001	Bottom board	Plywood	1
16	B119-617-000	20611303017	Mask plexi.	Orange	1
17	B119-110-000	20211303010	Safety net	Metal/welding	1
18	B119-109-000	20211303009	R bend	Stainless steel 304	1
19	B119-171-000	26000032000	PC power fixed bracket	Metal	1
20	B119-602-000	20611303002	L & R plexi.	Plexi.	2
21	B119-615-000	20611303015	Sides door board	Plexi.	2
22	B119-120-000	20211303020	Hinge 3	Stainless steel 304	2
23	B119-433-000	25102000007	Handle	Stainless steel 125×16	2
24	B119-129-000	20211303029	Water tank L&R edge	Stainless steel 304	2
25	B119-503-000	20311303003	R side board	Plywood	1
26	B119-601-000	20611303001	Ticket out light cover	Plexi.	1

8.2 Mechanism Part2:

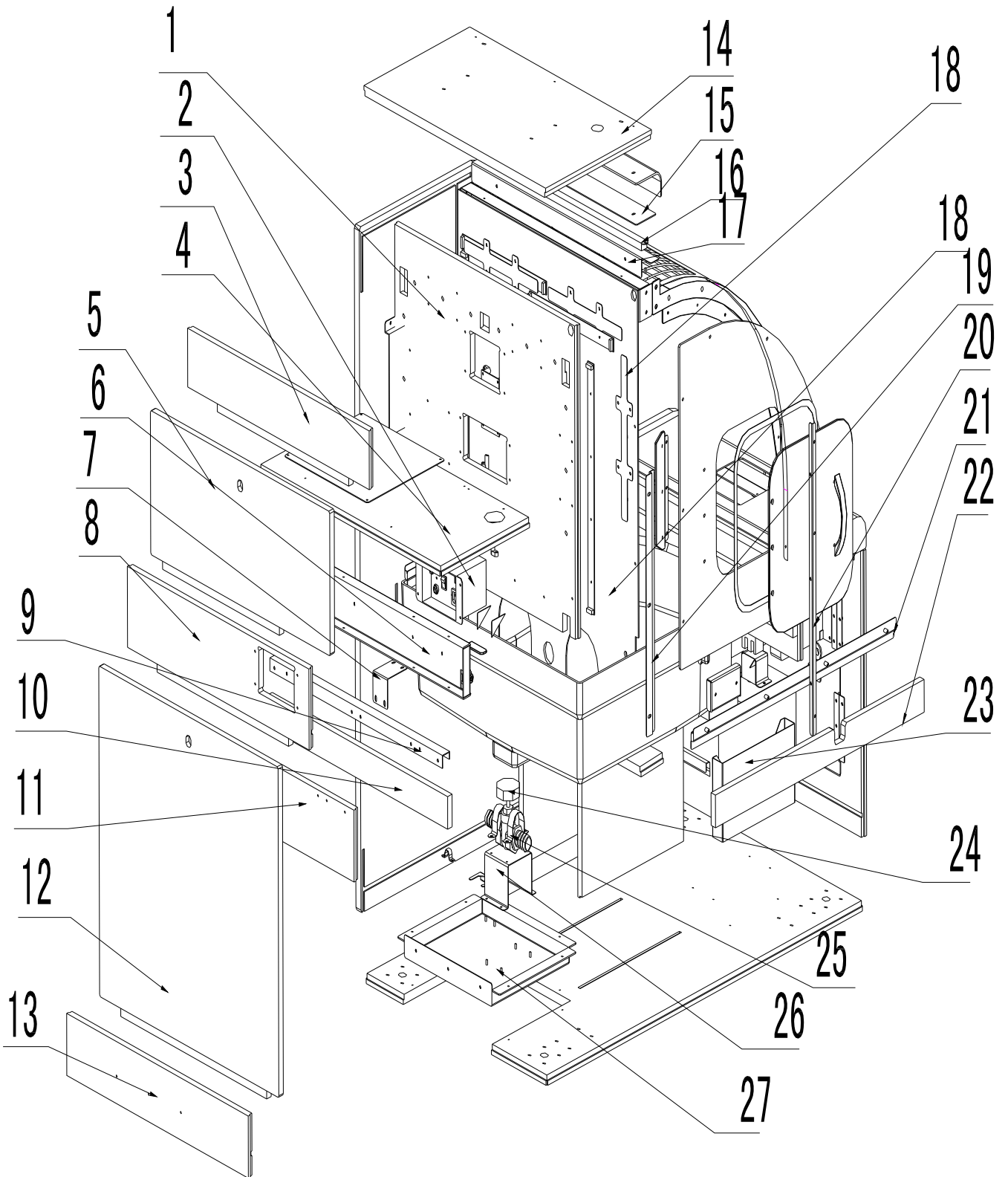

No.	Part No.	Code	Name	Spec.	Qty
1	B119-509-000	20311303009	Main panel board	Plywood	1
2	B119-172-000	26000042001	Wiring box	Metal	1
3	B119-507-000	20311303007	Back side board 3	MDF JQ11067	1
4	B119-508-000	20311303008	Middle board	MDF JQ11067	1
5	B119-520-000	20311303020	Back door board 2	MDF JQ11067	1
6	B119-512-000	20311303012	Footboard 2	MDF JQ11067	1
7	B119-102-000	20211303002	Water board fixed plate	Stainless steel 201	1
8	B119-506-000	20311303006	Back side board 2	MDF JQ11067	1
9	B119-127-000	20211303027	Water tank back platen	Stainless steel 304	1
10	B119-511-000	20311303011	Footboard 1	MDF JQ11067	1
11	B119-512-000	20311303012	Footboard 2	MDF JQ11067	1
12	B119-519-000	20311303019	Back door board 1	MDF JQ11067	1
13	B119-505-000	20311303005	Back side board 1	MDF JQ11067	1
14	B119-510-000	20311303010	Top board	MDF JQ11067	1
15	B119-122-000	20211303022	Top light strip fixed plate	Stainless steel	1
16	B119-622-000	20611303022	Top light strip baffle	Plexi,	1
17	B119-121-000	20211303021	Light strip baffle	Stainless steel	1
18	B119-104-000	20211303004	Light PCB fixed plate	Metal	4
19	B119-106-000	20211303006	L& R bottom molding	Q235	2
20	B119-616-000	20611303016	Side door fixed plate	Plexi.	2
21	B119-621-000	20611303021	L&R seal strip	Black EVA	2
22	B119-513-000	20311303013	Water tank support board 1	MDF JQ11067	2
23	B119-167-000	26000007000	Ticket box 120	Q235	1
24	B119-423-000	25101120049	25 copper ball	DN25 1 inch	1
25	B119-113-000	20211303013	Water hose fixed plate	Stainless steel	2
26	B119-112-000	20211303012	Water hose support block	Metal	1
27	B119-111-000	20211303011	Waterproof pond	Metal	1

8.3 Mechanism Part3:

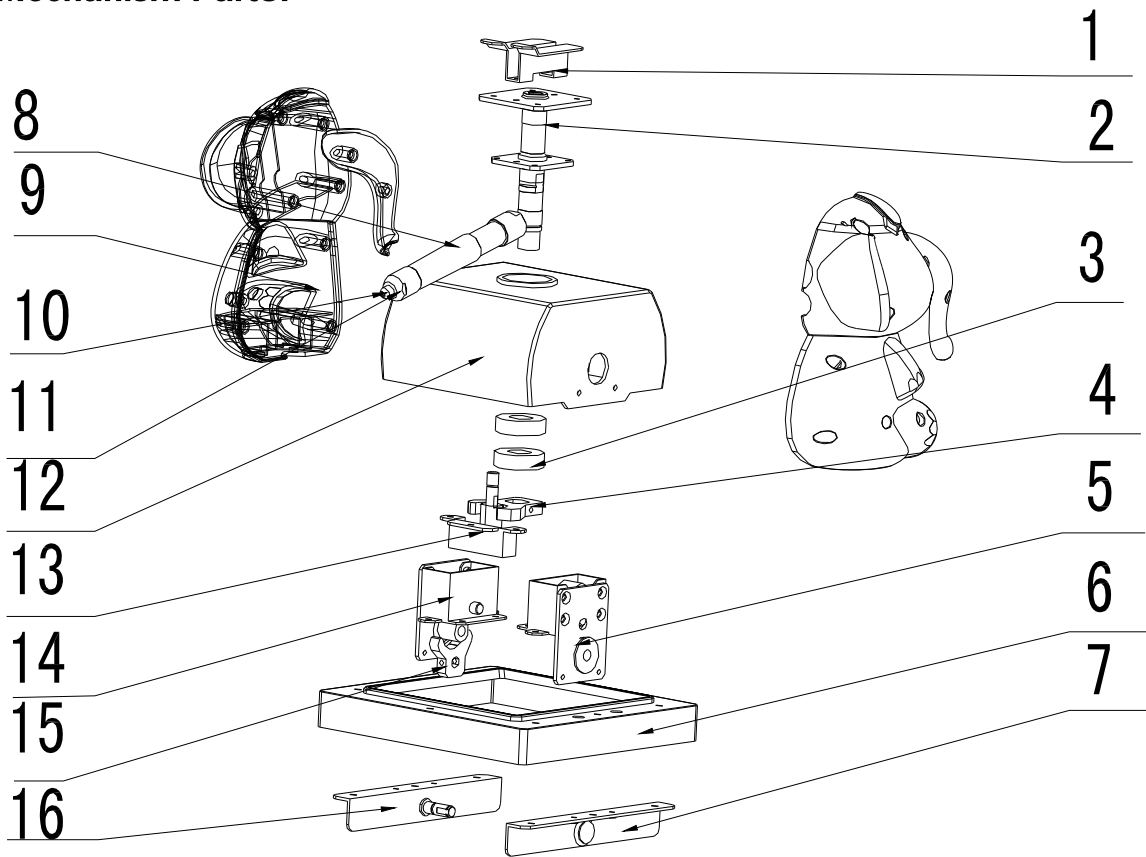

No.	Part No.	Code	Name	Material	Qty
1	B119-157-000	20211303057	Water gun fixed base	Stainless steel	1
2	B119-151-000	20211303051	Lengthways spindle	Stainless steel	1
3	B119-419-000	20106000081	Deep groove ball bearing	6003-2Z	2
4	B119-153-000	20211303053	Front & back limit block	45#	1
5	B119-420-000	20106000102	Out ring deep groove ball br.	F608Z	2
6	B119-635-000	20641340018	Mechanism base	Nylon	1
7	B119-163-000	20211402009	Front & back rotation shaft	Stainless steel 304	2
8	B119-154-000	20211303054	Water gun hose	Brass	1
9	B119-629-000	20611303029	Elephant water gun	ABS	1
10	B119-155-000	20211303055	Water gun mouth	Brass	1
11	B119-156-000	20211303056	Gun mouth cover	Brass	1
12	B119-156-000	20641340019	Gun mouth cover	Nylon	1
13	B119-152-000	20211303052	L & R limit block	45#	1
14	B119-637-000	20211402007	Shockproof glue	Flexane	1
15	B119-165-000	20211402006	Fixed base reinforcing plate	Stainless steel 304	1

8.4 Mechanism Part4:

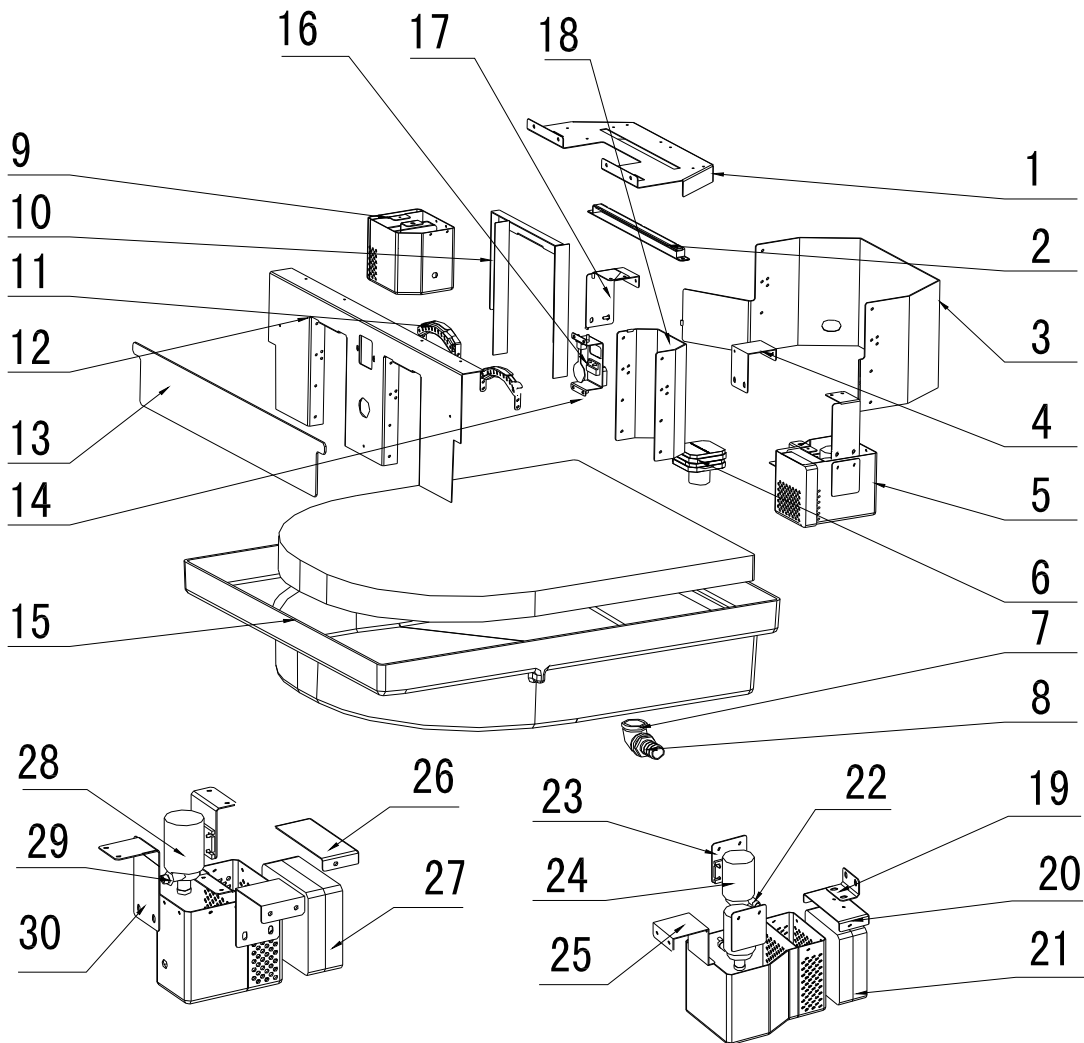

No.	Part No.	Code	Name	Material	Qty
1	B119-137-000	20211303037	Hole water plate	Stainless steel 304	1
2	B119-138-000	20211303038	Light bar fixed plate	Metal	1
3	B119-624-000	20611303024	Outer pathway	Plexi. PVC	1
4	B119-149-000	20211303049	Pump fixed plate	Stainless steel	1
5	B119-143-000	20211303043	R filter box	Stainless steel	1
6	B119-131-000	20211303031	Water box bottom joint	Brass	1
7	B119-424-000	25101020040	25 copper square bent	DN25 1 inch	1
8	B119-422-000	25101100058	25 copper female teeth air connector	DN25 1 inch	1
9	B119-147-000	20211303047	L filter box	Stainless steel	1
10	B119-139-000	20211303039	Sensor fixed plate	Stainless steel	1
11	B119-136-000	20211303036	Chain light fixed base	Stainless steel	2

No.	Part No.	Code	Name	Material	Qty
12	B119-135-000	20211303035	Chain light cover plate	Stainless steel	2
13	B119-609-000	20611303009	Splitter plate	Plexi.	1
14	B119-177-000	20210778008	Target	Stainless steel	1
15	B119-612-000	20611303012	Water tank	Orange ABS	1
16	B119-150-000	20211303050	Target base	Stainless steel	1
17	B119-140-000	20211303040	L filter box fixed block 1	Stainless steel	1
18	B119-625-000	20611303025	Inner pathway	Plexi. PVC	1
19	B119-142-000	20211303042	R filter box fixed block 1	Stainless steel	1
20	B119-141-000	20211303041	R filter box cover	Stainless steel	1
21	B119-627-000	20611303027	R filter foam 1		1
22	B119-402-000	25103000042	Hose clamp	Φ10~Φ16	2
23	B119-145-000	20211303045	Pump fixed plate	Stainless steel	2
24	B119-401-000	23410000142	Brushless DC pump	12V/1.1A13.2W /840(L/H)	3
25	B119-144-000	20211303044	R filter box fixed block 2	Stainless steel	1
26	B119-146-000	20211303046	L filter box cover	Stainless steel	1
27	B119-628-000	20611303028	L filter foam 1		1
28	B119-307-000	20102100010	Hexagon nut with flange	Stainless steel	8
29	B119-404-000	20116000025	O type rubber seal ring	18×4	1
30	B119-148-000	20211303048	L filter box fixed block 2	Stainless steel	1

8.5 Mechanism Part5:

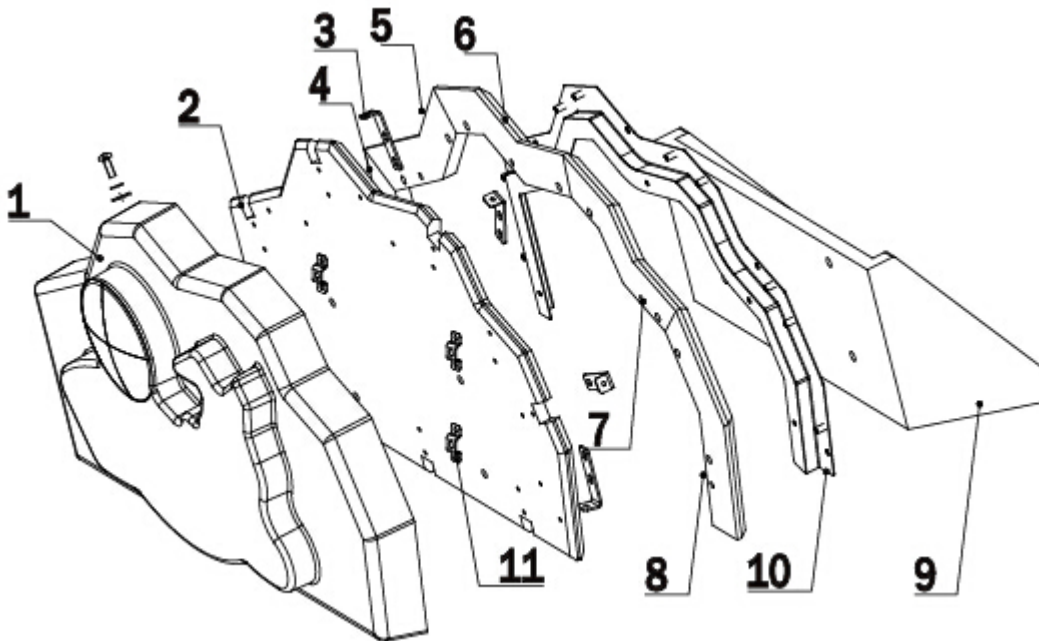

No.	Part No.	Code	Name	Spec.	Qty
1	B119-705-000	20511303001	Top marquee vacuum foam	620x359x3	1
2	B119-523-000	20311303023	Marquee mounted board	MDF	1
3	B119-159-000	20211303059	Vacuum foam fixed plate	δ2 metal	8
4	B119-630-000	20611303030	Marquee light plexi. 1	δ15	1
5	B119-631-000	20611303031	Marquee light plexi. 2	δ15	1
6	B119-632-000	20611303032	Marquee light plexi. 3	δ15	1
7	B119-633-000	20611303033	Marquee light plexi. 4	δ15	1
8	B119-634-000	20611303034	Marquee light plexi. 5	δ15	1
9	B119-522-000	20311303022	Marquee fixed board	MDF	1
10	B119-161-000	20211303061	Marquee light bar mounted plate	δ1 powder black	1
11	B119-160-000	20211303060	Marquee light bar fixed plate	δ1	4

8.6 Mechanism Part5:

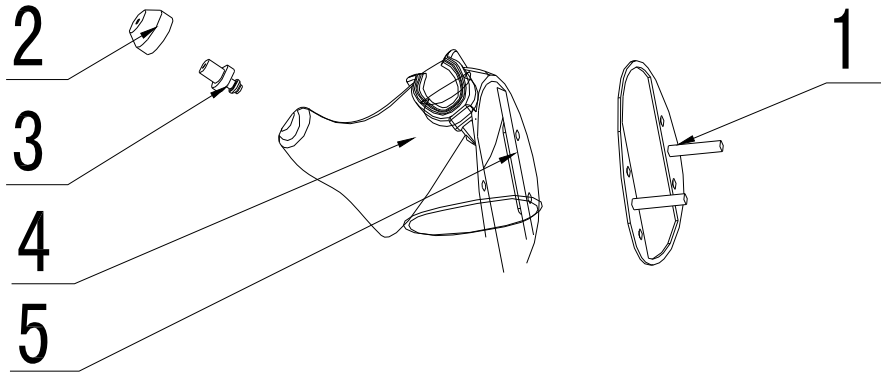

No.	Part No.	Code	Name	Spec.	Qty
1	B119-124-000	20211303024	Elephant head fixed plate 2	Stainless steel 304	1
2	B119-125-000	20211303025	Elephant gun head	Brass	1
3	B119-126-000	20211303026	Elephant gun mouth	Brass	1
4	B119-618-000	20611303018	Elephant head	Glue	1
5	B119-123-000	20211303023	Elephant head fixed block 1	Stainless steel 304	2

8.7 Mechanism Part6:

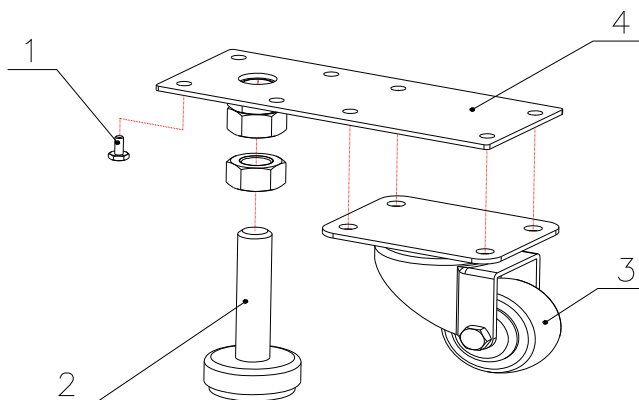

No.	Part No.	Code	Name	Spec.	Qty
1	B119-335-000	20104020026	Cross recessed hexagon bolts with indentation	Stainless steel	32
2	B119-168-000	26000008000	2.5" leveller	Q235	4
3	B119-410-000	25501000056	2.5" castor	3-2689-52	4
4	B119-169-000	26000010000	2.5" castor support bracket	Q235	4

8.8 Electrical Part1:

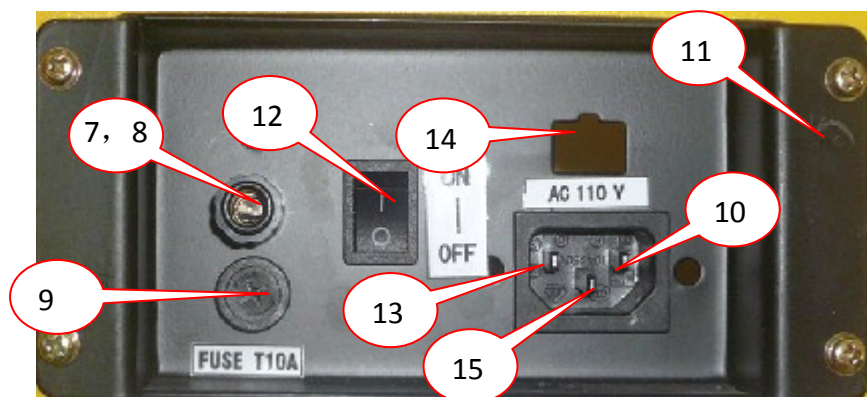
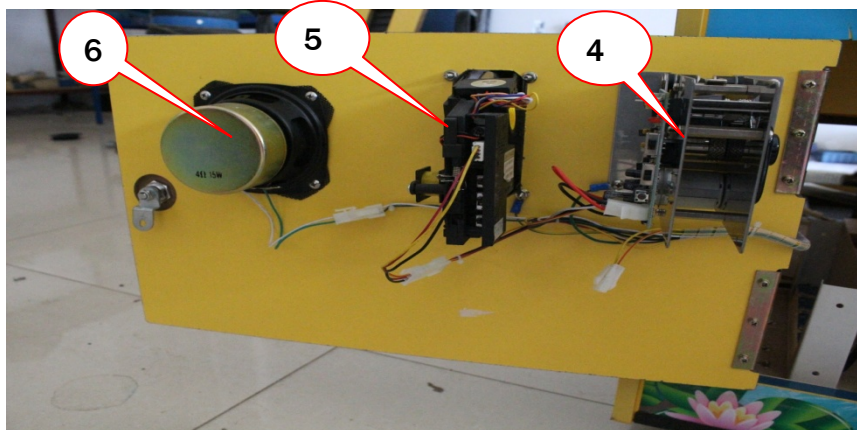

No.	Part No.	Code	Name	Qty
1	B119-444-000	21706000047	Time digital	1
2	B119-454-000	22002016001	Main panel LED light strip	1
3	B119-445-000	21706000037	2.3" digital PCB	0.9
4	B119-466-000	23100000006	Ticket dispenser	1
5	B119-465-000	22301000001	Coin mech.	1
6	B119-452-000	22801000028	Speaker	1
7	B119-470-000	21901000010	Fuse	1
8	B119-436-000	21902000006	Fuse base	1
9	B119-438-000	21412000001	Terminal	1
10	B119-441-000	23301018008	Power cord	1
11	B119-001-000	26000042000	New wiring box	1
12	B119-439-000	22601000005	Small rocket SW	1
13	B119-435-000	23201000001	Filter	1
14	B119-174-000	26000042003	Net wiring cover	1
15	B119-172-000	26000042001	Wiring box	1

8.9 Electrical Part2:

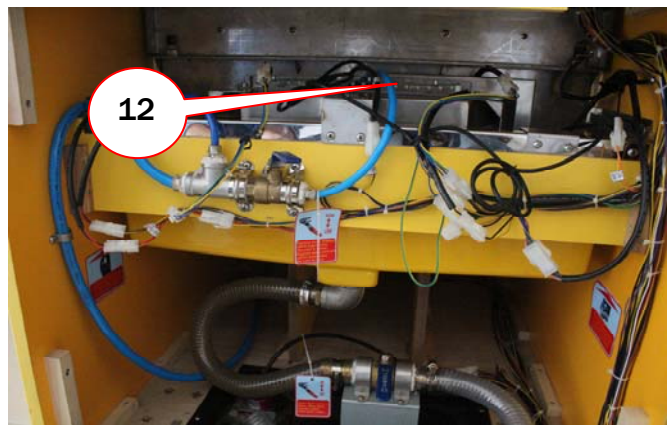
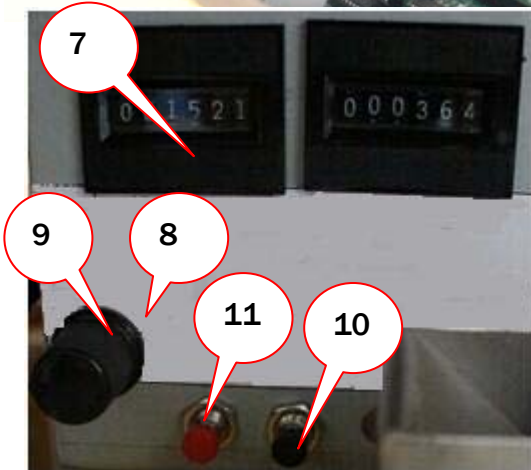
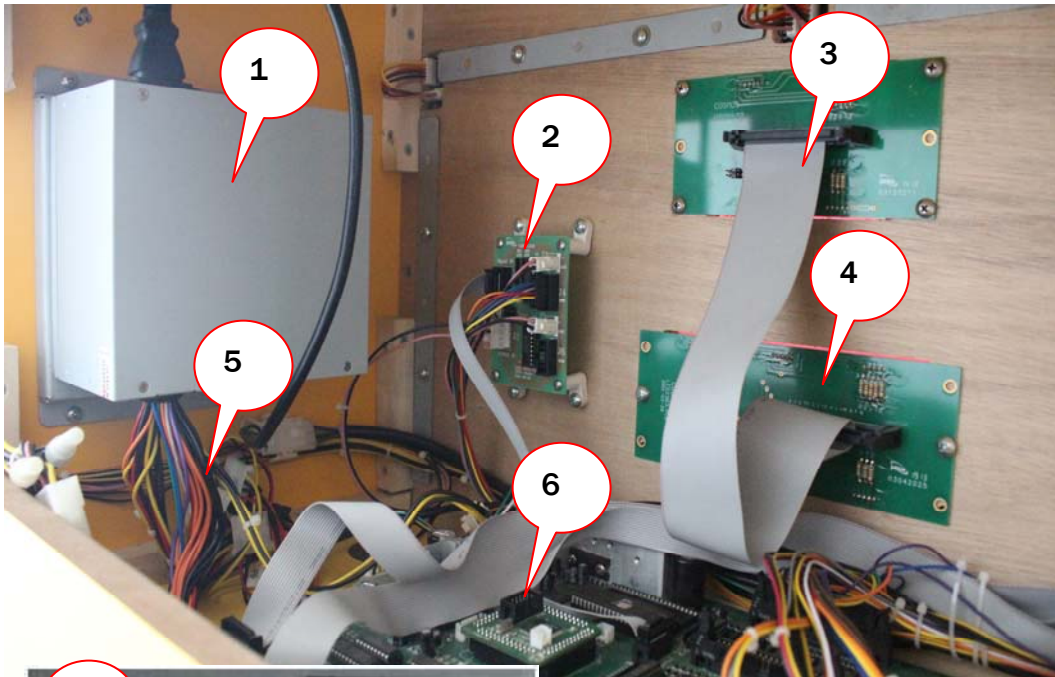

No.	Part No.	Code	Name	Qty
1	B119-440-000	21602000001	Power supply	1
2	B119-443-000	20741019001	PCB	1
3	B119-446-000	20711213001	PCB	1
4	B119-447-000	20711213002	PCB	1
5	B119-467-000	23309000152	Wiring	1
6	B119-442-000	21701000014	IO board	1
7	B119-461-000	23000000006	23000000006	2
8	B119-459-000	21709000002	POT PCB	1
9	B119-464-000	22403000001	POT knob	1
10	B119-463-000	22402030002	Test button	1
11	B119-462-000	22402010002	Service button	1
12	B119-455-000	22002017011	Hole light strip	1

9. DECAL



No.	Part No.	Code	Name	Spec.	Qty
1	B119-702-000	20511303A001	Top marquee vacuum foam	Plexi.	1
2	B119-703-000	20511303A002	Main panel decal	Plexi.	1
3	B119-704-000	20511303A003	L side board decal	Frosted PVC	1
4	B119-705-000	20511303A004	R side board decal	Frosted PVC	1
5	B119-706-000	20511303A005	Control panel decal	Frosted PVC	1
6	B119-707-000	20511303A006	Front door board decal	Frosted PVC	1
7	B119-716-000	20511303008	Water tank decal	PVC100u	1
8	B119-717-000	20511303009	Water gap decal	PVC100u	1
9	B119-726-000	20511303A016	L side board back decal	Frosted PVC	1
10	B119-727-000	20511303A017	R side board back decal	Frosted PVC	1
11	B119-718-000	25600000034	Ticket out label	PVC100u	1

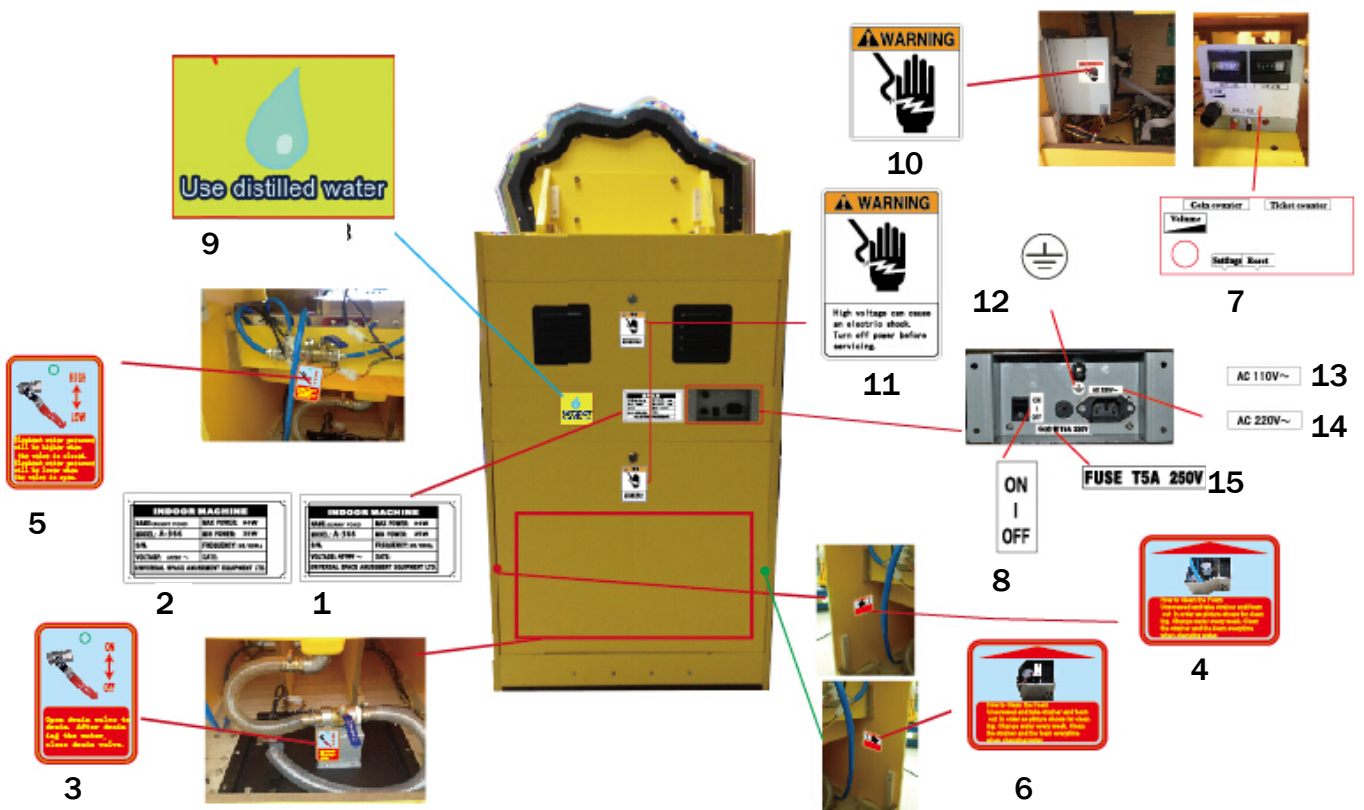

No.	Part No.	Code	Name	Spec.	Qty
1	B119-710-000	20511303A011	Non-certification 110V nameplate	128x68	1
2	B119-709-000	20511303A010	Non-certification 220V nameplate	128x68	1
3	B119-711-000	20511303A012	Instruction label	50x70	1
4	B119-712-000	20511303A013	Instruction label 1	90x70	1
5	B119-713-000	20511303A014	Instruction label 2	50x70	1
6	B119-714-000	20511303A015	Instruction label 3	90x70	1
7	B119-708-000	20511303A007	Meter label	88x35	1
8	B119-720-000	25601000017	Power SW label B	8×18	1
9	B119-715-000	20511106033	Water mark label	106X106	1
10	B119-722-000	25601000036	High voltage warning(Small)	41×42	1
11	B119-723-000	25601000037	High voltage warning(Large)	62×88	2
12	B119-725-000	25600000091	GND label		1
13	B119-726-000	25600000071	New voltage 110V	25X6	1
14	B119-718-000	25600000072	New voltage 220V	25X6	1
15	B119-724-000	25601000067	Fuse T5A/250V	33X6	1

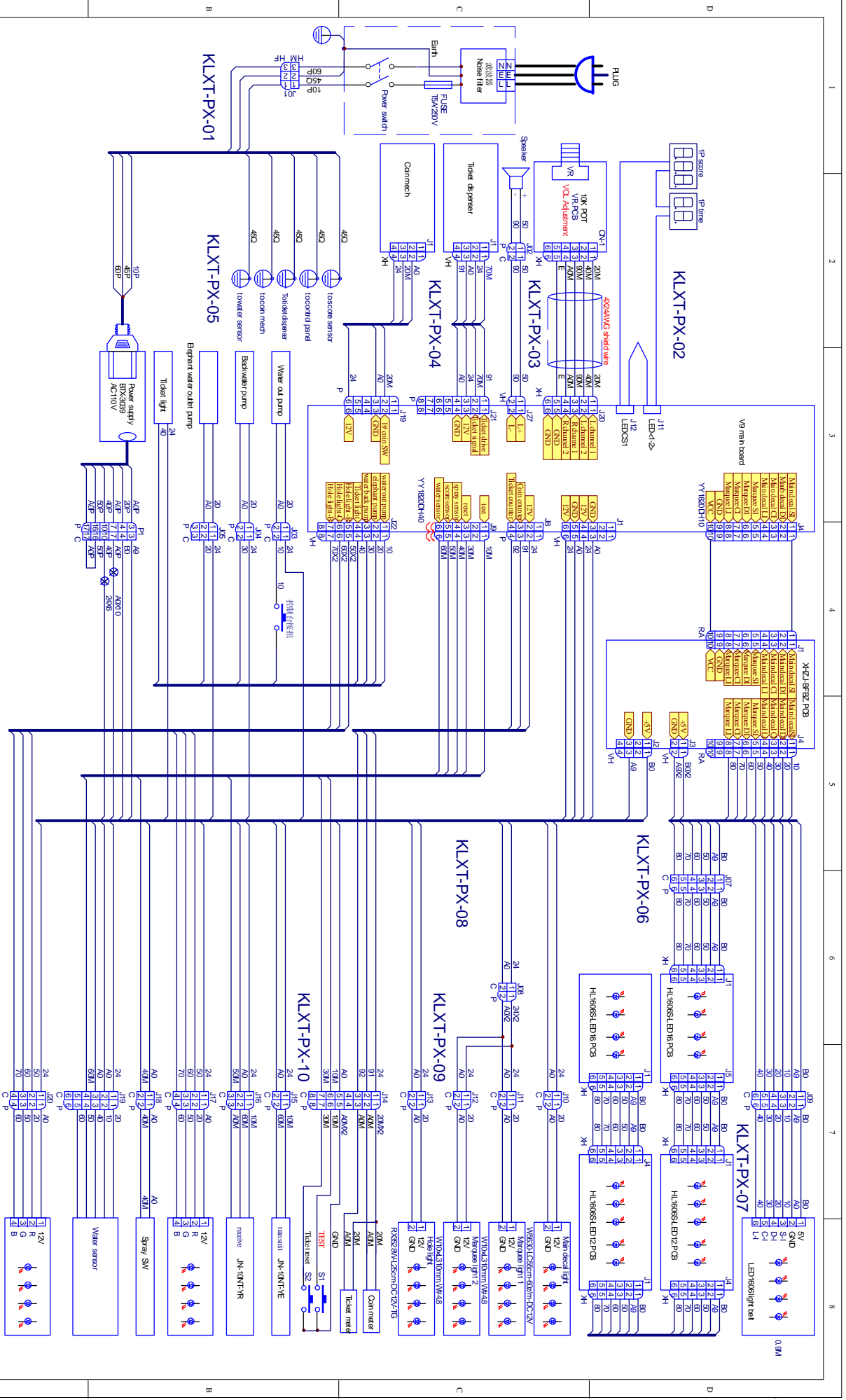

Note: The color and the type of the wire must be the same for comparison.

Wire Type	Wire Color	Wire Type	Wire Color
1	White	1	White
2	Black	2	Black
3	Green	3	Green
4	Yellow	4	Yellow
5	Orange	5	Orange
6	Red	6	Red
7	Brown	7	Brown
8	Grey	8	Grey
9	White	9	White
10	Black	10	Black
11	Green	11	Green
12	Yellow	12	Yellow
13	Orange	13	Orange
14	Light Blue	14	Light Blue
15	Light Green	15	Light Green
16	Dark Blue	16	Dark Blue
17	Dark Green	17	Dark Green
18	Dark Red	18	Dark Red
19	Dark Brown	19	Dark Brown
20	Dark Grey	20	Dark Grey

Wire Type	Wire Color	Wire Type	Wire Color
1	White	1	White
2	Black	2	Black
3	Green	3	Green
4	Yellow	4	Yellow
5	Orange	5	Orange
6	Red	6	Red
7	Brown	7	Brown
8	Grey	8	Grey
9	White	9	White
10	Black	10	Black
11	Green	11	Green
12	Yellow	12	Yellow
13	Orange	13	Orange
14	Light Blue	14	Light Blue
15	Light Green	15	Light Green
16	Dark Blue	16	Dark Blue
17	Dark Green	17	Dark Green
18	Dark Red	18	Dark Red
19	Dark Brown	19	Dark Brown
20	Dark Grey	20	Dark Grey

Wire Type	Wire Color	Wire Type	Wire Color
1	White	1	White
2	Black	2	Black
3	Green	3	Green
4	Yellow	4	Yellow
5	Orange	5	Orange
6	Red	6	Red
7	Brown	7	Brown
8	Grey	8	Grey
9	White	9	White
10	Black	10	Black
11	Green	11	Green
12	Yellow	12	Yellow
13	Orange	13	Orange
14	Light Blue	14	Light Blue
15	Light Green	15	Light Green
16	Dark Blue	16	Dark Blue
17	Dark Green	17	Dark Green
18	Dark Red	18	Dark Red
19	Dark Brown	19	Dark Brown
20	Dark Grey	20	Dark Grey



UNIS

Design	Technics	Name	Bunny Pond Wiring Diagram
Printing	Standard	Client	DomusNY
Check		Date	25-Sep-2014
		Drawn by	KLXT-PX-00
		Version	V1.0
		Page	



Have Questions? Contact us!

www.universal-space.com

 International Support Center	 USA Support Center
Tel: +1-905-477-2823 Fax: +1-905-477-2660 Email: service@universal-space.com (Contact: Clement Yau)	Tel: 972-241-4263 Fax: 214-919-4918 Email: tsnelling@unisusasupportcenter.com (Contact: Tim Snelling)