



 Be Sure  
to Read this  
Manual  
Before Use



# Operation Manual



[www.universal-space.com](http://www.universal-space.com)

# CONTENT

Important Safety Instructions .....	2
1. SPECIFICATIONS .....	4
2. PACKAGE CONTENTS.....	5
3. PART NAMES .....	6
4. SET UP & INSTALLATION.....	7
5. HOW TO PLAY .....	11
6. GAME OPTIONS .....	12
7. MAINTENANCE & INSPECTION.....	18
8. OVERALL CONSTRUCTION .....	19



## WARNING

Non-technical personnel who do not have technical knowledge and Expertise should refrain from performing such work that this manual require or perform tasks which are not explained in this manual. Failing to comply can cause severe accidents such as electric shock or other serious injuries. All repairs must be performed to original manufacturer specifications.

**WARNING:** To reduce the risk of fire, electric shock or personal injury, unplug or disconnect the machine from the power supply before servicing.



Thank you for purchasing **Astro Invasion**. We hope you enjoy the product.

This manual contains valuable information about how to operate and maintain your game machine properly and safely. It is intended for the owner and/or personnel in charge of product operation. Carefully read and understand the instructions.

If you need any help during installation and setup please utilize this manual and troubleshooting guide. If the product fails to function properly, *non-technical personnel should under no circumstance attempt to service the machine*. Contact your distributor or manufacturer for help.

Before use, please read **IMPORTANT SAFETY INSTRUCTIONS**.

## **IMPORTANT SAFETY INSTRUCTIONS**

**To ensure the safe usage of this product, carefully read and understand these instructions before operating your game. Save these instructions for future reference.**

Use this product only as described in this manual. Other uses not recommended may cause fire, electric shock or personal injury. Unplug the game from the outlet when not in use, when moving from one location to another, and before cleaning/servicing.

Explanations which require special attention are indicated by signs of warning. Depending on the potential hazardous degree, the terms: **NOTE**, **NOTICE**, and **WARNING** are used.

**NOTE:** A NOTE indicates useful hints or information about product usage.

**NOTICE:** A NOTICE indicates potential damage to product and how to avoid the problem.

**WARNING:** A WARNING indicates a potential for product damage or serious personal injury.

It is important to understand the meaning of the following **HAZARD SIGNS** before continuing:

### **High Voltage and Shock Hazard:**

High voltage can cause electric shock.  
Turn off/unplug power before servicing.



### **High Temperature Hazard:**

This part may cause scalding.  
Do not touch. Surface may be hot.



## **No Touching Hazard:**

This part may be hot or can cause electric shock.

Do not touch.



Use the following safety guidelines to help ensure your own personal safety and to help protect your equipment and surrounding environment from potential damage.

 **This product is an indoor game machine. Do not install outdoors.**

Avoid installing in the following places to prevent fire, electric shock, injury and/or machine malfunctioning:

- Places subject to rain/moisture, or places subject to high humidity.
- Places subject to direct sunlight, or places subject to extremely hot or cold temperatures to ensure that it is used within the specified operating range.
- Places where inflammable gas may be present or in the vicinity of highly inflammable/volatile chemicals or items that can easily catch fire
- On unstable or sloped surfaces. The machine may topple or cause unforeseen accidents.
- Vicinity of fire exits, fire extinguishers etc that may block/prevent safety measures

### **IMPORTANT NOTE:**

**ALL REPAIRS MUST BE DONE TO ORIGINAL MANUFACTURER SPECIFICATIONS. FAILURE TO DO SO VOID ALL WARRANTIES AND OPERATOR ASSUMES ALL RISKS.**

Note: The contents of this manual may be updated without notice

# 1. SPECIFICATIONS

Rated power supply: 110V, 50/60Hz

Min. Power consumption: 85W

Max. Power consumption: 275W

Dimensions: W1000×D1930×H2085(mm)

Weight: Approximately

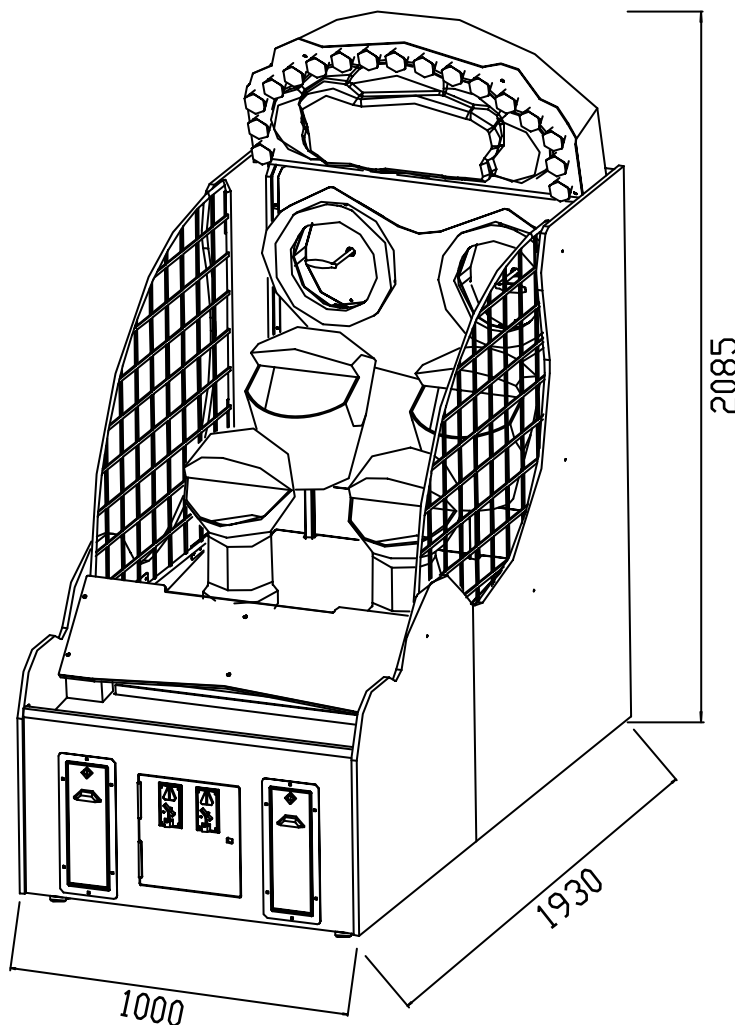

**Note:** Game parameters are subject to change without notice.

 **NOTICE:** After turning off the game, please wait at least 1 minute before restarting again.

## 2. PACKAGE CONTENTS

Open the package and make sure all the items are included:

- 1 x Body Assembly
- Following accessories

No.	Part No.	Code.	Name	Spec.	Qty.	Illustration
1	A108-427-000	23301010020	AC power	3 × 16AWG 1.8m	1	
2	A108-418-000	21901000001	Fuse	T6A/250V Φ5-20mm	2	
3	A108-701-000	41411202001	Manual	English	1	
4	A108-429-000	25300171002	Key	171	2	
5	A108-430-000	25302222002		2222	1	
6	A108-431-000	41000000114	Ball		50	
Tot.						

If any items are found to be missing, please contact your sales representative for help immediately.

**NOTE: Part models are subject to change without notice.**

### 3. PART NAMES

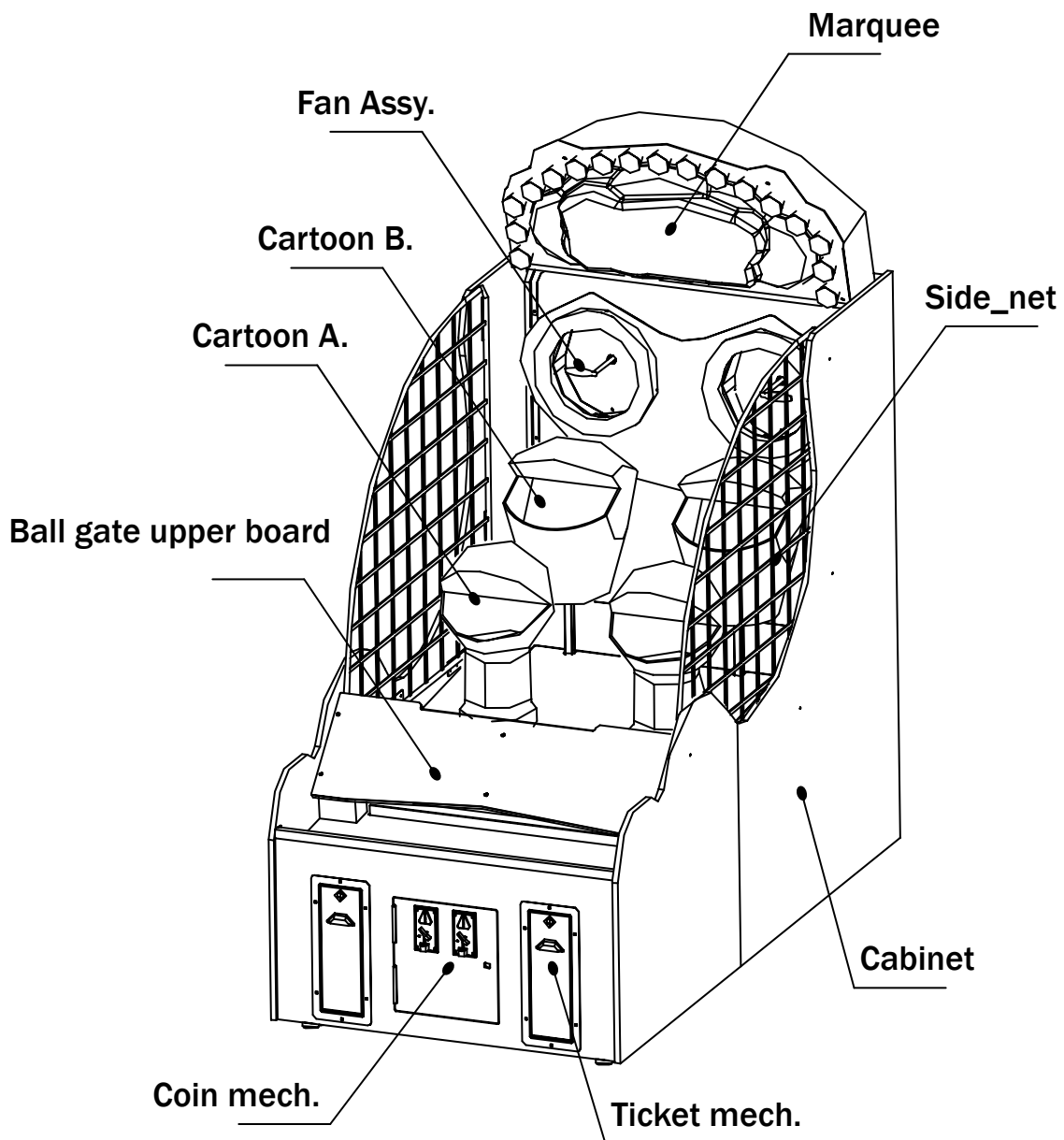

## 4. SET UP & INSTALLATION

 **This product is an indoor game machine. Do not install outdoors.**

- Refer to IMPORTANT SAFETY INSTRUCTIONS (Pg. 2) for places to avoid
- Place the unit on a dry level surface
- Ventilation openings in the back of the unit must not be obstructed by objects or by wall.

### 4.1 Play Zone

This machine requires space for playing and for maintenance as shown below.  
Leave space around the game upon installation:

Service area: 50 cm

Play area: 100 cm

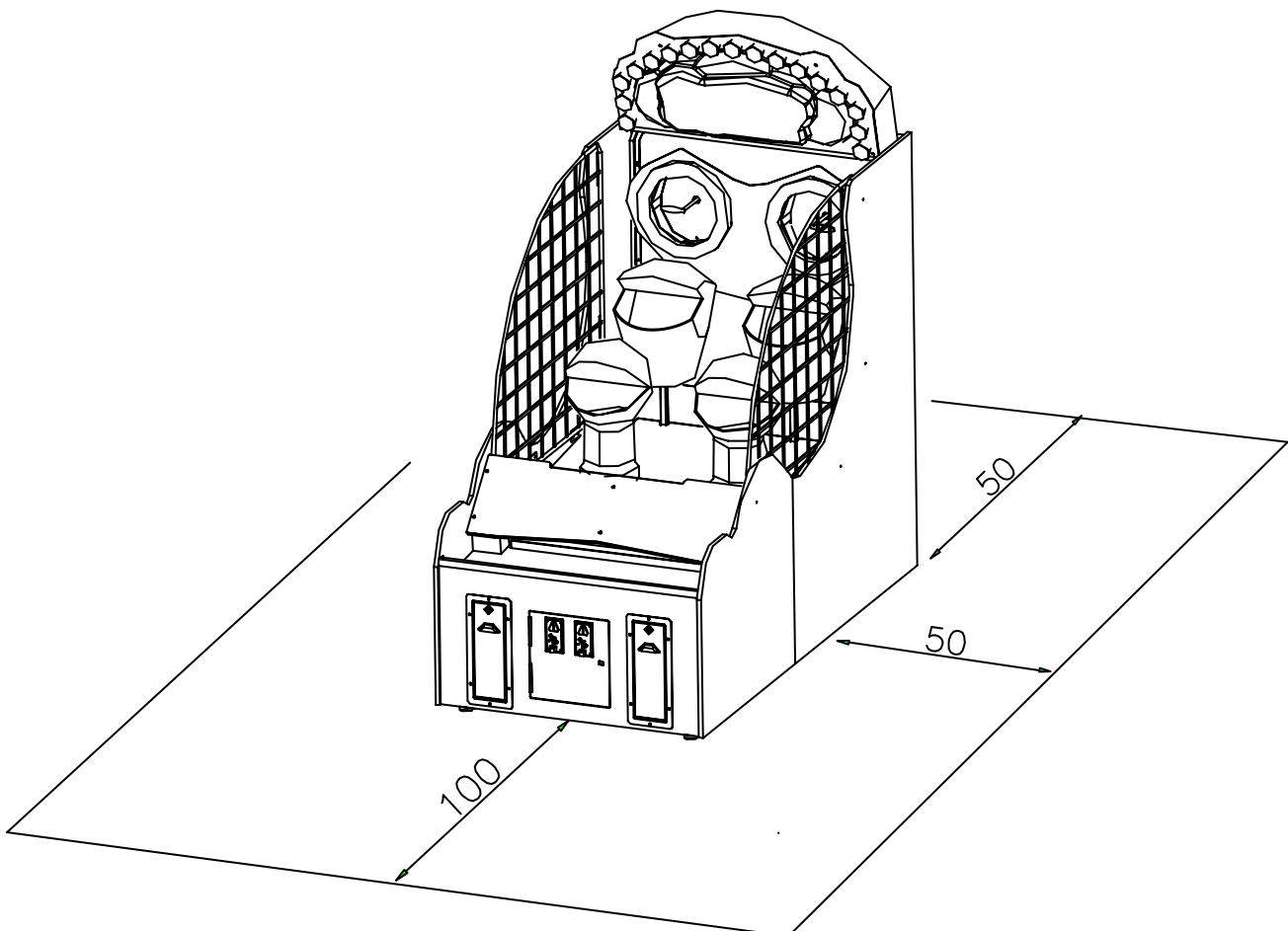





## 4.2 Level Adjustment

Install this machine on a flat surface. Adjust levers to lift casters off the ground to level the game. If the game is installed on an unsuitable floor, it could cause game malfunction.

To secure the game, adjust the Leveler down until it touches the floor, lifting the casters off the ground by 5mm. Repeat the same for all levelers.

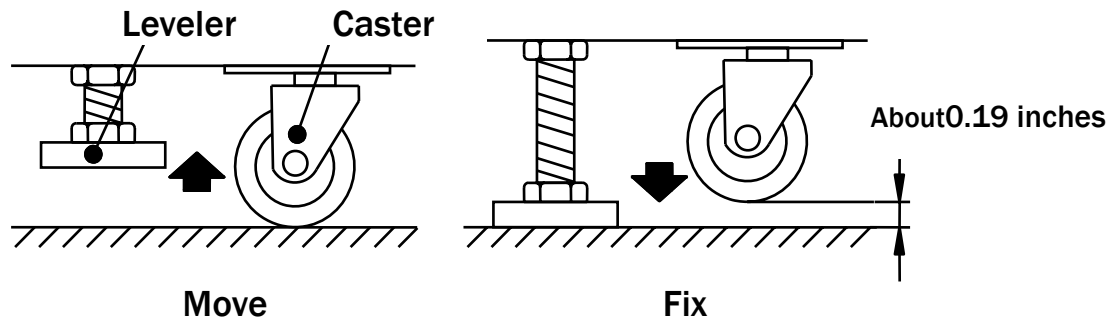

### NOTICE

Make sure the machine is level with the ground and all the adjustable legs should stick to the floor closely.

### 4.3 Transporting the Game

If you need to move the game, adjust the levelers back to an “up” position so the casters touch the ground.

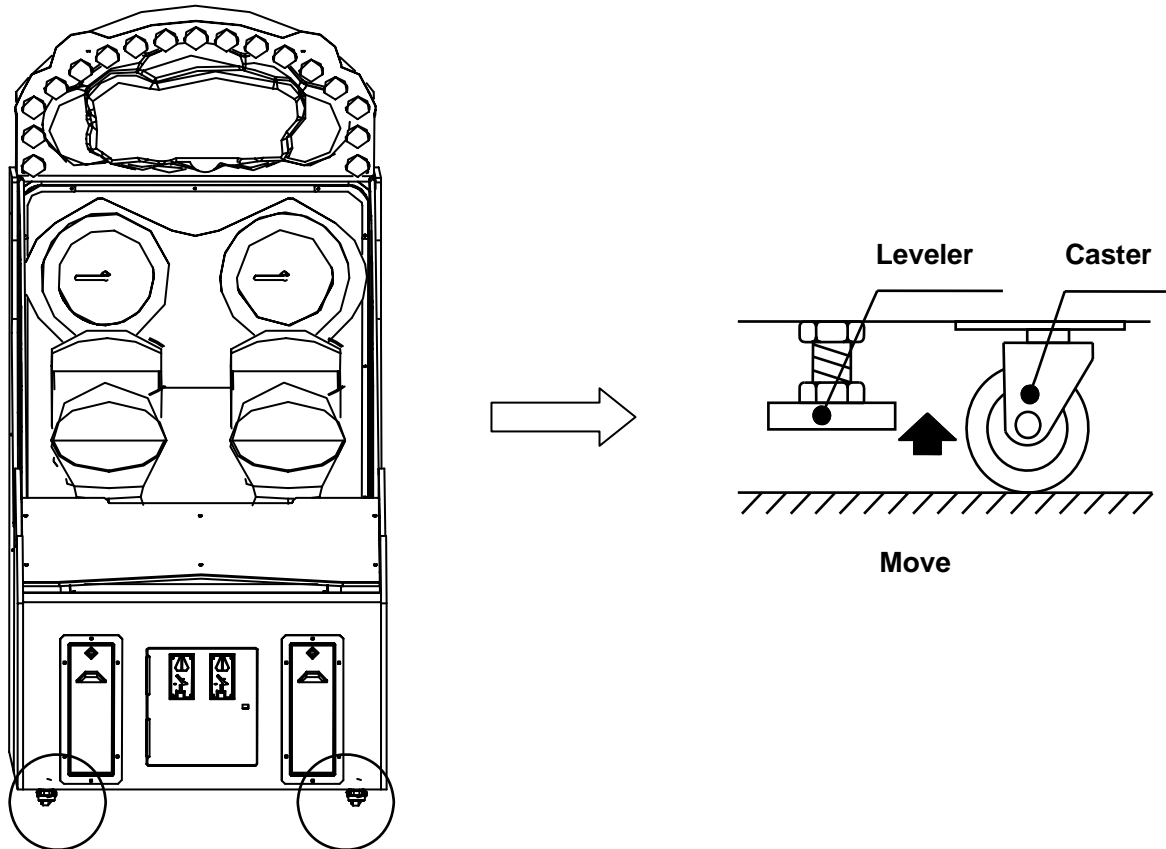

 **NOTICE**

- Be careful not to damage the machine during transport.
- The machine should be handled with care when bringing it down from a higher level.
- Always unplug the game before moving.
- Keep the machine in upright position during transport.
- For longer distance transport, package the game properly to prevent damages

## 4.4 Connecting Power

**! WARNING:** Check the voltage rating before you connect the equipment to an electrical outlet to ensure that the required voltage and frequency match the available power source. Please refer the label of the machine.

- Do not plug the equipment power cables into an electrical outlet if the power cable is damaged.
- Avoid putting many loads on one electrical outlet as it could generate heat and fire resulting from overload.
- Connect the grounding conductor to the earth terminal (GND):

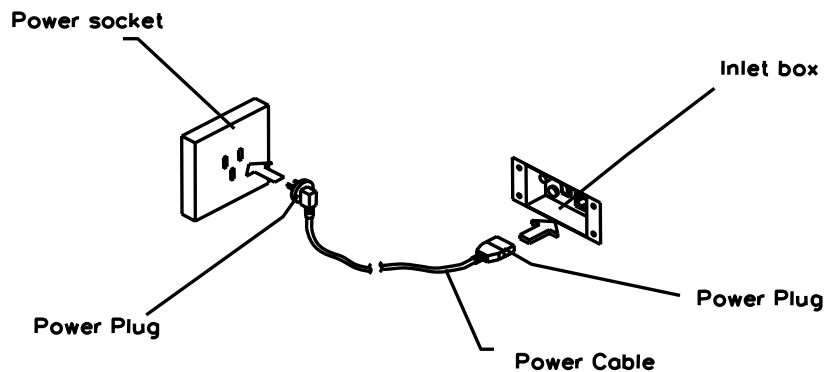

**! WARNING**

Ensure no heavy objects rest on the power cord. Check to make sure the game cabinet does not sit on the power cord as this could damage the cord and become hazardous.

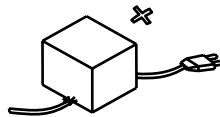

To disconnect the game, grip the plug and pull it from the wall outlet. Never pull by the cord.

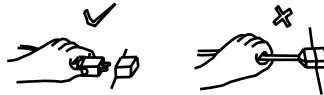

To prevent electric shock, do not touch the power plug when hand is wet.



Ensure that nothing rests on the power cord and that it is not located where it can be stepped on or tripped over.



## 5. HOW TO PLAY

# GAME PLAY

## GREETINGS EARTHLINGS!

- *THROW BALLS INTO THE MOUTHS OF THE ROBOTS OR ALIENS TO WIN TICKETS!*
- *AIM THE BALL AT THE SPACESHIP TO WIN EVEN MORE!*

### NOTICE

In the course of the game, put a ball may appear more checks, multiple scoring. In a certain range (the number of total input balls 1%~10%) is a normal phenomenon.

## 6. GAME OPTIONS

### 6.1 Switches Control Signal

Refer to the attached I/O chart and the schematic.

To adjust DIP, please refer to the I/O chart. The initial setting is in CAPITAL LETTER.

Main board :

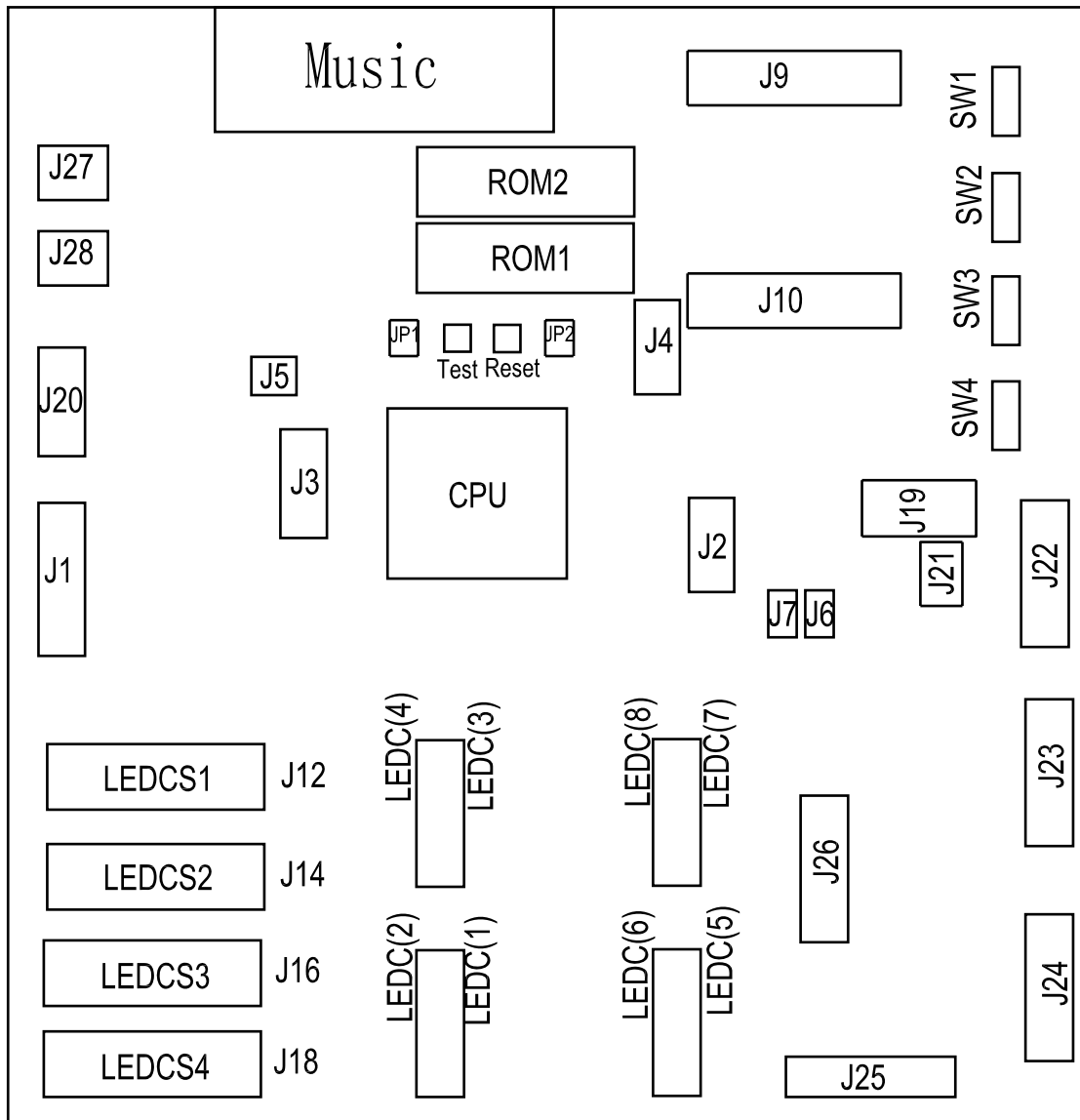

## To enter Test Mode:

Press the TEST button found on the main board.

## LED Display:

P1:Time LED<1>2-1    Score LED<1>5-3

P2:Time LED<2>2-1    Score LED<2>5-3

## Test method:

LED Test: LED displays 8.7.6.5.4.3.2.1 and 87654321 to test the LED are right or not.

Press TEST button again, display 1, LED<1>1-2 show the DIP state.

Press TEST button again, display 2, show each close SW No , double-digit is 1 SW No.:

Press TEST button again, display 3, press ticket reset/service button, test music.

## ERROR CODE:

**If any input single isn't normal, display error code, pass after alarm several times**

Error Code	Potential cause	Solution
E1	Ticket reset button error	Replace with proper reset button.
E2	Service button error	Replace with proper service button.
E3	Gate position SW error	Replace with a new ball gate switch.
E4	1P fan sensor error	Replace with a new 1P fan sensor.
	1P fan sensor is not in detect range.	Adjust the knob at the end of the sensor.
E5	1P Alien sensor fault	Replace with a new 1P alien sensor.
	1P alien sensor is not in detect range.	Adjust the knob at the end of the sensor.
E6	1P Robot sensor fault	Replace with a new 1P robot sensor.
	1P robot sensor is not in detect range.	Adjust the knob at the end of the sensor.
EA	1P coin mech. signal error	Take out the jammed coin. Replace with a new coin mech.
E7	2P fan sensor error	Refer to E4 solution
E8	2P Alien sensor error	Refer to E5 solution.
E9	2P Robot sensor error	Refer to E6 solution.
Eb	2P coin mech. signal error	Refer to EA solution



## 6.2 Parameter Setting

Default settings are in capital letters.

### DIP Adjust 1 (SW1)

#### (1) Coin per game

Item	Content	DIP Adjust (SW1)		Note
		1	2	
Coin per game	1	ON	ON	
	2	off	on	
	3	on	off	
	4	off	off	

#### (2) Play time

Item	Content	DIP Adjust (SW1)			Note
		3	4	5	
Play time	30	on	on	on	
	35	off	on	on	
	40	on	off	on	
	50	off	off	on	
	60	ON	ON	OFF	
	70	off	on	off	
	80	on	off	off	
	90	off	off	off	

#### (3) Target Point

Item	Content	DIP Adjust (SW1)		Note
		6	7	
Target Point	Group1	on	on	
	Group2	OFF	ON	
	Group3	on	off	
	Group4	off	off	

#### (4) Score memory

Item	Content	DIP Adjust (SW1)	Note
		8	
Score memory	Yes	ON	
	No	off	

## DIP Adjust 2 (SW2)

### (5) Score table

Item	Content	DIP Adjust (SW2)				Note
		1	2	3	4	
Score table	Group 1	on	on	on	on	
	Group 2	off	on	on	on	
	Group 3	on	off	on	on	
	Group 4	off	off	on	on	
	Group 5	on	on	off	on	
	<b>Group 6</b>	<b>OFF</b>	<b>ON</b>	<b>OFF</b>	<b>ON</b>	
	Group 7	on	off	off	on	
	Group8	off	off	off	on	
	Group9	on	on	on	off	
	Group10	off	on	on	off	
	Group11	on	off	on	off	
	Group12	off	off	on	off	
	Group13	on	on	off	off	
	Group14	off	on	off	off	
	Group15	on	off	off	off	
	Group16	off	off	off	off	

### (6) Demo music, demo action

Item	Content	DIP Adjust (SW2)				Note
		5	6	7	8	
Demo music	NO		on	on		
	<b>2min</b>		<b>OFF</b>	<b>ON</b>		
	3min		on	off		
	4min		off	off		
Demo action	<b>Yes</b>				<b>ON</b>	
	No				off	
		<b>ON</b>				





**SW3\_DIP adjust**

Item	Content	1	2	3	4	5	6	7	8
Play mode	L&R separate								ON
	L&R cooperate								off
		ON	ON	ON	ON	ON	ON	ON	

**SW4\_DIP adjust**

Item	Content	1	2	3	4	5	6	7	8
		ON	ON	ON	ON	ON	ON	ON	ON

**Target Point setting:**

Target	Robots	Aliens	Fan
Group1	1 point	2 points	4 points
Group2	2 points	4 points	8 points
Group3	4 points	8 points	16 points
Group4	10 points	20 points	50 points

**Score table**

Score	0-150	151-300	301-500
Group1	0 tickets	0 tickets	0 tickets
Group2	1 tickets	2 tickets	3 tickets
Group3	2 tickets	4 tickets	6 tickets
Group4	4 tickets	4 tickets	4 tickets
Group5	5 tickets	5tickets	5tickets
Group6	5 tickets	8 tickets	12 tickets
Group7	8 tickets	12 tickets	18 tickets
Group8	15 tickets	20 tickets	25 tickets
Group9	20 tickets	25 tickets	30 tickets
Group10	22 tickets	30 tickets	35 tickets
Group11	30 tickets	40 tickets	50 tickets
Group12	40 tickets	50 tickets	60 tickets
Group13	45 tickets	60 tickets	70 tickets
Group14	10 tickets	16 tickets	20 tickets
Group15	20 tickets	32 tickets	40 tickets
Group16	10 tickets	10 tickets	10 tickets

**Input & output parts:**

**Input part:**

INPUT	CONTENT
J9-1	Ticket reset
J9-2	Service button
J9-3	Gate position
J9-4	1P sensor down
J9-5	1P sensor M
J9-6	1P sensor up
J9-7	2P sensor down
J9-8	2P sensor Middle
J9-9	2P sensor up

**Output part**

OUTPUT	CONTENT	OUTPUT	CONTENT	OUTPUT	CONTENT
J22-1	1P motor	J23-9	1P mouth light	J4-1	SCLK
J22-2	2P motor	J23-10	1P side light	J4-2	
J22-3	1P indicator	J23-11	2P mouth light	J4-3	LAT marquee
J22-4	2P indicator	J23-12	2Pside light	J4-4	CLOCK marquee
J22-5	1P up light	J23-13	Gate motor	J4-5	DATA marquee
J22-6	2P up light	J23-14	1Pmouth down light	J4-6	LAT
J22-7		J23-15	2P mouth down light	J4-7	CLOCK
J22-8		J23-16		J4-8	DATA



**Notice**

The above are subject to change without notice.



## 7. MAINTENANCE, INSPECTION

### 7.1 Safety Check

Check the points listed before operating the machine. These checks are necessary for safe machine operation:

1. Try to run the game before operation each day.
2. Conduct monthly routine checks of game components ensure good working condition
3. Check the machine regularly for dust and clean when necessary.

**Note:** Parts and components require preventative maintenance to be kept running smoothly

### 7.2 Handling Precautions

When installing or inspecting the machine, be very careful of the following points and pay attention to ensure that the player can enjoy the game safely.

Non-compliance with the following points or inappropriate handling running counter to the cautionary matters herein stated can cause personal injury or damage to the machine



#### WARNING

- Before servicing the machine, be sure to turn power off. Servicing without turning the power off can cause electric shock or short circuit.
- To avoid electric shock or short circuit, do not plug then unplug the power quickly
- Do not expose power cords and earth wires, these are susceptible to damage.
- Damaged cords and wires can cause electric shock or short circuit and should be replaced immediately.
- When or after installing the product, avoid pulling the power cord to prevent unnecessary wear and tear. Use the power button to disconnect power.
- In case the power cord is damaged, ask for replacement through where the product was purchased from or replace locally. Continued usage of damaged cord can cause fire, electric shock or leakage.
- Perform grounding appropriately. Inappropriate grounding can cause electric shock.
- Use fuses that meet specified rating. Fuses exceeding can cause an electric shock.
- Should a problem occur, turn off the power immediately and stop operating the machine. Unplug the power cord of the service outlet. Operating the machine without correcting the problem may cause a fire or injuries.
- Insert the power plug securely into the outlet. Poor contact may cause overheating, resulting in fire or burns.
- To ensure the warning labels attached on the machine are visible and legible, install the machine in a well-lit location, and keep the labels clean at all times. Make sure the labels are not hidden behind other game machines.

# 8. OVERALL CONSTRUCTION

## 8.1 Main Assembly 1:

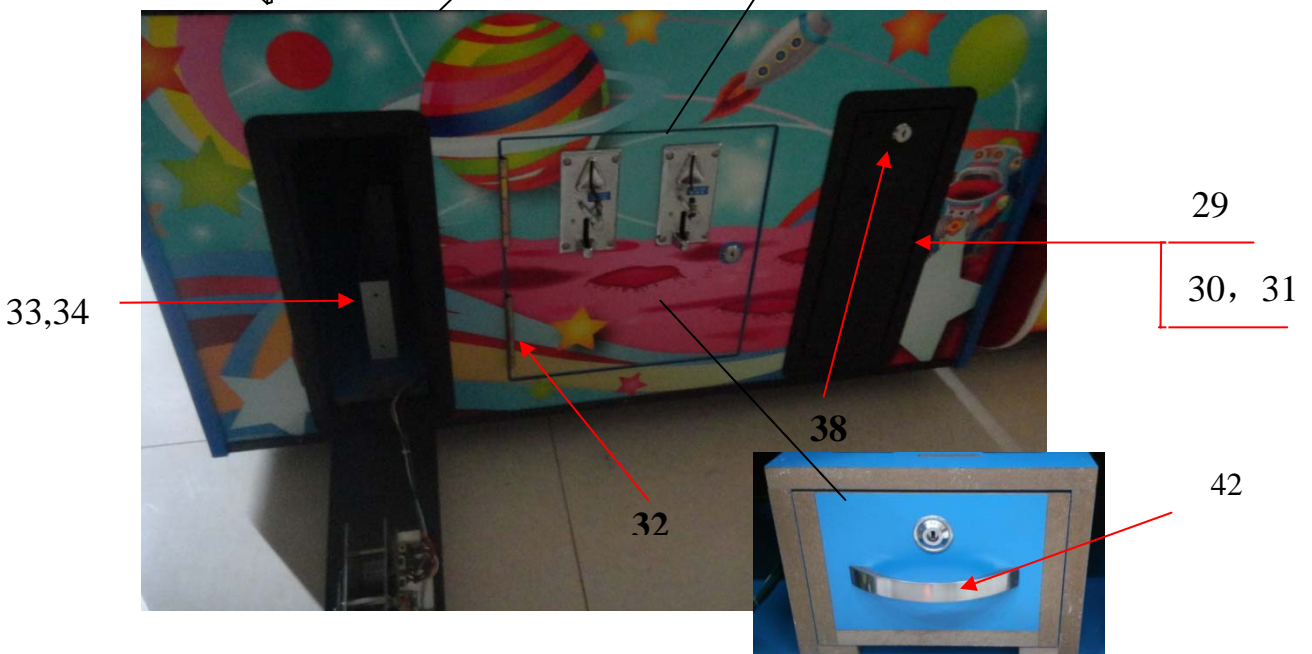
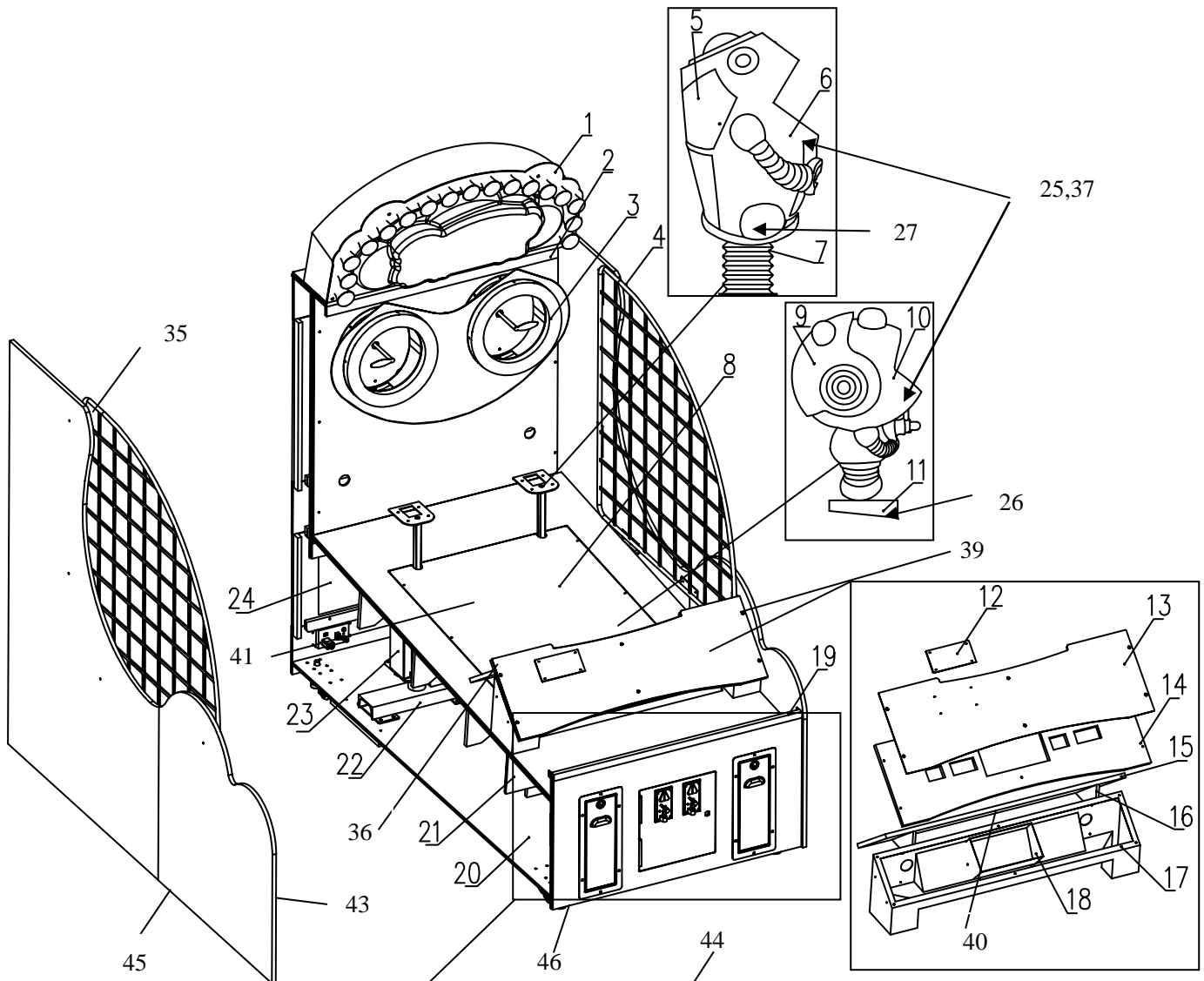



No.	Part No.	Code	Name	Qty.
1	A108-001-000	29911202003	Marquee assy.	1
2	A108-101-000	20611202001	Score board	1
3	A108-002-000	29911202007	Fan Assy.	1
4	A108-102-000	20211202001	L_net frame	1
5	A108-601-000	20411202004	Cartoon B back cover	2
6	A108-602-000	20411202002	Cartoon B	2
7	A108-103-000	20211202006	Decorative ring assy.	2
8	A108-501-000	20311202021	Active plate	1
9	A108-603-000	20411202003	Cartoon A hat	2
10	A108-604-000	20411202001	Cartoon A	2
11	A108-104-000	20211202008	Cartoon seat	2
12	A108-105-000	20211202004	Tube baffle	1
13	A108-711-000	20511202002	Control panel decal	1
14	A108-502-000	20311202001	Digital board	1
15	A108-710-000	20511202A010	Baffle ball plate(inside)	1
16	A108-106-000	20211202005	Baffle ball plate	2
17	A108-107-000	20211202003	Console frame	1
18	A108-108-000	20211202009	Console frame(inside)	1
19	A108-109-000	20211202007	Layering	1
20	A108-003-000	29911202002	cabinet	1
21	A108-004-000	29911202004	Ball gate Assy.	1
22	A108-005-000	29911202005	L&R swing Assy.	2
23	A108-006-000	29911202006	U&D swing Assy.	2
24	A108-007-000	20611202003	Assy. Protect board	1
25	A108-150-000	20211202047	Sensor detection frame	2
26	A108-151-000	20211202046	Embedded part A	1
27	A108-152-000	20211202048	Embedded part B	1
29	A108-153-000	29911202001	Ticket door assy.	2
30	A108-154-000	26000018001	Door frame	2
31	A108-155-000	26000018002	Ticket door	2
32	A108-156-000	26000018003	Hinge	2
33	A108-157-000	26000007000	Ticket box 120	2
34	A108-158-000	20211202A101	Owed ticket light socket	2
35	A108-159-000	20211202002	R_net frame	1
36	A108-193-000	20311202002	Ball inner board	1
37	A108-194-000	21501000014	Sensor	6
38	A108-197-000	20211202013	Lock pin 171	2
39	A108-198-000	26000040000	5mm screw washer	6
40	A108-508-000	22002013004	LED light strip	0.55m
41	A108-509-000	20611202004	Shock piece	2
42	A108-510-000	25102000007	Stainless steel handle	1
43	A108-511-000	40501000011	T-molding (blue)	11.6m
44	A108-512-000	40501000021	T-molding (black)	8.86m
45	A108-513-000	20211202011	Cabinet T-molding B	2
46	A108-514-000	20211202010	Cabinet T-molding A	2

## 8.2 Wooden Cabinet:

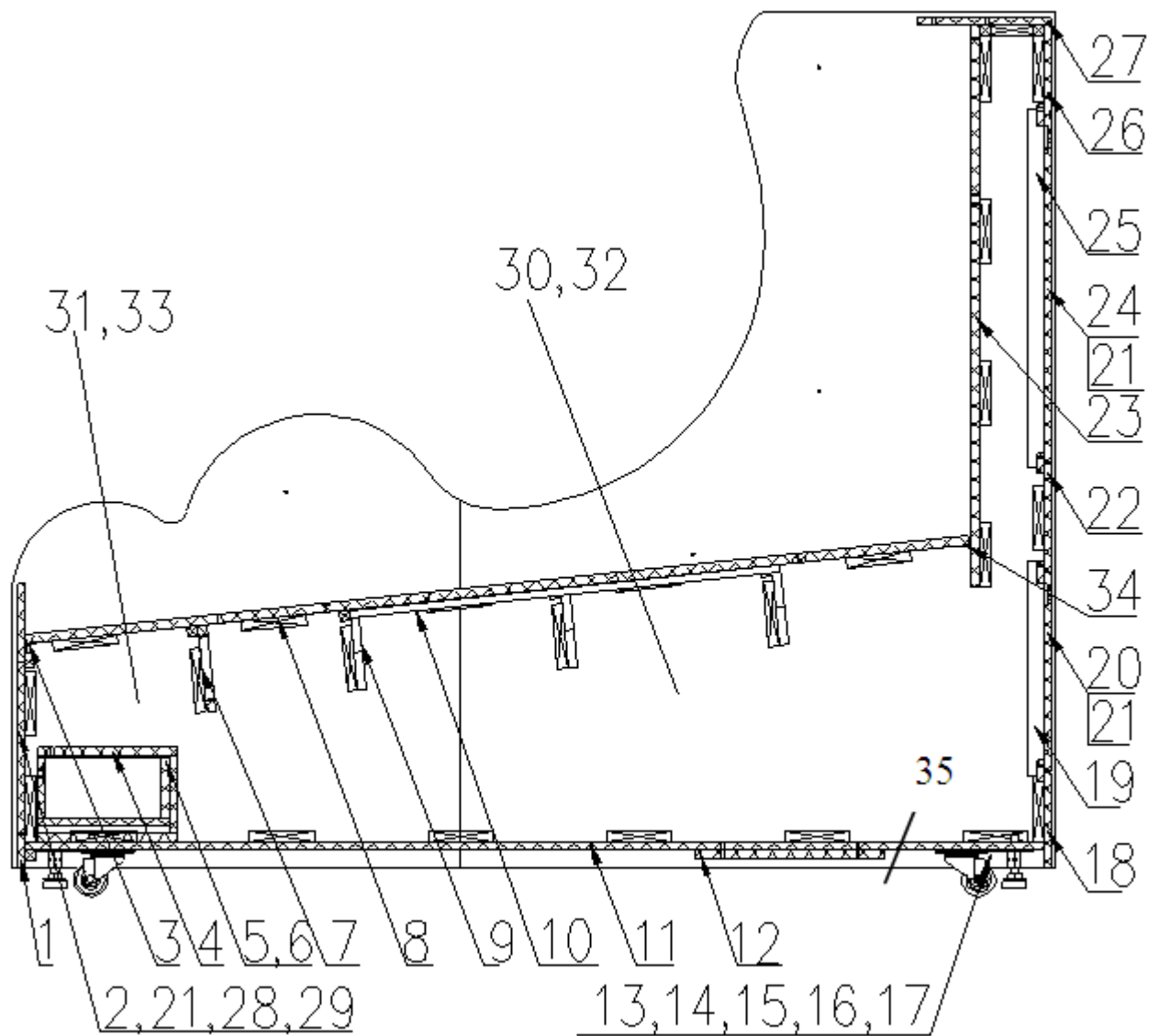



No.	Part No.	Code	Name	Qty.
1	A108-160-000	20311202008	Front door frame	1
2	A108-161-000	20311202010	Moving door board	1
3	A108-162-000	20211202014	Fixed bar A	1
4	A108-163-000	20311202011	Coin outer box	1
5	A108-164-000	20311202025	Funnel	1
6	A108-165-000	25302222001	Lock 2222	1
7	A108-166-000	20311202020	Gate mechanism fix frame	1
8	A108-167-000	20311202019	Fairway board	1
9	A108-168-000	20311202022	Fixed support board	2
10	A108-501-000	20311202021	Active plate	1
11	A108-169-000	20311202A003	Bed plate	1
12	A108-170-000	20311202012	Moving mechanism pad	1
13	A108-171-000	25501000056	2.5" castor	4
14	A108-302-000	20104020014	Hexagon nut M16	4
15	A108-172-000	26000010000	2.5" castor support frame	4
16	A108-173-000	26000008000	2.5" leveler	4
17	A108-303-000	20104020004	Cross recessed hexagon head kit screws	32
18	A108-174-000	20311202009	Power board	1
19	A108-175-000	20311202024	Down door bar	2
20	A108-176-000	20311202013	Back down door	1
21	A108-177-000	25300171001	171A lock	2
22	A108-178-000	20311202014	Back down fixed board	1
23	A108-179-000	20311202018	Main panel board	1
24	A108-180-000	20311202015	Back up door	1
25	A108-181-000	20311202023	Up door bar	2
26	A108-182-000	20311202016	Back up fixed board	1
27	A108-183-000	20311202017	Marquee base board	1
28	A108-184-000	26300000001	4" hinge	2
29	A108-185-000	20211202016	Lock pin	3
30	A108-186-000	20311202A004	Left rear side plate	1
31	A108-187-000	20311202A005	Left front side plate	1
32	A108-188-000	20311202A006	Right rear side plate	1
33	A108-189-000	20311202A007	Right front side plate	1
34	A108-190-000	20211202015	Fixed bar B	1
35	A108-196-000	35201001	wooden block	8.5



### 8.3 Marquee Assembly.:

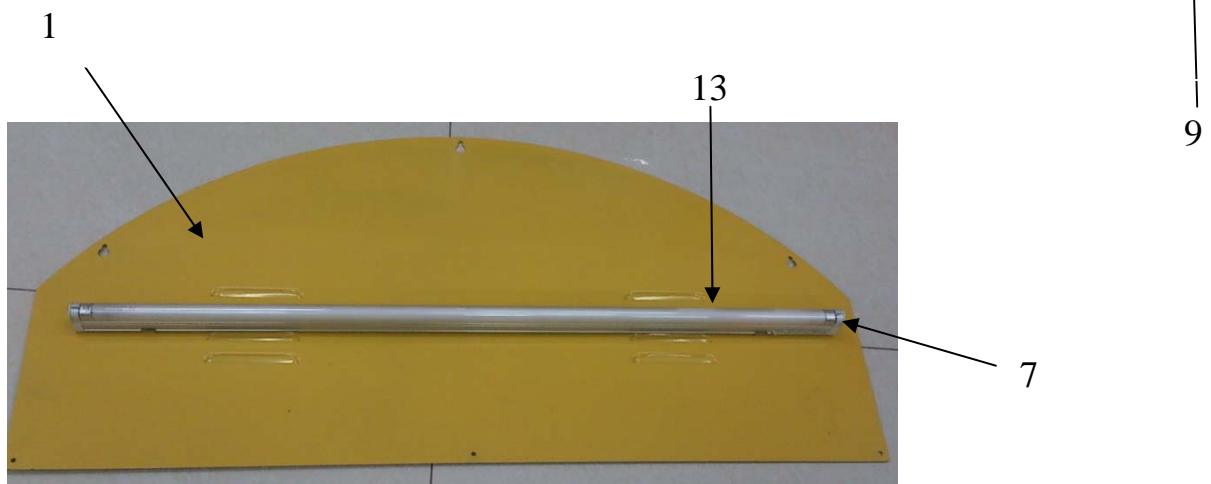
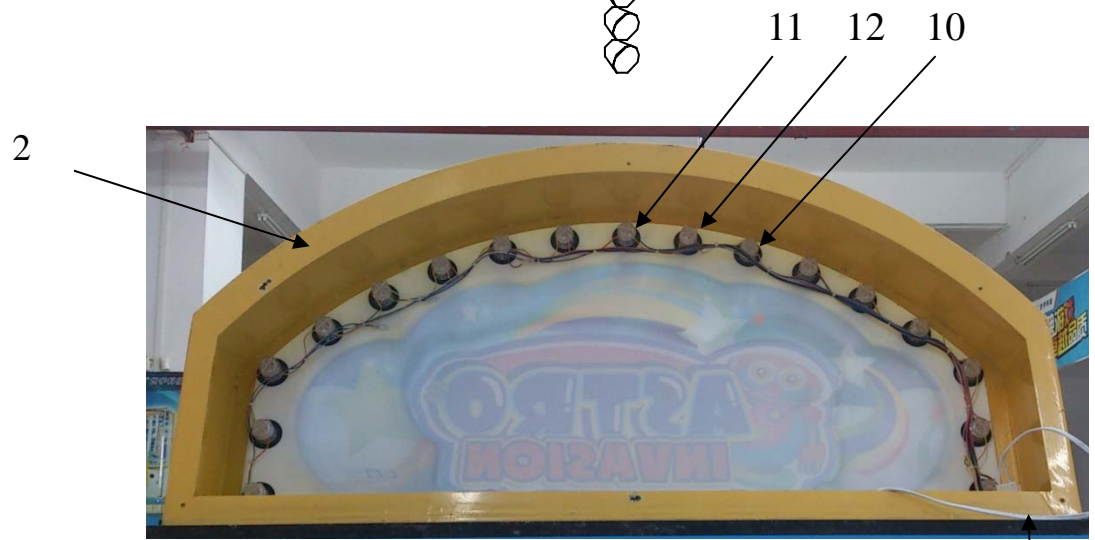
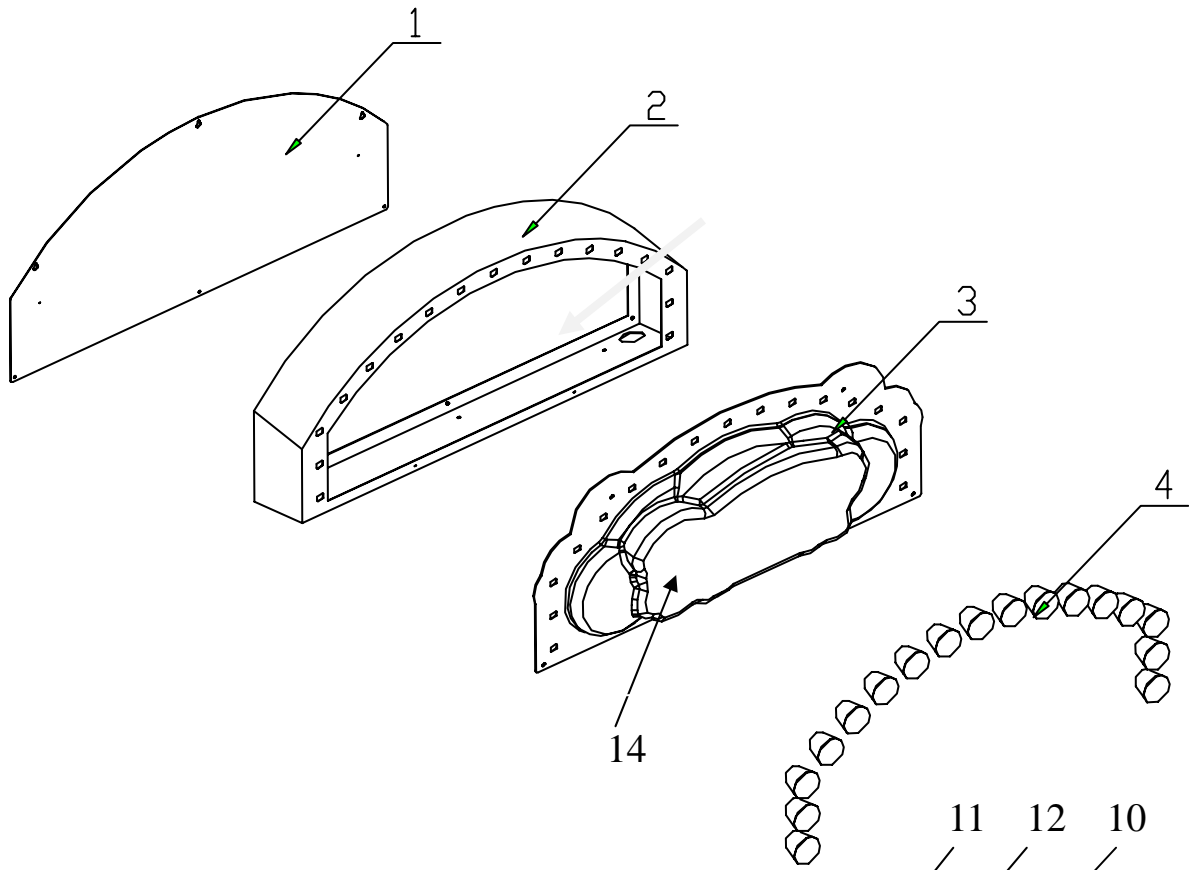



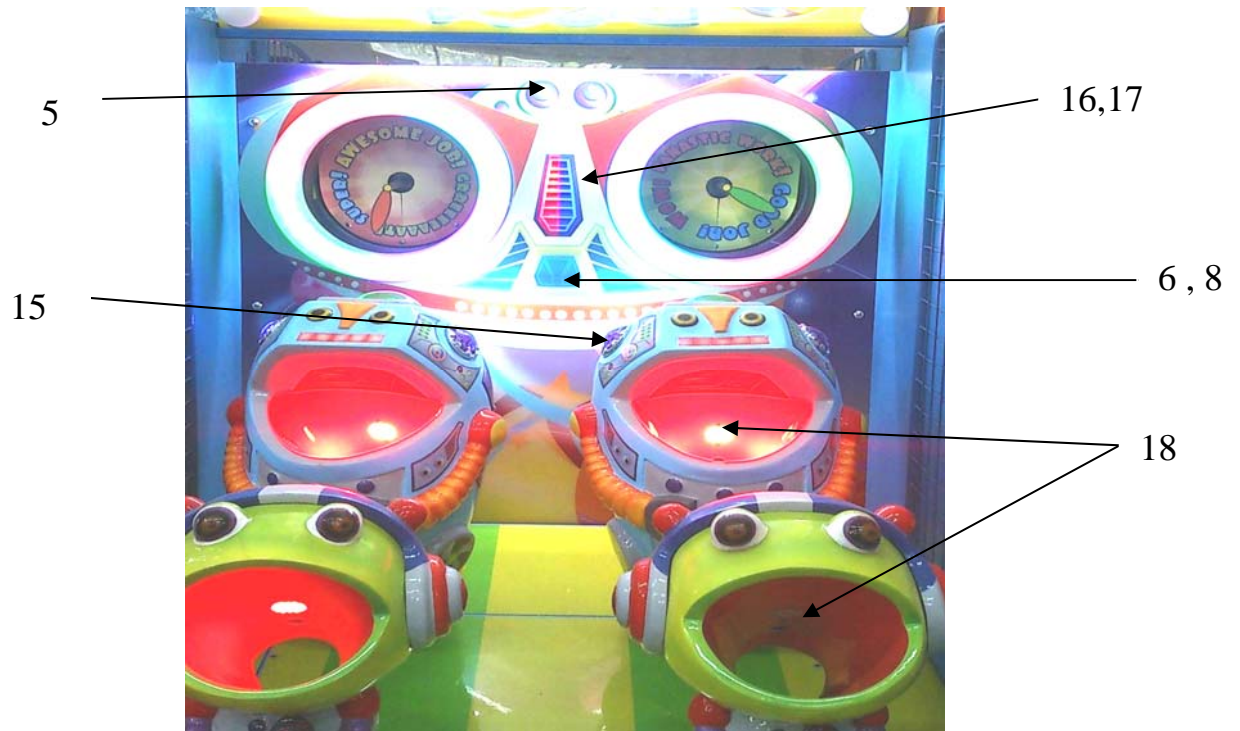

No.	Part No.	Code	Name	Qty.
1	A108-110-000	20211202018	Back cover plate	1
2	A108-111-000	20211202017	Marquee	1
3	A108-605-000	20511202004	Plastic marquee	1
4	A108-401-000	22200000012	Lamp-chimney	17
5	A108-460-000	22006000056	T5-13W light tube(UL certification)	1
6	A108-461-000	22006000002	T5-6W(110V) light tube	2
7	A108-462-000	22006000053	T5-21W light tube(UL certification)	1
8	A108-433-000	23301000056	T5 tube connected cable	3
9	A108-434-000	23301000053	T5 tube connected cable	2
10	A108-435-000	22003000021	LED light -white	6
11	A108-436-000	22003000022	LED light -purple	5
12	A108-437-000	22003000023	LED light - yellow	6
13	A108-438-000	MH XK-02-03	Light pad plate	1
14	A108-304-000	20101100024	Cross recessed pan head screws	4
15	A108-504-000	22003060006	Purple flower light	4
16	A108-505-000	29711202002	Light board - red	1
17	A108-506-000	29711202001	Light board - blue	1
18	A108-507-000	20740930001	Target PCB	6

### 8.4 Fan Assembly.:

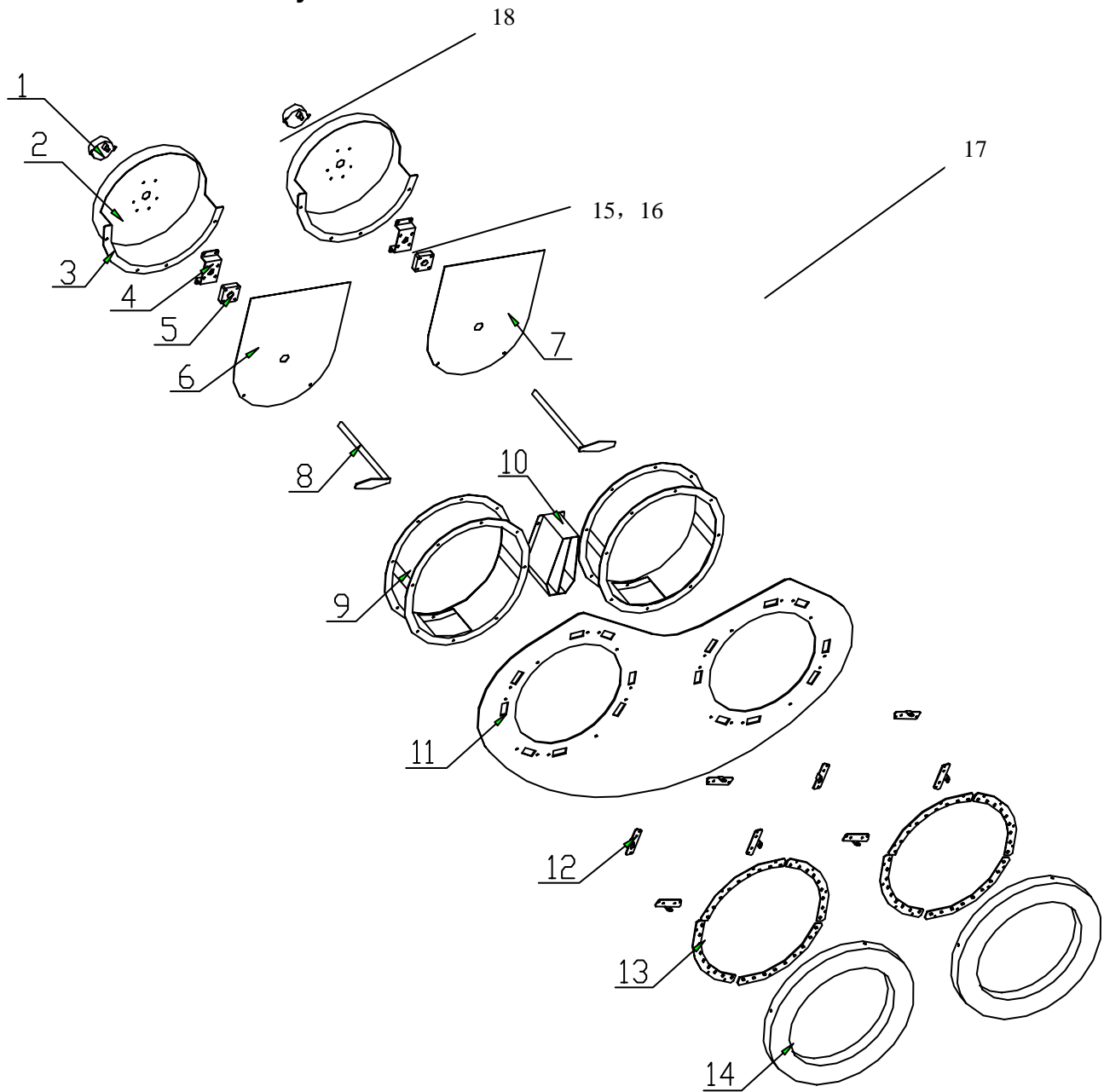



No.	Part No.	Code	Name	Qty.
1	A108-402-000	23406000015	Synchronous motor	2
2	A108-112-000	20211202043	Buffer frame	2
3	A108-113-000	20211202040	Canvas stick board	2
4	A108-114-000	20211202041	Bearing frame	2
5	A108-403-000	20106000167	Bearing	2
6	A108-707-000	20511202014	L_baffle ball cloth	1
7	A108-708-000	20511202015	R_baffle ball cloth	1
8	A108-115-000	20211202A039	Fan shaft	2
9	A108-116-000	20211202036	Fan wheel	2
10	A108-117-000	20211202038	Nose frame	1
11	A108-709-000	20511202003	Airship	1
12	A108-118-000	20211202037	Hot wheel frame	8
13	A108-801-000	20711012001	Lamp board	8
14	A108-119-000	20611202006	Hot wheel	2
15	A108-191-000	20211202042	Bearing block	2
16	A108-192-000	MHXK-06-11	Bearing block A	2
17	A108-195-000	29911202007	Fan Assy.	1
18	A108-503-000	20611202007	Buffer block	2

## 8.5 Ball Gate Assembly:

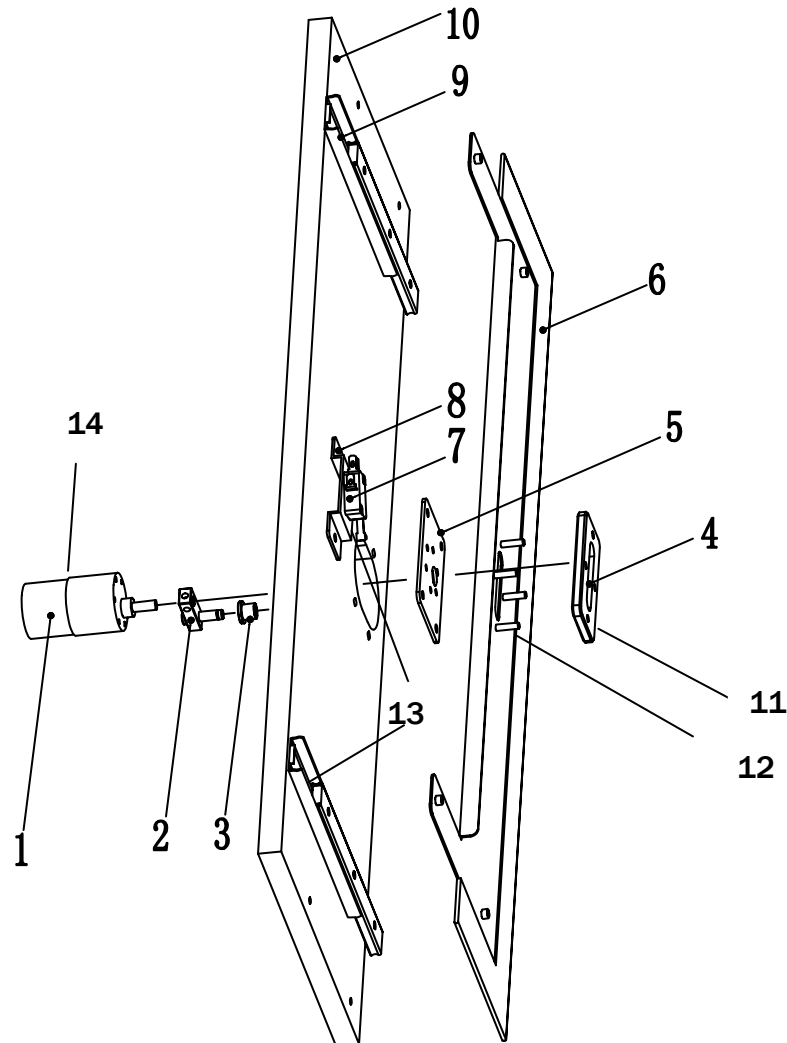

No.	Part No.	Code	Name	Qty.
1	A108-403-000	23404000047	DC motor	1
2	A108-120-000	20211202020	Crank C	1
3	A108-404-000	20106090135	Bearing with flange	1
4	A108-121-000	20611202005	Moving board Block	1
5	A108-122-000	20211202019	Motor fixation board	1
6	A108-123-000	20211202021	Fixation board	1
7	A108-405-000	22604000007	Micro. SW	1
8	A108-124-000	20211202022	SW bracket	1
9	A108-406-000	25105000006	Guide track	2
10	A108-125-000	20311202026	Ball gate board	1
11	A108-305-000	20102020011	Hexagon flange nut	4
12	A108-306-000	20101010170	Hexagon screw	2
13	A108-307-000	20101000021	Cross recessed pan head screws	2
14	A108-308-000	20101020033	Cross recessed pan head kit screws	3

### 8.6 Left & Right Swing Assembly:

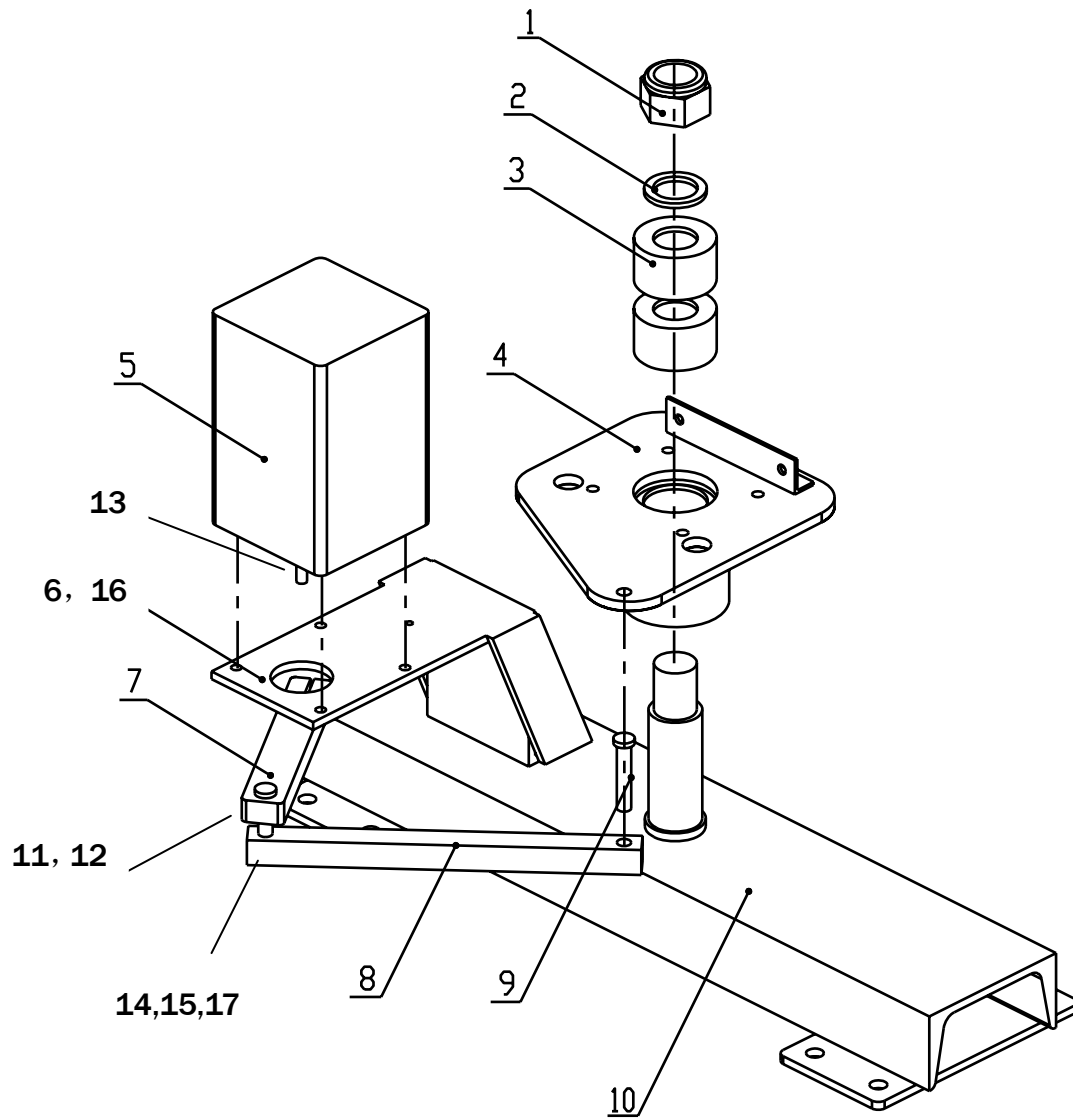

No.	Part No.	Code	Name	Qty.
1	A108-301-000	20102000021	Nut	1
2	A108-126-000	20211202026	Washer	1
3	A108-407000	20106000120	Bearing	2
4	A108-127-000	20211202024	Rotation pole	1
5	A108-408-000	23405000119	single-phase Motor	1
6	A108-128-000	20211202025	Motor holder	1
7	A108-129-000	20211202028	Rocker arm A	1
8	A108-130-000	20211202027	Connect pole A	1
9	A108-409-000	20106080305	Bearing	2
10	A108-131-000	20211202023	Assy. install bracket	1
11	A108-309-000	20104020006	Philips hexagonal head bolt suite	1
12	A108-310-000	20102000023	Non-metal hexagon lock tight nut	3
13	A108-320-000	20101020042	cross recessed pan head bolt suite	4
14	A108-311-000	20102020007	Hexagon nut with flange	2
15	A108-312-000	20104000033	Hexagon bolt	2
16	A108-319-000	20101020147	Cross recessed pan head kit screws	3
17	A108-313-000	20113000051	C class flat washer	3

## 8.7 Up and Down Swing Assembly:

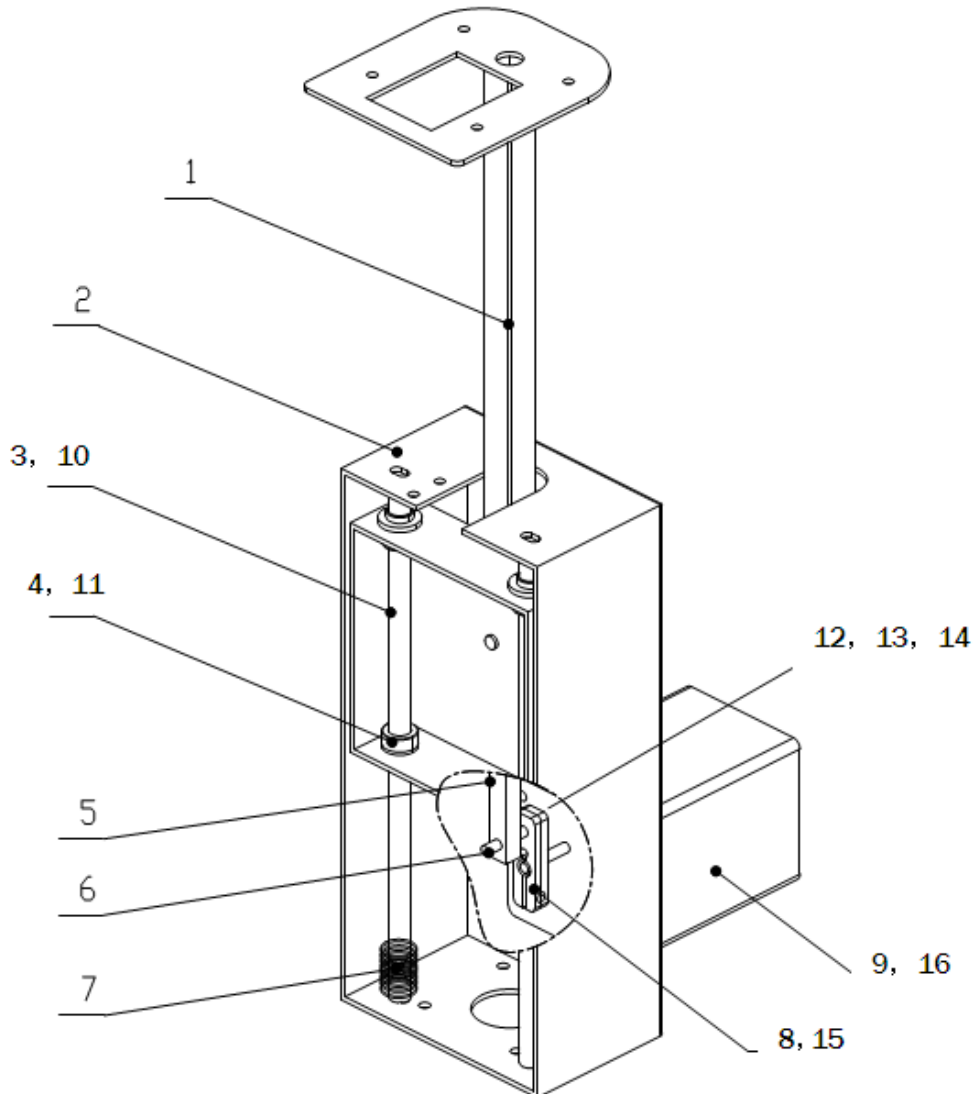

No.	Part No.	Code	Name	Qty.
1	A108-132-000	20211202035	Moving pole	1
2	A108-133-000	20211202034	Support seat	1
3	A108-134000	20211202030	Guide track	2
4	A108-135-000	20211202033	sleeve	1
5	A108-136-000	20211202031	Connect pole B	1
6	A108-410-000	20106080161	Bearing	1
7	A108-411-000	20211202029	Spring	1
8	A108-137-000	20211202032	Rocker arm B	1
9	A108-412-000	23405000092	Motor	2
10	A108-314-000	20101020046	Cross recessed pan head screws suit	4
11	A108-315-000	20105010033	A type circlip for shaft	4
12	A108-316-000	20101040148	Cross recessed pan head kit	2
13	A108-317-000	20102040003	Non-metal hexagon lock tight nut	4
14	A108-318-000	20113000053	C class flat washer	2
15	A108-319-000	20101020147	Cross recessed pan head kit screws	1
16	A108-320-000	20101020042	Cross recessed pan head bolt suite	1

### 8.8 Counter & Wire box:

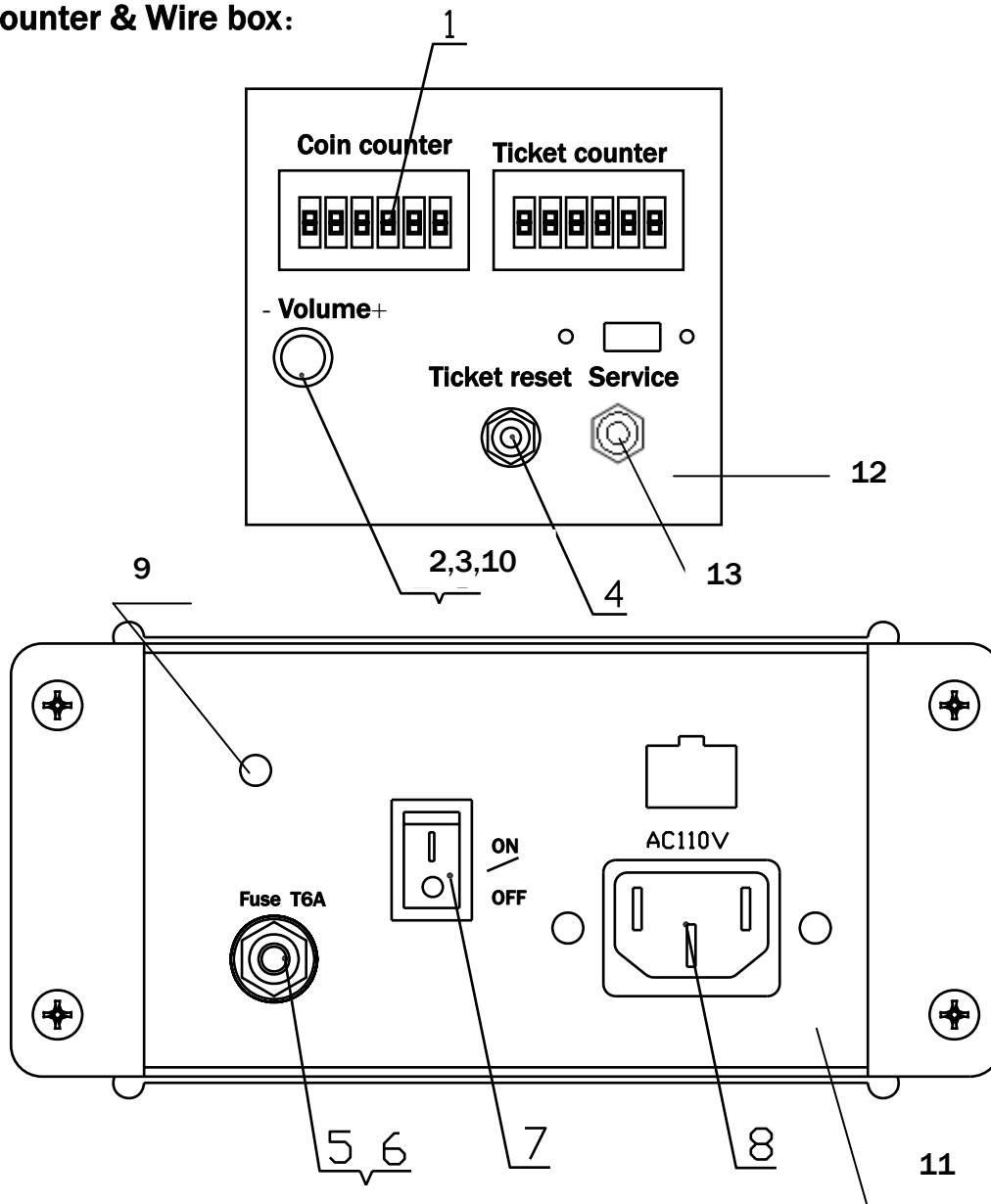

No.	Part No.	Code	Name	Qty.
1	A108-413-000	23000000005	Counter	2
2	A108-414-000	22403000001	Pot. knob	1
3	A108-415-000	21709000002	Pot. Connected board	1
4	A108-416-000	22402030001	Ticket reset button	1
5	A108-418-000	21901000001	T6A 250VAC Fuse	1
6	A108-419-000	21902000006	Fuse holder	1
7	A108-420-000	22601000005	Rocket SW	1
8	A108-421-000	23200000001	Noise filter	1
9	A108-439-000	21412000001	Terminal	1
10	A108-440-000	22501000017	POT	1
11	A108-441-000	26000005000	Wire box	1
12	A108-442-000	26000002000	Counter plate A	1
13	A108-417-000	22402010001	Service button	1



### 8.9 Electrical Parts:

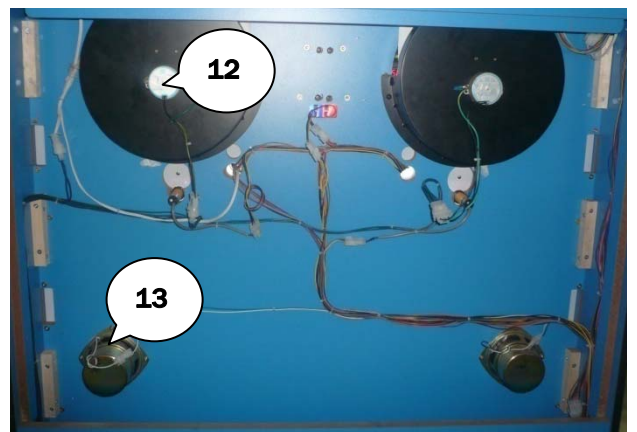
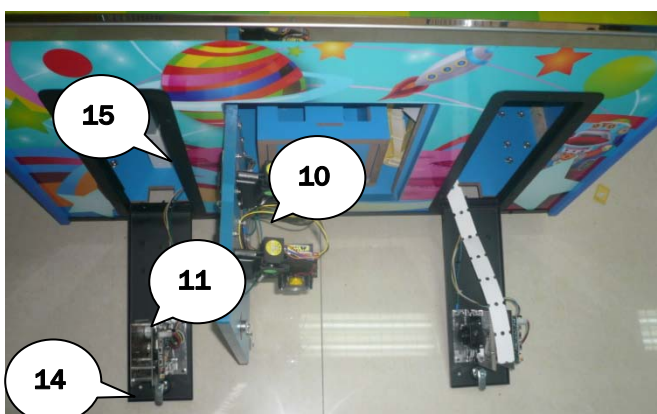

No.	Part No.	Code	Name	Qty.
1	A108-408-000	23405000119	Single -phase Motor	2
2	A108-412-000	23405000092	AC motor	2
3	A108-802-000	21701000014	Main board	1
4	A108-422-000	22140000002	Solid state relay	2
5	A108-423-000	21602000001	Power supply	1
6	A108-803-000	20741019001	PCB board	1
7	A108-804-000	21704000213	Marquee control board	1
8	A108-805-000	21706000050	1.5" Two digital board	2
9	A108-806-000	21706000032	1.5" Three digital board	2
10	A108-424-000	22301000001	Coin mech.	2
11	A108-425-000	23100000005	Ticket mech.	2
12	A108-402-000	23406000015	Synchronous motor	2
13	A108-426-000	22801000005	Speaker	2
14	A108-443-000	22003000075	Red light with socket	2
15	A108-444-000	21712000001	Ticket converted board	2
16	A108-445-000	26000032000	PC power fixed bracket	1
17	A108-446-000	20211202012	Relay bracket	1
18	A108-447-000	20611202002	Protected cover A	1
19	A108-448-000	23301050001	Power cord	1

### 8.10 Game Decals:

Front :

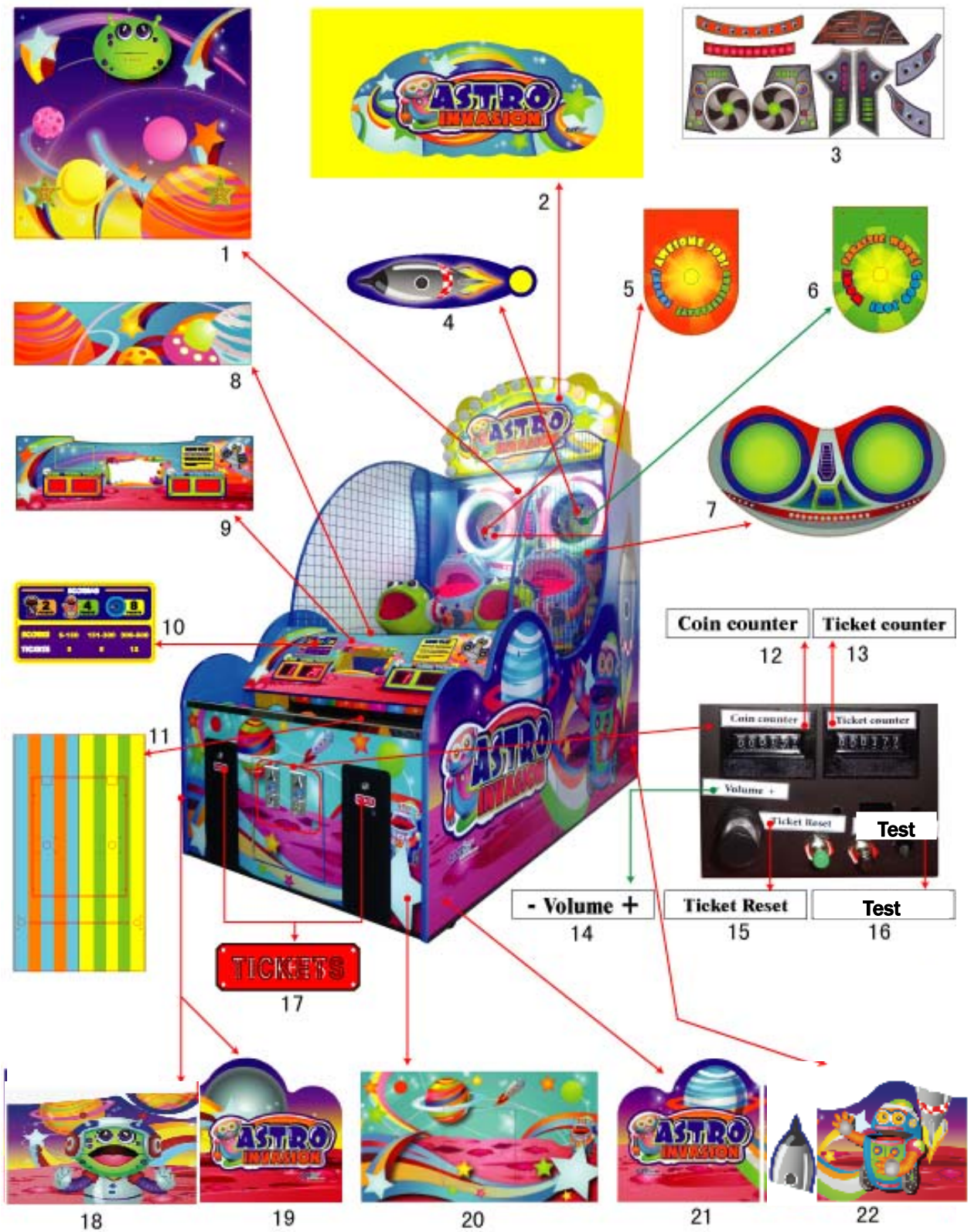



No.	Part No.	Code	Name	Qty.
1	A108-703-000	20511202001	Main decal	1
2	A108-704-000	20511202004	Plastic marquee	1
3	A108-705-000	20511202016	FRP decal	1
4	A108-706-000	20511202005	Fan shaft decal	2
5	A108-707-000	20511202014	L_baffle ball cloth	1
6	A108-708-000	20511202015	R_baffle ball cloth	1
7	A108-709-000	20511202003	Airship decal	1
8	A108-710-000	20511202A010	Baffle decal(inside)	1
9	A108-711-000	20511202002	Control panel decal	1
10	A108-712-000	20511202012	Ticket illustrate decal	1
11	A108-713-000	20511202A013	Fairway decal	1
12	A108-714-000	25600000001	Coin counter decal	1
13	A108-715-000	25600000002	Ticket counter decal	1
14	A108-716-000	25600000003	Volume decal	1
15	A108-717-000	25600000008	Ticket reset decal	1
16	A108-741-000	25600000005	Test button decal	1
17	A108-719-000	25600000034	Ticket payout decal	2
18	A108-720-000	20511202A007	Side rear decal - L	1
19	A108-721-000	20511202A006	Side front decal - L	1
20	A108-722-000	20511202A011	Front door decal	1
21	A108-723-000	20511202A008	Side front decal - R	1
22	A108-724-000	20511202A009	Side rear decal - R	1

Back :

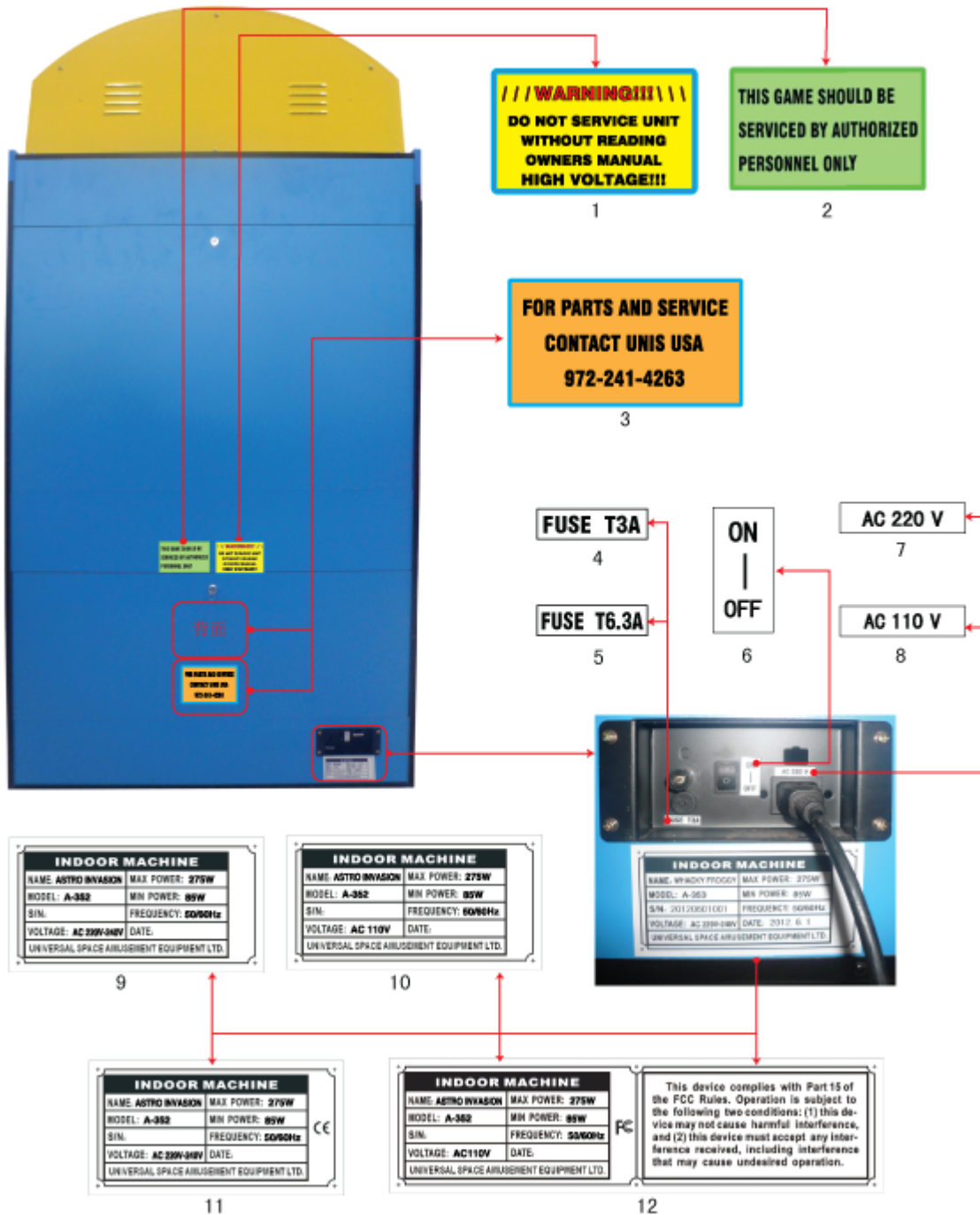

No.	Part No.	Code.	Name	Qty.
1	A108-725-000	25600000067	Service attention decal	1
2	A108-726-000	25600000042	Service information decal 1	1
3	A108-727-000	25600000095	New service decal(big)	2
4	A108-728-000	25600000010	Fuse T3A decal	1
5	A108-729-000	25600000013	Fuse T6.3A decal	1
6	A108-730-000	25600000016	Power SW decal A	1
7	A108-731-000	25600000041	Label 220V	1
8	A108-732-000	25600000040	Label 110V	1
9	A108-733-000	20511202017	220V nameplate	1
10	A108-734-000	20511202018	CE certified nameplate	1
11	A108-735-000	20511202020	110V nameplate	1
12	A108-736-000	20511202019	FCC certified nameplate	1

inside:

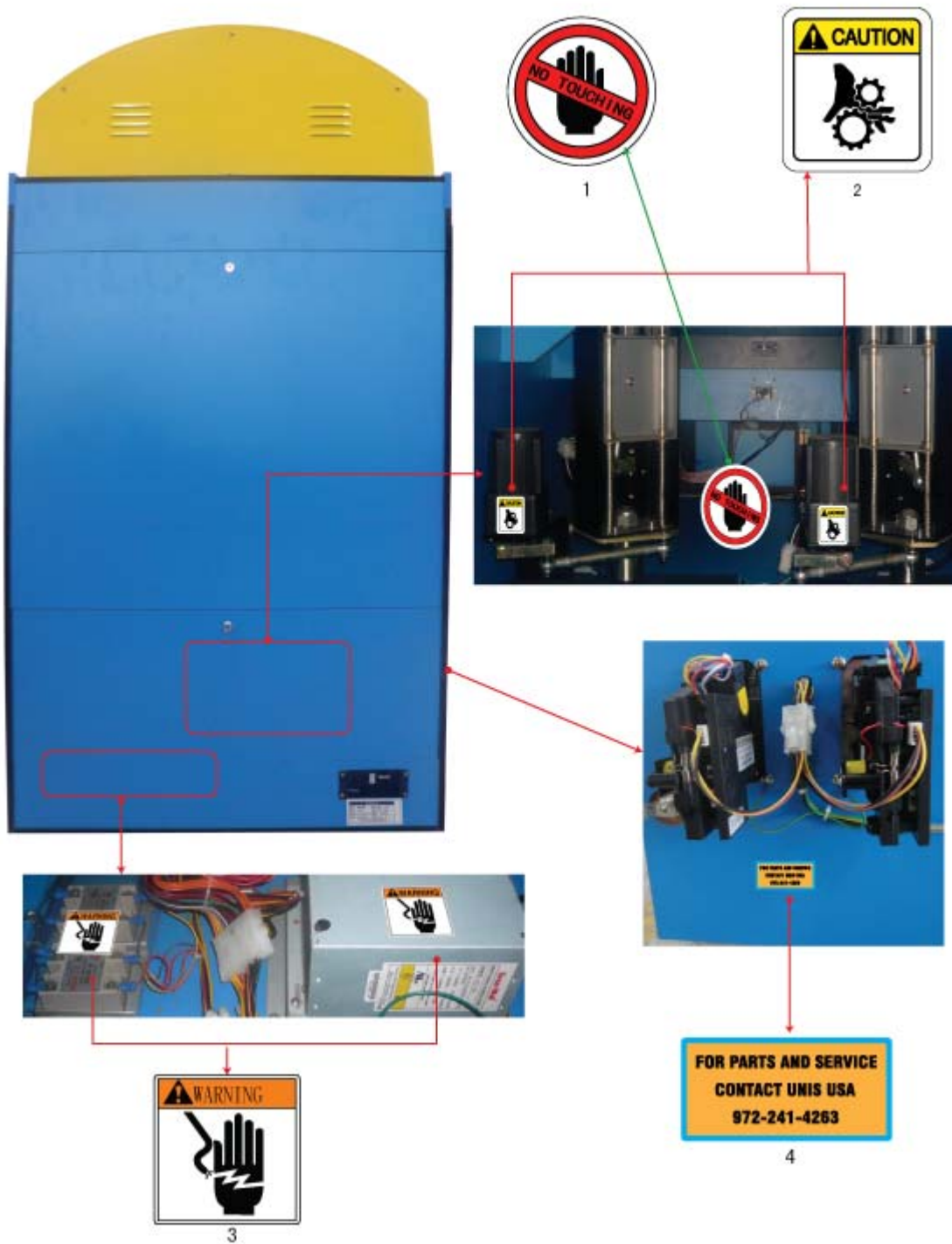

No.	Part No.	Code.	Name	Qty.
1	A108-737-000	25600000033	No touching decal	1
2	A108-738-000	25600000055	Attention label	2
3	A108-739-000	25600000036	High voltage decal (small)	2
4	A108-740-000	25600000096	New service decal(small)	1



# Wiring Diagram 1

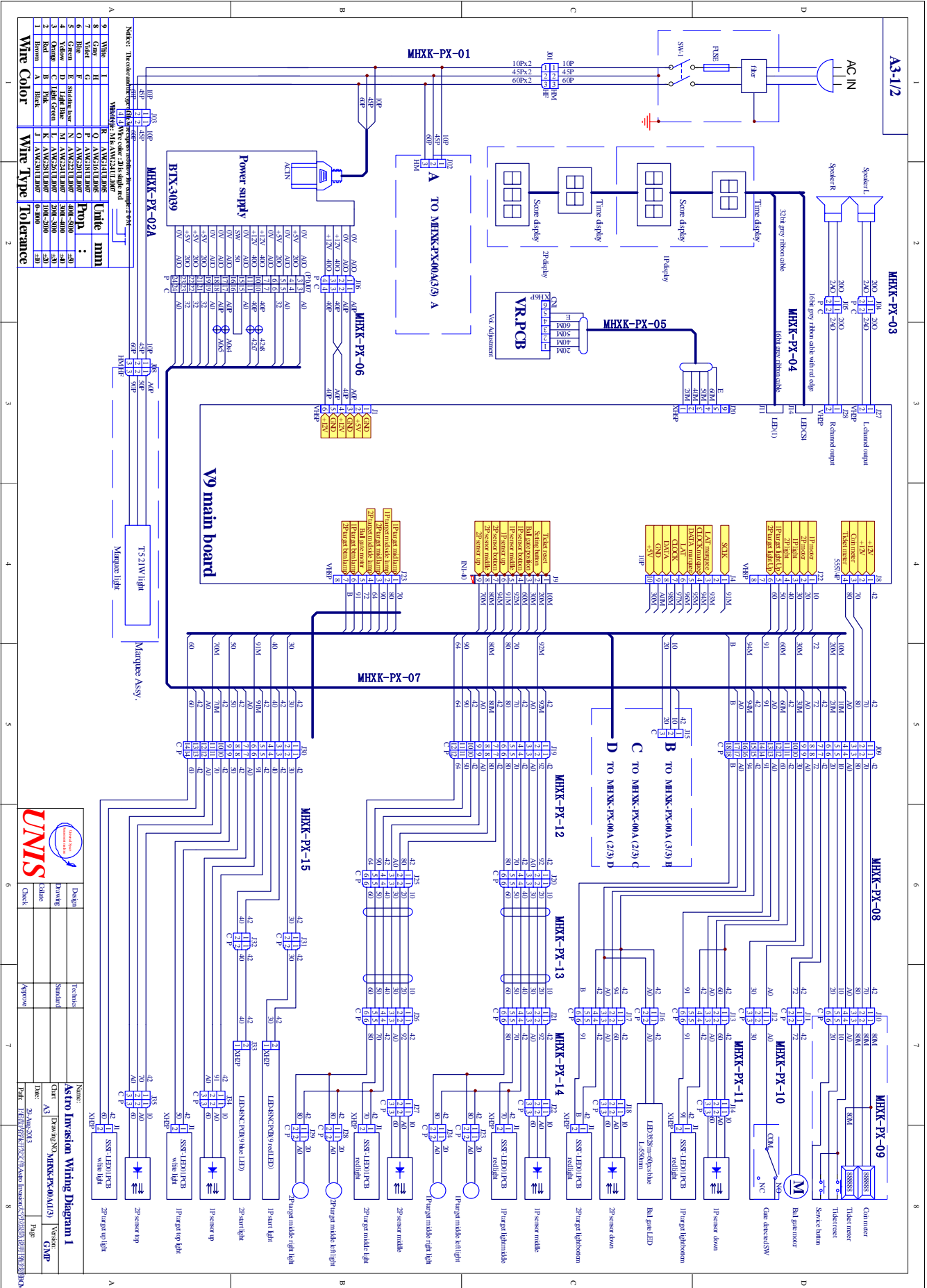







# Wiring Diagram 3

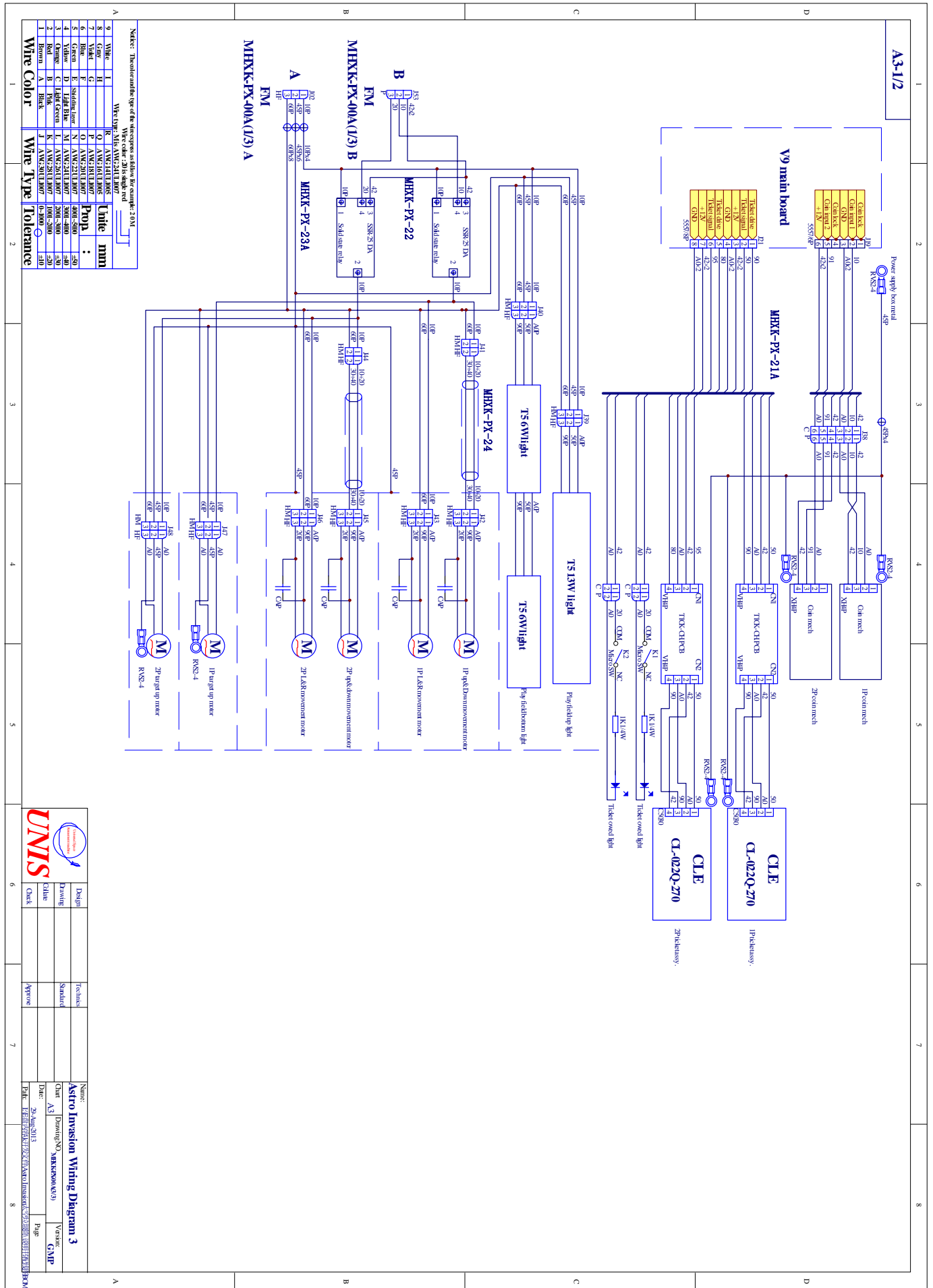

Note: The color and the type of the wire types is shown for example: 2.0M

Wire type: MIA, AVG-2411.007

Wire	Type	Color	Size	Length
1	AVG-2411.005	White	1.0	500
2	AVG-2411.005	White	1.0	500
3	AVG-2411.007	Green	1.0	500
4	AVG-2411.007	Yellow	1.0	500
5	AVG-2411.007	Light Blue	1.0	500
6	AVG-2411.007	Light Green	1.0	500
7	AVG-2411.007	Black	1.0	500
8	AVG-2411.005	White	1.0	500
9	AVG-2411.005	White	1.0	500

Wire Color      Wire Type      Tolerance

	Design	Technics	Name: Astro Invasion Wiring Diagram 3 Chart: A3 Date: 29 August 2013 File: E:\ELECTRONIC\ASTRO INVASION\WIRING DIAGRAM\WIRING DIAGRAM 3.DWG
	Drawn	Standard	
Checked		Approved	Page